

MOUNTAINEER SERIES

MEGA CLIMBER 55

MC 55RTG0

Assembly Manual



Recommended People: 2-3

Assembly Time: 4-5 hours



Swing Kingdom

www.swingkingdom.com

CONTENTS

Safety Info.	4
How to Open Packaging.	5
Parts List.	6
Part Drawings.	8
Hardware	12
Leg Assembly	13
Tower Assembly	16
Floor Assembly	20
Handrail Install.	21
Rock Wall Assembly	21
Cargo Net Assembly.	23
Extension Tower Assembly.	25
Swing Frame Assembly	29
Roof Assembly (1)	31
POLY SLAT ASSEMBLY	33
Roof Assembly (2)	35
Accessory Install.	37
Stake Install	39

TOOLS INCLUDED FOR ASSEMBLY

- #2 Square Drive Bit
- Slat Spacer

TOOLS REQUIRED FOR ASSEMBLY

- Impact Drill
- Socket Attachment
- 1/2" Socket
- 9/16" Socket
- Step Ladder
- Tape Measure
- Safety Glasses
- Level (Recommended)
- 9/16" Wrench
- Hammer
- Knife or Box Cutter

ABOUT US

For loads of fun and family time, count on Swing Kingdom. A family operated manufacturer of premier vinyl playsets, we strive to design and build fine quality, affordable playsets perfect for children of all ages.

From the 500 square foot building where we started our business in 2000, to our current 43,000 square foot facility, Swing Kingdom has expanded to meet the growing demand for high quality, virtually maintenance-free playsets. We were the first manufacturer to combine vinyl PVC and structural wood, along with stainless steel hardware for superior strength. Today, we continue to use only the finest quality materials to ensure safe, durable playsets built to offer years of enjoyment.

Our playsets are loaded with activities that will spark every child's imagination and encourage daily physical activity and never-ending fun!

SUPPORT

Support@SwingKingdom.com

717-656-4449

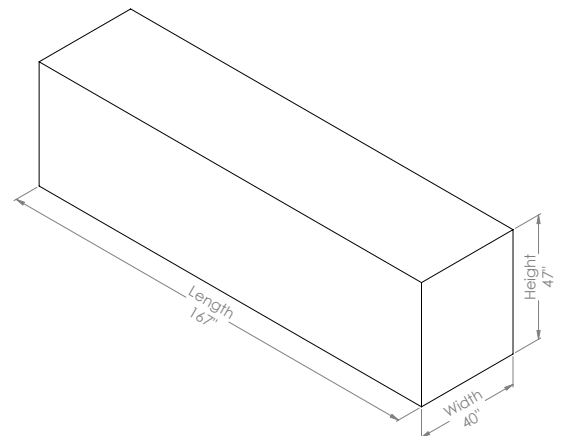

Skid Dimensions:

Package: 167" Length x 40" Width x 47" Height

Package Weight: 2,010 lbs

Version: 1.4

Last Updated: June 23, 2025

INTRODUCTION

Swing Kingdom's playsets are engineered from a safety first perspective. Our slip resistant vinyl-clad construction materials are always splinter free and no wood means no harsh chemical treatments. Stainless steel hardware brings added stability, while preventing rust and corrosion.

Our premium vinyl playsets are five times stronger than traditional wooden playsets. Each playset is manufactured with a high standard of durability and quality along with a 5-year warranty to stand behind our product.

We hope that the information on these pages will help you with assembling your Swing Kingdom playset. If you are unable to find the answers to your questions here when building, please contact your local authorized Swing Kingdom dealer, or call us direct at 717-656-4449.

WARRANTY

Subject to ordinary residential use and proper installation.

Swing Kingdom warrants to the original purchaser at the original installation address, that the structural components of the playset, such as the PVC vinyl and wood components are covered by a 5-year warranty. In addition, all canopies, slides, metal components, swings and accessories are warranted for 5 years from date of original purchase.

Swing Kingdom's products are not warranted as being suitable for a particular purpose. The suitability of the product is for the purchaser to determine. This warranty does not cover normal wear and tear, failure to properly maintain the product, or damage resulting from misuse or abuse of the product, additionally any acts of nature such as lightning, storms, hurricanes, tornadoes, earthquakes or any extreme weather conditions. Also any alteration, additions or relocation of the product will void this warranty.

Swing Kingdom reserves the right to examine photographs and/or physical evidence of the product claimed to be defective, and to recover product prior to any warranty claims. All products returned for inspection must be sent freight prepaid. In the event of a defect covered by these warranties, Swing Kingdom will remedy the defect within a reasonable time. The remedy will consist of repair or replacement of the defective piece unless it is not practical. Then Swing Kingdom will reimburse the original purchaser for the value of the defective piece.

All freight cost of replacement parts are not covered under warranty and will be the purchaser's responsibility to cover.

Adult supervision is recommended while enjoying your play system.



WARNING

- This instruction manual contains important information necessary for the proper assembly and safe use of the playset.
- Read and follow all warnings and instructions before assembling.
- Follow all warnings and instructions.
- Keep this manual for future reference.

SAFETY WARNING

Failure to follow these instructions could result in faulty equipment, which could cause property damage, personal injury or death! **Remember: Think Safety and Use Common Sense!**

Prevent Serious Injury or Death and Equipment Damage When Installing

- Work on dry sunny days to minimize the risk of slipping.
- Move items close to your body and use your legs when lifting an item from a low location.
- Avoid twisting, especially when bending forward while lifting. Turn by moving the feet rather than twisting the torso.
- Keep your elbows close to your body and keep the load as close to your body as possible.
- Limit weight you lift to no more than 50 pounds. When lifting product heavier than 50 pounds, use two or more people to lift the product up.
- Use personal protective equipment and clothing such as safety helmets, gloves, safety goggles, ear protection, and safety footwear.

Maintenance

It is of particular importance that these guidelines be followed at the beginning of each season as well as at regular intervals during the usage season:

- Check all nuts and bolts for tightness and tighten when required.
- Check all coverings for bolts and sharp edges and replace when required.
- Check swing seats, chains, ropes and other means of attachments for evidence of deterioration.
- Replace defective parts in accordance with the manufacturer's instructions.

General Safety Precautions

Users who use hand and power tools and who are exposed to the hazards of falling, flying, abrasive and splashing objects, or exposed to harmful dusts, fumes, mists, vapors, or gases must be provided with the particular personal equipment necessary to protect them from the hazard.

All hazards involved in the use of power tools can be prevented by following five basic safety rules:

- Keep all tools in good condition with regular maintenance.
- Use the right tool for the job.
- Examine each tool for damage before use.
- Operate according to the manufacturer's instructions.
- Provide and use the proper protective equipment.

Fasteners

When using power tools to apply fasteners, there are some precautions to consider:

- Fasteners must not be fired into material that would let them pass through to the other side.
- The fastener must not be driven into materials like brick or concrete any closer than 3 inches to an edge or corner.
- In steel, the fastener must not come any closer than one-half inch from a corner or edge.
- Fasteners must not be driven into very hard or brittle materials which might chip, splatter, or make the fastener ricochet.

Parts

	Qty	Label	Item
Legs	1	A1	83¼" 4x4 w/ Stair Slats
	2	A2	83¼" 4x4
	1	A3	83¼" 4x4 w/ Eye Bolts
	1	B1	72" 4x4 w/ Stair Slats
	1	B2	72" 4x4 w/ Eye Bolts
	7	C	22" 2x6 Steps
	1	D1	60" 2x6
	1	D2	60" 2x6 w/ Rope Holes
	1	E1	56" 2x4
	1	E2	56" 2x4 w/ Rope Holes
Lower Tower	2	F	78½" 2x6
	2	G	56" 2x6 w/ Joist Hangers
	6	H	55¾" 2x4 Joist
	1	I1	52" 4x4 Post w/ Upper Right Hole
	1	I2	52" 4x4 Post w/ Upper Left Hole
	1	J1	74" 4x4 Post w/ Top Right Hole
	1	J2	74" 4x4 Post w/ Top Left Hole & Handrail holes
	1	K1	56" 2x6 w/ Roof Thru-Hole
	1	K2	56" 2x6 w/ Roof & Swing Beam Holes
	1	K3	56" 2x6 w/ End Caps
	2	K4	56" 2x6
	1	K5	56" 2x6 w/ Roof Partial-Hole
	1	L1	55¾" 2x4 Railing w/ Sequence Plaque
	1	L2	55¾" 2x4 Railing
	2	M1	3⅜" x 59½" Floorboard
	16	M2	5½" x 59½" Floorboard
	2	M3	5½" x 48" Floorboard
	2	M4	5½" x 53¾" Floorboard
	1	N1	28½" Poly w/ End Groove & Center Hole
	9	N2	28½" Poly w/ End Groove
	1	N3	28½" Poly w/ Angle Cut
	1	N4	22" Poly
Upper Tower	1	O1	127" 4x4 Post w/ Top Right Hole
	1	O2	127" 4x4 Post w/ Top Left Hole
	1	P1	64" 2x6 w/ Corner Bracket, End Cap, & Brace Holes
	1	P2	64" 2x6 w/ Corner Bracket, End Cap, & Brace Holes
	2	P3	64" 2x6 w/ Corner Bracket & End Cap
	2	Q	28" 2x4 Brace
	2	R	19" 2x4 Brace
	25	S1	¾" x 2⅝" x 33⅜" Poly Slat
	4	S2	¾" x 2⅝" x 24" Poly Slat
	1	S3	Poly Slat Assembly
	1	T1	5x5 Poly Slat Template
	1	T2	Extension Poly Slat Template

Parts

	Qty	Label	Item
Swing Frame	1	U	168" Swing Beam
	1	V	92" Swing 4x4
	1	W	106" 2x4 Swing Ground Board
	2	X	89" 2x4 Swing Brace
	1	Y	Poly Brace
	2	Z	Swing Beam Post Plate
Roof	1	AA	Swing Beam Bracket
	2	AB1	120" Roof 2x4 Railing
	1	AB2	120" Roof 2x4 Railing w/ Center Partial Hole
	1	AC	61 ⁵ / ₈ " 2x4 Railing
	1	AD	35 ³ / ₄ " 2x4 Railing
	1	AE	24" 2x4 Brace
	2	AF	62" Roof 2x4 Vertical
	1	AG	70 ³ / ₄ " Roof 2x4 Vertical
	1	AH	68 ³ / ₈ " Roof 2x4 Vertical
	1	AI	59 ⁵ / ₈ " Roof 2x4 Vertical
	2	AJ	59 ¹ / ₂ " Roof Horizontal 2x4 (top piece)
	2	AK	(1) Canvas Roof with (2) 62 ¹ / ₂ " 2x4s
Accessory	4	AL	Roof Flags
	2	AM	26 ¹ / ₄ " 2x6 w/ poly attached
	1		Climber Handrail
	1		10' Avalanch Slide
	1		14' Avalanch Slide
	2		⁵ / ₈ " Diameter Rope
	1		1" Diameter Rope
	2		Belt Swing
	1		Trapeze
	1		Web Swing
	1		Tire Swing
	1		Hammock Swing
	1		Tic-Tac-Toe Board
	1		Bubble Pannel
	10		Rocks

Hardware Packs

Qty	Item
Tower Bundle	
94	⁹ / ₁₆ " x 4" Lag
4	⁹ / ₁₆ " x 3" Lag
98	³ / ₈ " Washer
Floor Bundle	
202	2" Polybuster Screw
Poly Slat Bundle	
89	1 ³ / ₄ " Washer Head Screw
Swing Frame Bundle	
6	⁹ / ₁₆ " x 5" Bolt
2	⁹ / ₁₆ " x 2.75" Bolt
8	⁹ / ₁₆ " Locking Nut
3	⁹ / ₁₆ " x 4" Lag
2	⁹ / ₁₆ " x 3" Lag
21	³ / ₈ " Washer
Swing Hook Bundle	
8	Swing Hook
1	Tire Swivel
18	⁹ / ₁₆ " x 3" Lag
18	³ / ₈ " Washer
Roof Bundle	
22	⁹ / ₁₆ " x 4" Lag
8	⁹ / ₁₆ " x 3" Lag
30	³ / ₈ " Washer
Climber Handrail Bundle	
4	¹ / ₂ " x 1 ¹ / ₂ " Lag
4	⁵ / ₁₆ " Washer
Accessories Bundle	
41	2" Polybuster Screw
10	1 ³ / ₄ " Washer Head Screw
26	¹ / ₄ " x 1 ¹ / ₄ " Pan Head Screw
26	⁵ / ₁₆ " Washer
Stake Bundle	
2	Stake
2	¹ / ₂ " x 1 ¹ / ₂ " Lag
2	³ / ₈ " Washer

Leg Parts

A1: 83 1/4" 4x4 with Stair Slats (x1)

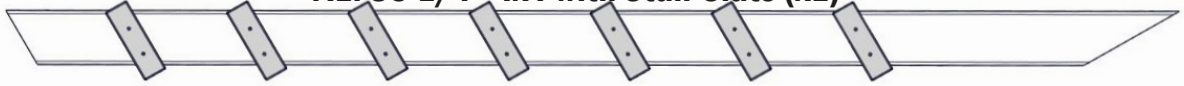

A2: 83 1/4" 4x4 (x2)



A3: 83 1/4" 4x4 with Eye Bolts (x1)



B1: 72" 4x4 with Stair Slats (x1)

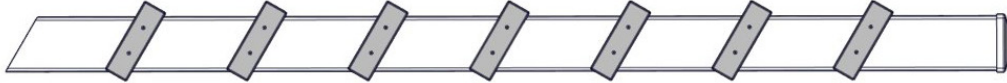

B2: 72" 4x4 with Eye Bolts (x1)



C: 22" 2x6 Step (x7)



D1 - 60" 2x6 (x1)



D2 - 60" 2x6 with Rope Holes (x1)



E1 - 56" 2x4 (x1)



E2 - 56" 2x4 with Rope Holes (x1)

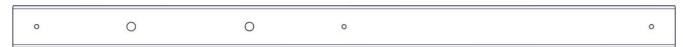

F: 78 1/2" 2x6 (x2)



Tower Parts

G - 56" 2x6 with Joist Hangers (x2)



H - 55 3/4" 2x4 Joist (x6)



I1 & I2 - 52" 4x4 Post (x2)



J1 & J2 - 74" 4x4 Post (x1)



K1 & K5 - 56" 2x6 Railing with Roof Hole(x2)



K3 - 56" 2x6 with End Caps (x1)



K2 - 56" 2x6 Railing w/ Roof & Swing Holes (x1)



K4 - 56" 2x6 (x2)



Tower Parts

01 & 02 - 127" 4x4 Post (x2)



L1 - 55 3/4" 2x4 with Sequence Plaque (x1)



L2 - 55 3/4" 2x4 (x1)



R - 19" 2x4 Brace (x2)



Q - 28" 2x4 Brace (x2)



P1 & P2 - 64" 2x6 with Corner Bracket, End Cap, & Brace Holes (x2)

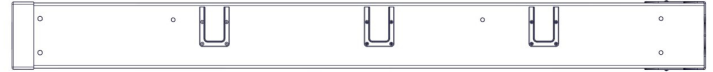

P3 - 64" 2x6 with Corner Bracket & End Cap (x2)



Tower Poly Items

M1 - 3 3/8" x 59 1/2" Floorboard (x2)



M2 - 5 1/2" x 59 1/2" Floorboard (x16)



M3 - 5 1/2" x 48" Floorboard (x2)



M3 - 5 1/2" x 53 3/4" Floorboard (x2)



S1 - 2 5/8" x 33 3/8" Poly Slat (x20)

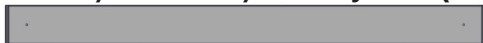

S2 - 3/4" x 2 5/8" x 24" Poly Slat (x4)



T1 - 5x5 Poly Slat Template (x1)



T2 - Extension Slat Template (x1)

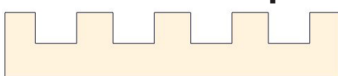

N1: 28 1/2" Poly with Groove & Center Hole (x1)



N2: 28 1/2" Poly with Groove (x9)

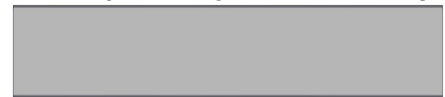

N3: 28 1/2" Poly with Angle Cut (x1)



N2: 22" Poly (x1)



S3: Poly Slat Assembly (x1)

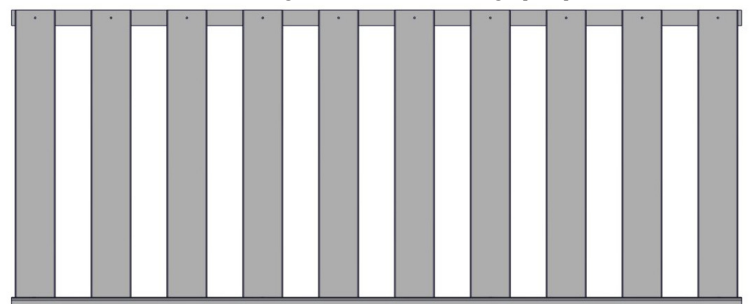

AM -26 1/4" 2x6 w/ poly attached (x2)



Swing Frame Parts

U - 168" 2x6 Swing Beam (x1)



W - 106" 2x4 Ground Board (x1)



V - 92" 4x4 Post (x1)



X - 89" 2x4 Brace (x2)



Y - Poly Brace (x1)



Z - Post Plate (x2)



AA - Bracket (x1)



Roof Parts

AB1 (2) & AB2 (1) - 120" 2x4 Roof Railing (x3)



AF, AG, AH, & AI - Roof Vertical 2x4 (x4)



AE - Roof Brace 2x4 (x1)



AC - 61 5/8" 2x4 (x1)



AD - 35 3/4" 2x4 (x1)



AJ - 50 1/2" 2x4 (x2)



AL - Flag (x6)

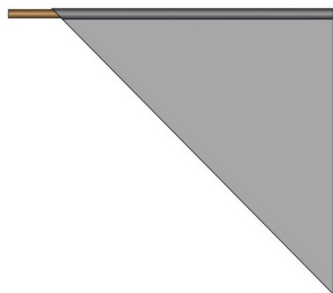

AK - (1) Canvas with (2) 62 1/2" 2x4 (x2)



Accessories

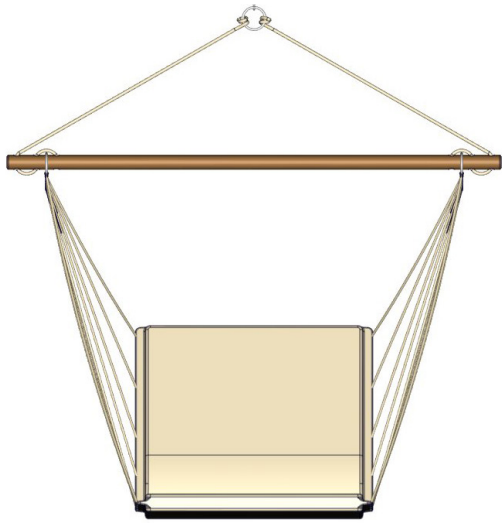

Hammock Swing (x1)

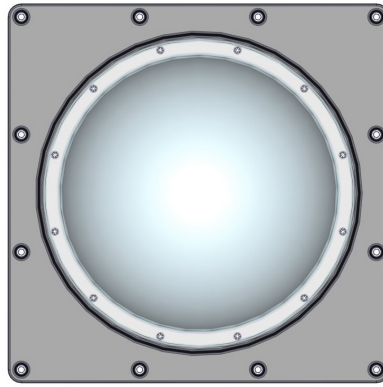

Bubble Panel (x1)

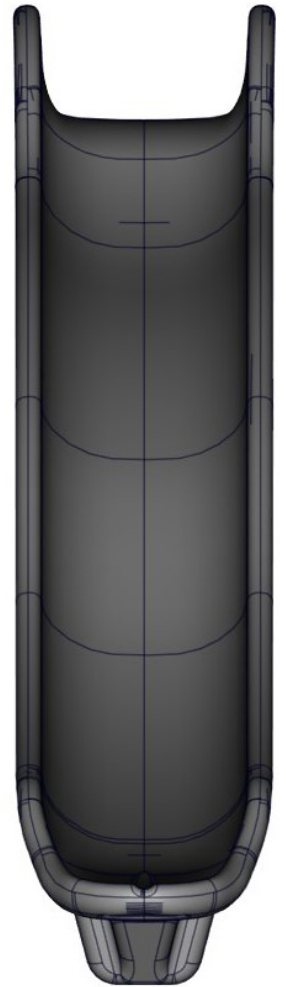

14' Waterfall Slide (x1)

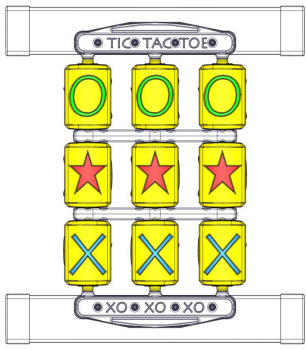

Tic-Tac-Toe Panel (x1)



Tire Swing (x1)

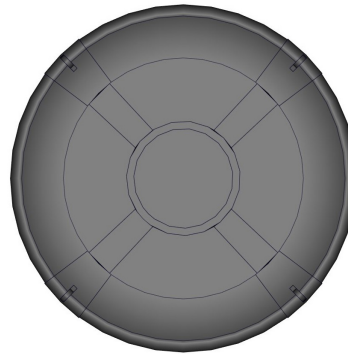

Web Swing (x1)

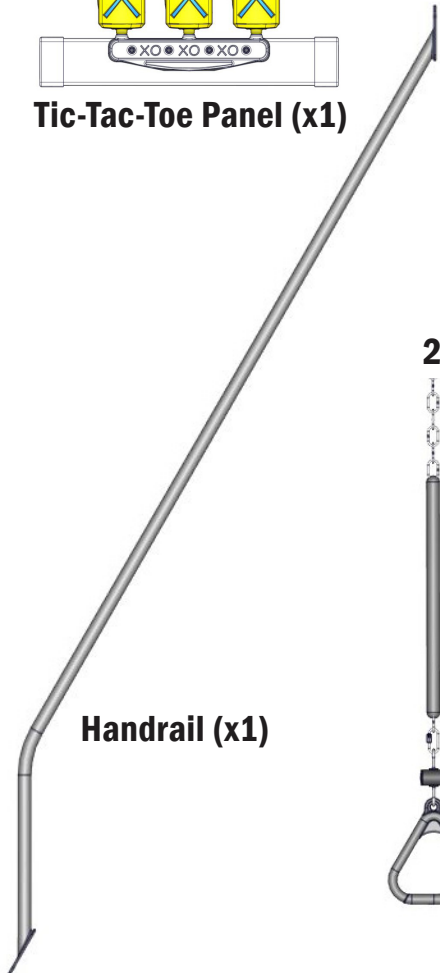

Handrail (x1)

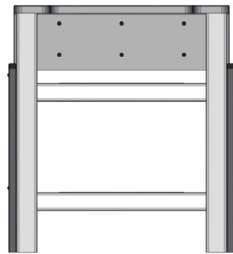

2' Access Ladder (x1)



Trapeze (x1)



Belt Swing (x2)

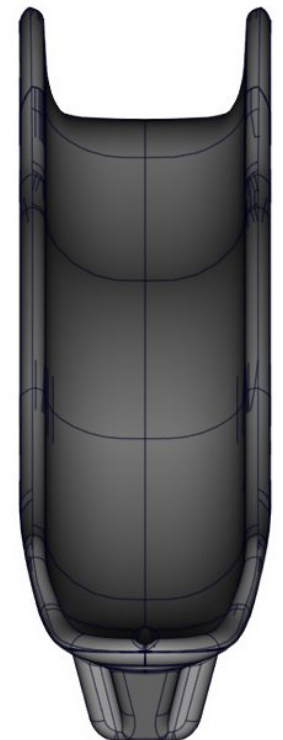

10' Waterfall Slide (x1)

HARDWARE

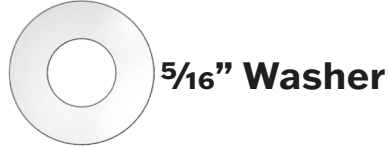
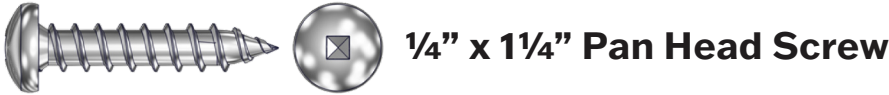
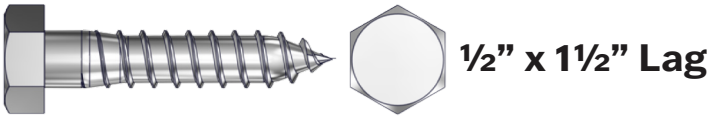
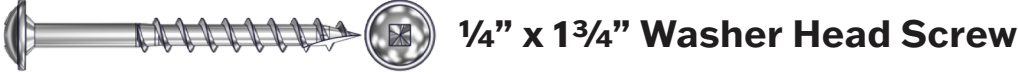
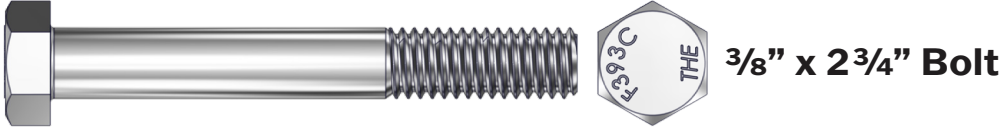
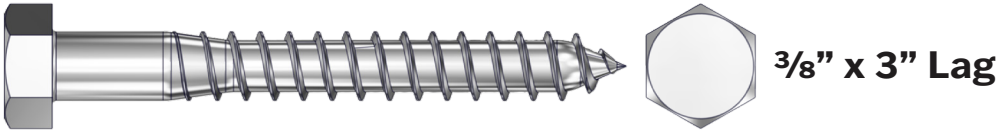
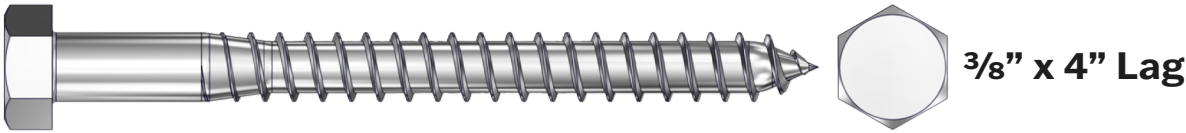

#2 Square Drive Bit



LEG ASSEMBLY

STEP
01

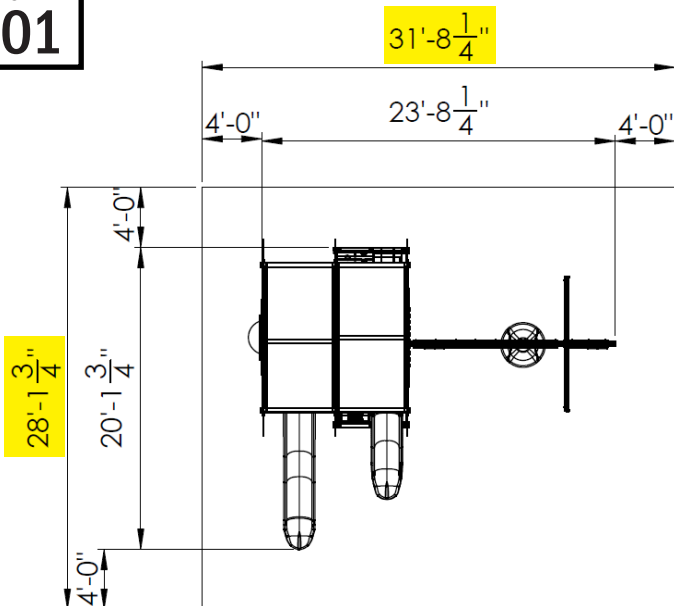

- **Review the dimensions above** (4ft is our recommended space around the playset. CPSC recommends 6ft. You may need to review your local laws or guidelines for more assistance.)
- **Find a level surface.** (You may need to dig out high areas or use treated lumber to block up low areas to make your surface level.)
- **Determine where you want the front & back of the playset.**
- **Lay out each bundle.** (Don't unwrap the bundles until you reach the appropriate step. Only cut in the creases to avoid damaging items.)

STEP
02

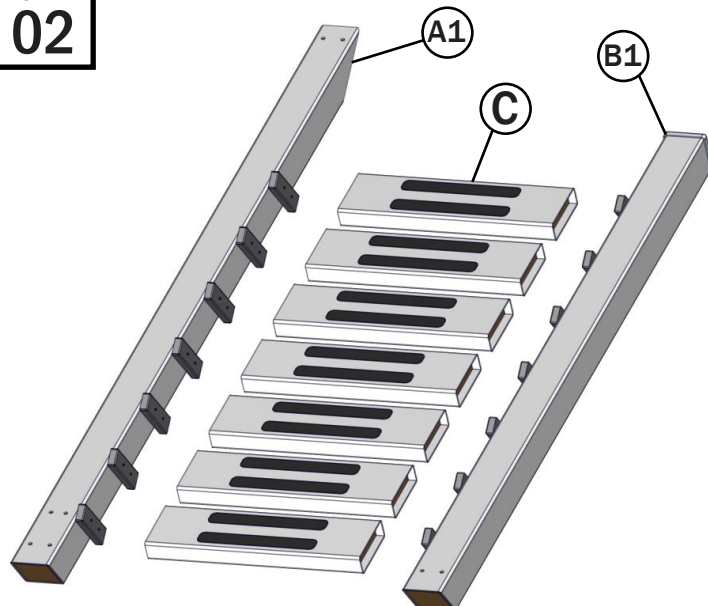

Locate and prepare the "Leg 1" & "Step" Bundles which includes...

- A1: (1) 83 1/4" 4x4 with Stair Slats
- B1: (1) 72" 4x4 with Stair Slats
- C: (7) 22" 2x6 Step

Also locate the "Tower" & "Accessory" (for the steps) Hardware bags.

STEP
03

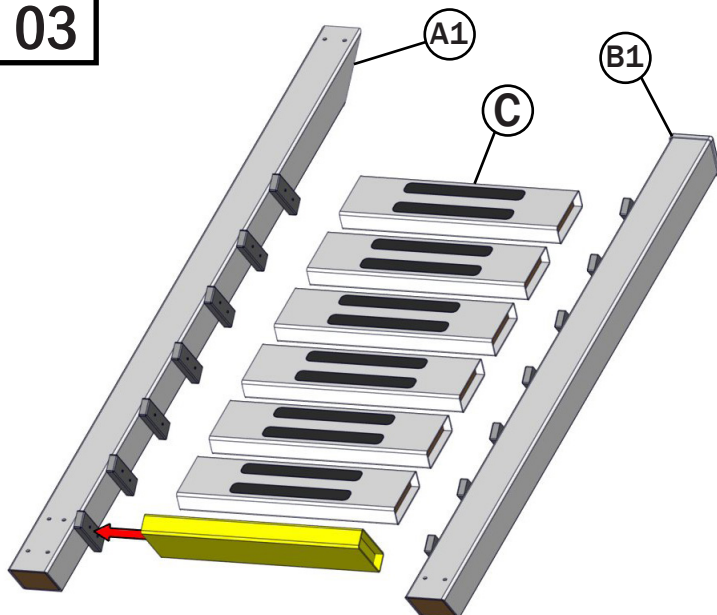

- Arrange "A1" & "B1" so the slats are facing each other. "B1" will be on the right with an end cap on the top end & "A1" will be on the left with the sharper angle on the top end. Place "C" between the two.
- "C" will slide onto the stair slat of "B1". Make sure the side with the black grips are facing the top end.

STEP
04

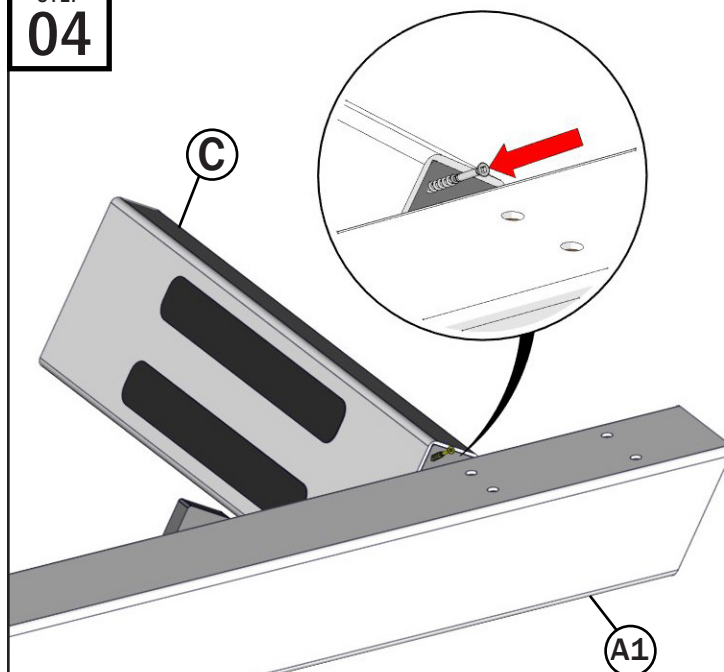

- Push "C" against "A1"
- Using (1) 2" Polybuster Screw, tilt the screw at a 45 degree angle and drill it into the corner of the stair slat. This will fasten the "C" to "A1".
- Repeat on the rest of the steps.

LEG ASSEMBLY

STEP
05

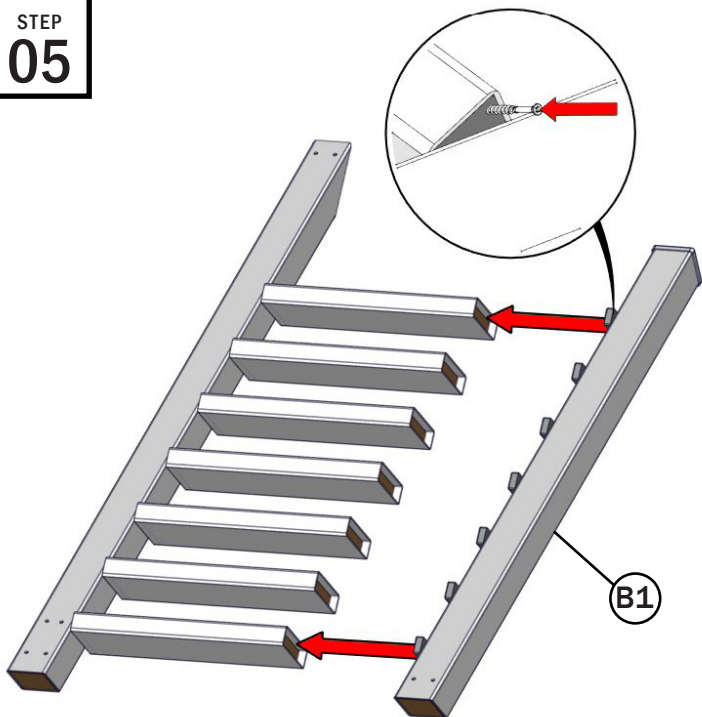

- You may want to tilt the step assembly on end, but it is not necessary.
- Place the stair slats from "B1" onto the other end of the steps. This will take some adjusting to get all steps on the slat.
- Using (7) 2" Polybuster Screw, tilt the screw at a 45 degree angle and drill it into the corner of the stair slat.

STEP
06

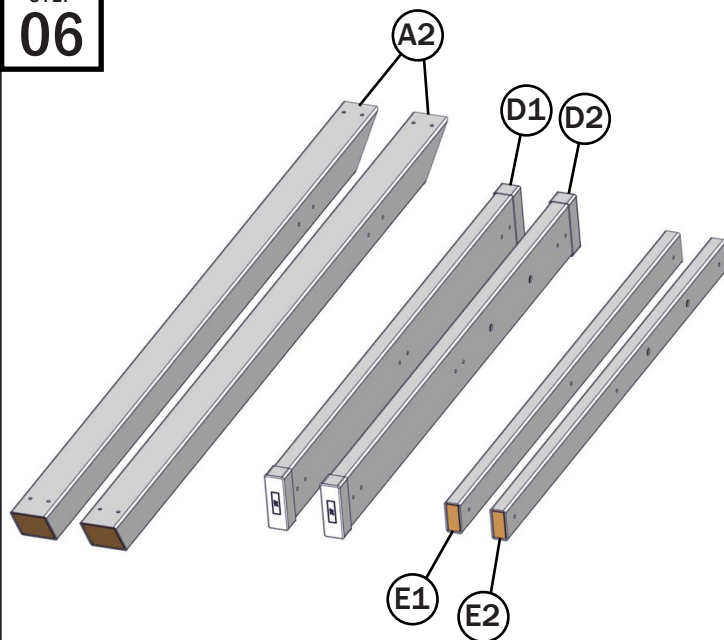

Locate and prepare the "Leg 2", "Base 1", & "Base 2" Bundles which include...

- A2: (2) 83 1/4" 4x4
- D1: (1) 60" 2x6
- D2: (1) 60" 2x6 with Rope Holes
- D3: (1) 56" 2x4
- D4: (1) 56" 2x4 with Rope Holes

STEP
07

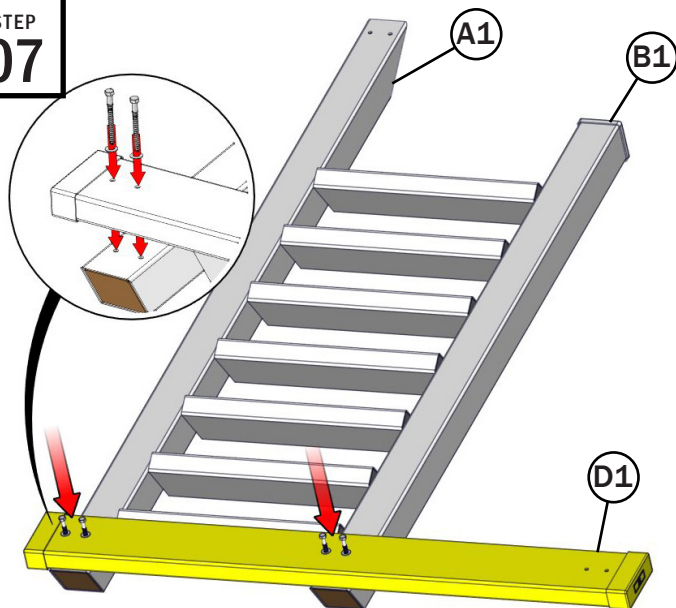

Note: DO NOT OVER-TIGHTEN. Fasten them enough so the parts touch. If the vinyl starts to dent or dimple, you know it is tight enough.

- Place "D1" on top of the stair assembly with the left and center holes of "D1" aligning with the bottom holes of "A1" & "B1".
- Using (4) 9/16" x 4" Lags & 3/8" Washers, drill into the holes of "D1" so that the tip of the lags are showing on the other side.
- Use the tip of the lags to find the holes on "A1" & "B1".
- Fasten the Lags into the "A1" & "B1".

STEP
08

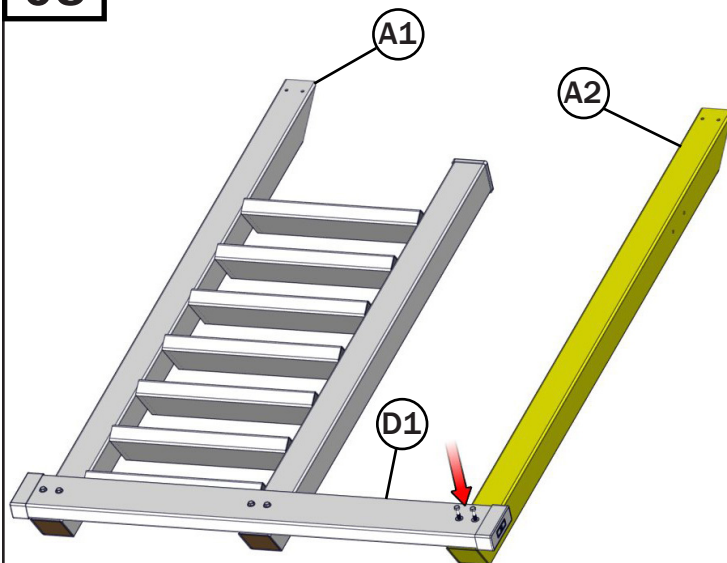

Note: DO NOT OVER-TIGHTEN. Fasten them enough so the parts touch. If the vinyl starts to dent or dimple, you know it is tight enough.

- Place "A2" underneath the open end of "D1" with the sharper angled end at the top matching "A1". Line up the holes on "A2" & "D1".
- Using (2) 9/16" x 4" Lags & 3/8" Washers, drill into the holes of "D1" so that the tip of the lags are showing on the other side.
- Use the tip of the lags to find the holes on "A2".
- Finish fastening the items together.

LEG ASSEMBLY

STEP
09

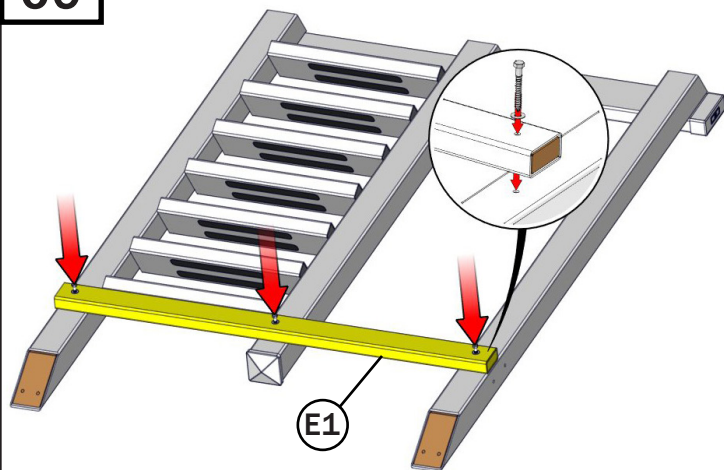

- Carefully flip the entire assembly over.
- Place "E1" by the top of the stair assembly lining up the holes on "E1" with each holes on the 4x4 legs.
- Using (2) 9/16" x 4" Lags & 3/8" Washers, drill into the holes of "E1" so that the tip of the lags are showing on the other side.
- Use the tip of the lags to find the holes on the 4x4 legs.
- Finish fastening the items together.

STEP
10

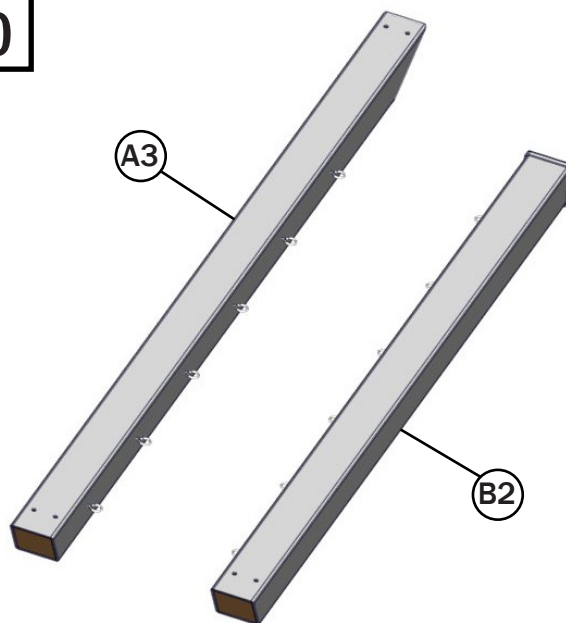

Locate and prepare the "Leg Bundle 3" which include...

- A3: (1) 83 1/4" 4x4 with Eye Bolts
- B2: (1) 72" 4x4 with Eye Bolts

Just like the stairs, place "A3" & "B2" with the eye bolts facing each other. You will need the items opened previously ("A2", "D2", & "E2")

STEP
11

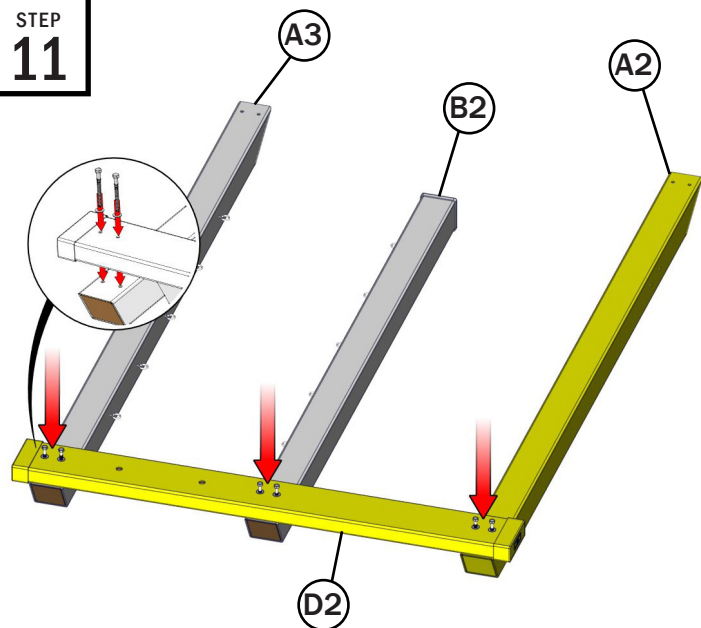

Note: DO NOT OVER-TIGHTEN. Fasten them enough so the parts touch. If the vinyl starts to dent or dimple, you know it is tight enough.

- Just like the stair assembly, you will place "D2" on top of "A3" & "B2", then put "A2" on the right side of "D2". Make sure the rope holes on "D2" are between the eye bolts.
- Using (6) 9/16" x 4" Lags & 3/8" Washers, drill into "D1" and use the lag tips as a guide to line up the bottom holes on "A3", "B2", & "A2".
- Fasten everything together.

STEP
12

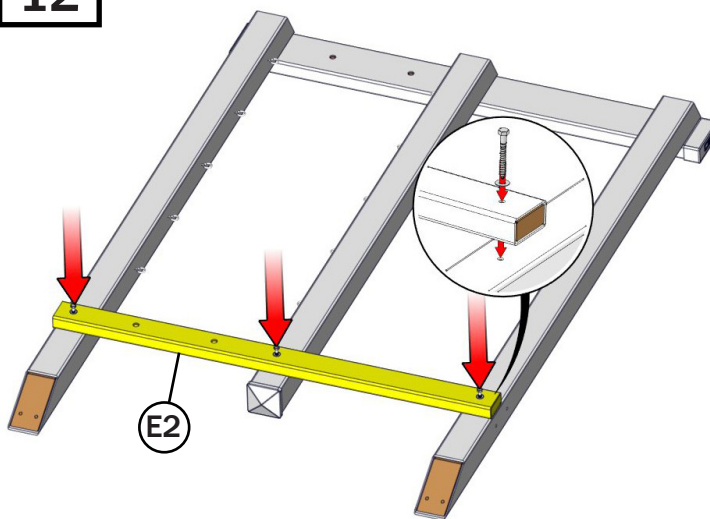

Note: DO NOT OVER-TIGHTEN. Fasten them enough so the parts touch. If the vinyl starts to dent or dimple, you know it is tight enough.

- Flip the assembly over and place "E2" on the back side towards the top of the assembly. Make sure the rope holes are between the eye bolts.
- Using (3) 9/16" x 4" Lags & 3/8" Washers, drill into "D1" and use the lag tips as a guide to line up the bottom holes on "A3", "B2", & "A2".
- Fasten everything together.

TOWER ASSEMBLY

STEP
13

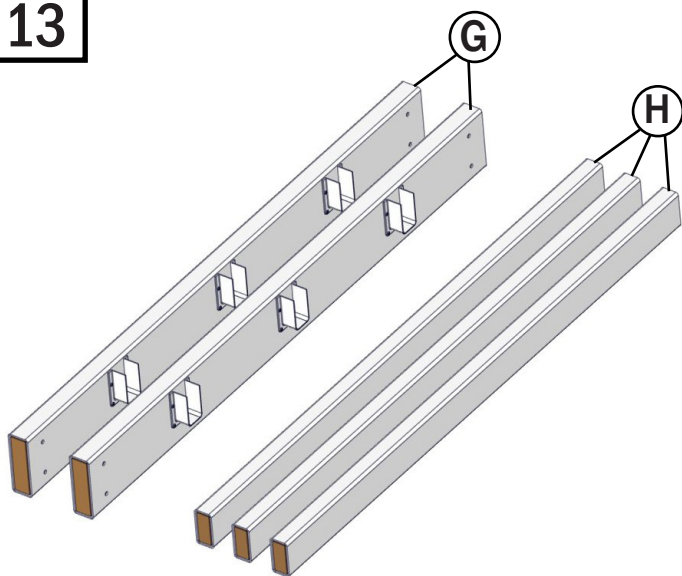

Locate and prepare the "Floor Bundle 2" which include...

- G: (2) 56" 2x6 w/ Joist Hangers
- H: (3) 55 3/4" 2x4 Joist

STEP
14

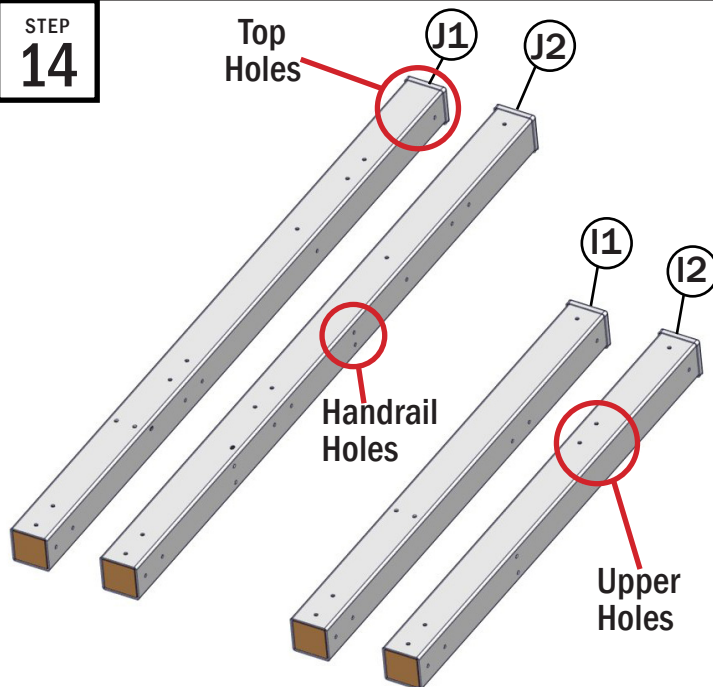

Locate and prepare the "Post Bundles 1 & 2" which include...

- I1: (2) 52" 4x4 Post with Upper Right Holes
- I2: (1) 52" 4x4 Post with Upper Left Holes
- J1: (1) 74" 4x4 Post with Top Right Hole
- J2: (1) 74" 4x4 Post with Top Left Hole & Handrail holes

STEP
15

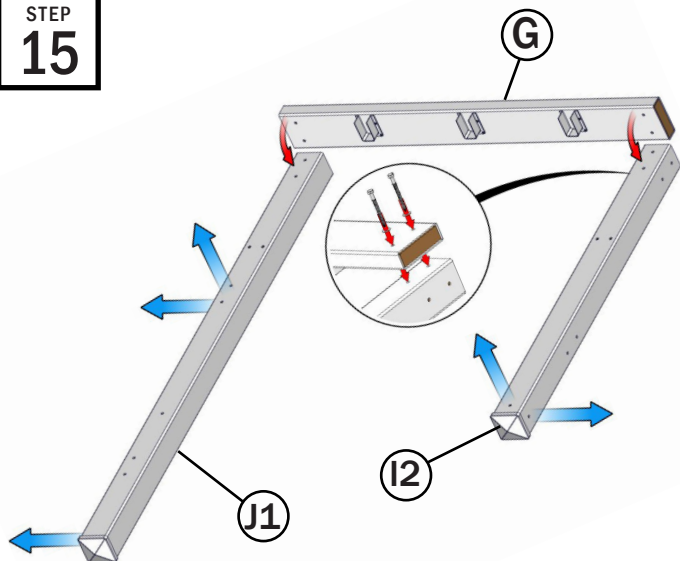

Note: DO NOT OVER-TIGHTEN. Fasten them enough so the parts touch. If the vinyl starts to dent or dimple, you know it is tight enough.

- Place "I2" & "J1" next to each other with the top most holes facing up & away from the other post. The Upper Holes will be facing away from the other post as well.
- Place "G" at the bottom of the posts with the joist hangers on the same side as the posts facing towards the top of the posts.
- Use (4) 9/16" x 4" Lags & 3/8" Washers to fasten "G" to the posts.

STEP
16

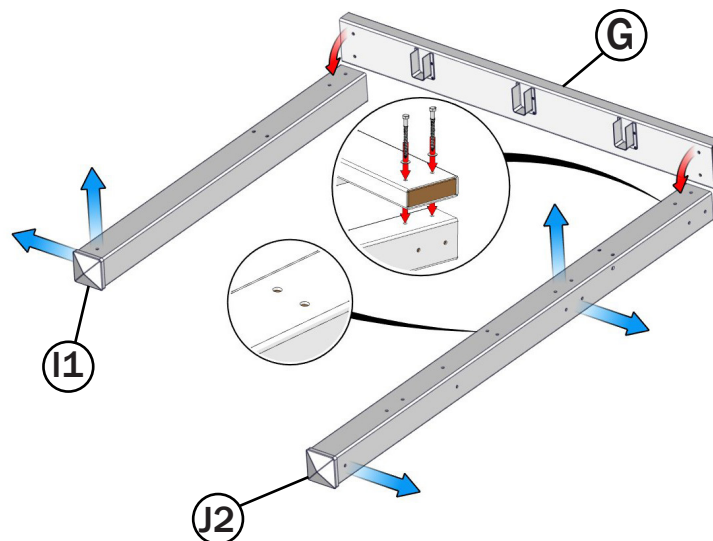

- Repeat the same process with "I1" & "J2". "J2" will have extra holes for the handrail. Make sure "J2" is on the correct side shown.
- Repeat placing "G" on top with the joist hangers facing the correct directions
- Use (4) 9/16" x 4" Lags & 3/8" Washers to fasten "G" to the posts.

TOWER ASSEMBLY

STEP
17

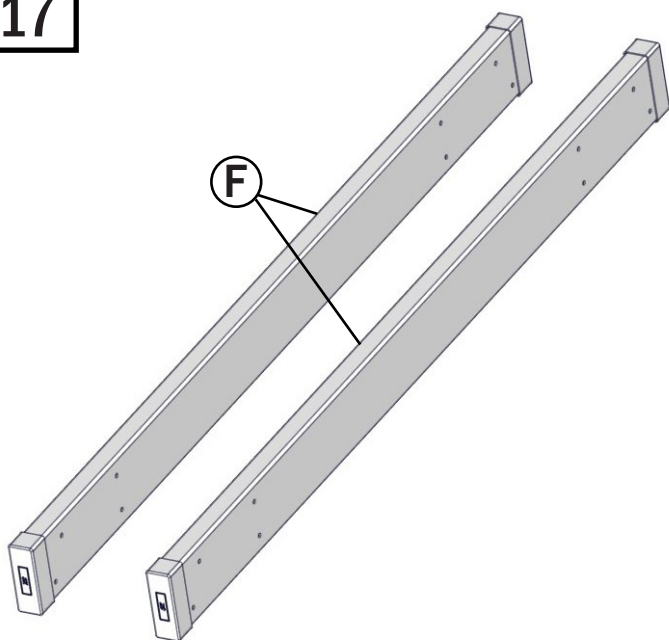

Locate and prepare the "Floor Bundle 1" which include...

- F: (2) 84" 4x4

STEP
18

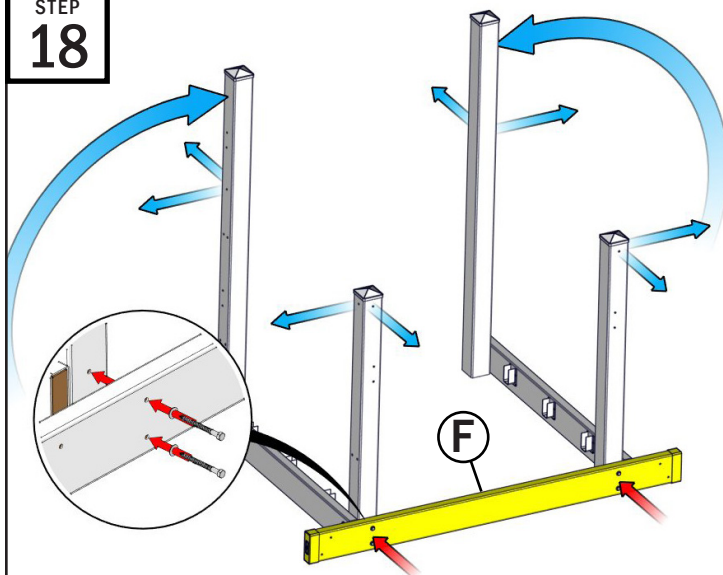

Note: DO NOT OVER-TIGHTEN. Fasten them enough so the parts touch. If the vinyl starts to dent or dimple, you know it is tight enough.

- Place "F" by the sides of the two post assemblies. Note the holes on the end. The lower hole will be more outward than the upper hole.
- Flip one of the post assemblies upright. Make sure the top holes are facing outward and the joist hangers are facing inwards.
- Using (2) 9/16" x 4" Lags & 3/8" Washers, drill into the holes of "F" so that the tip of the lags are showing on the other side.
- Use the tip of the lags to find the holes on the post. Finish fastening.
- Flip and repeat on the other post assembly.

STEP
19

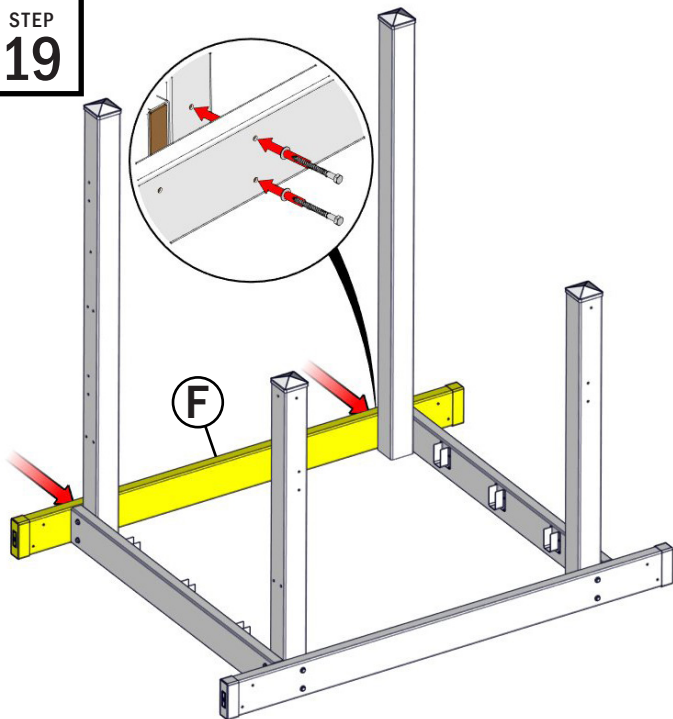

- Place the other "F" on the other side. Again, note the holes on the ends of "F". They lower hole will be positioned outwards in comparison to the upper hole.
- Repeat the same fastening process from the last step.

STEP
20

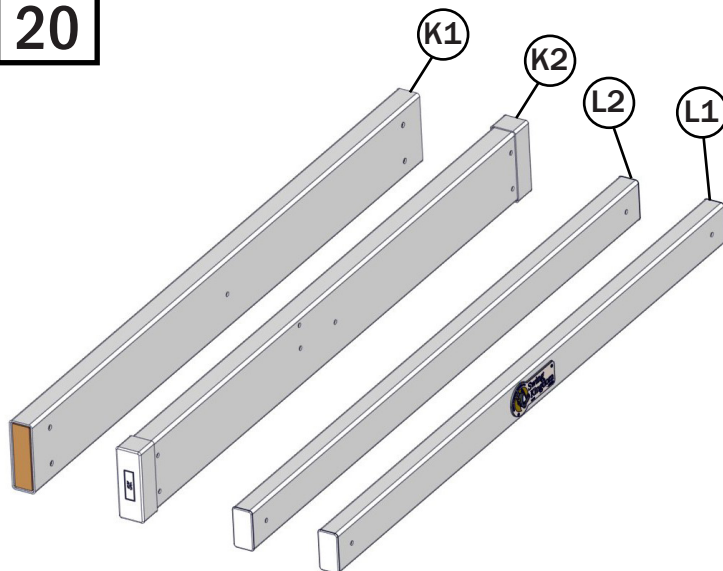

Locate the "Railing Bundle" which includes...

- K1: (1) 56" 2x6 Railing with Roof Holes
- K2: (1) 56" 2x6 Railing with Roof & Swing Beam Holes
- L1: (1) 55 3/4" 2x4 Railing with Sequence Plaque
- L2: (1) 55 3/4" 2x4 Railing

TOWER ASSEMBLY

STEP
21

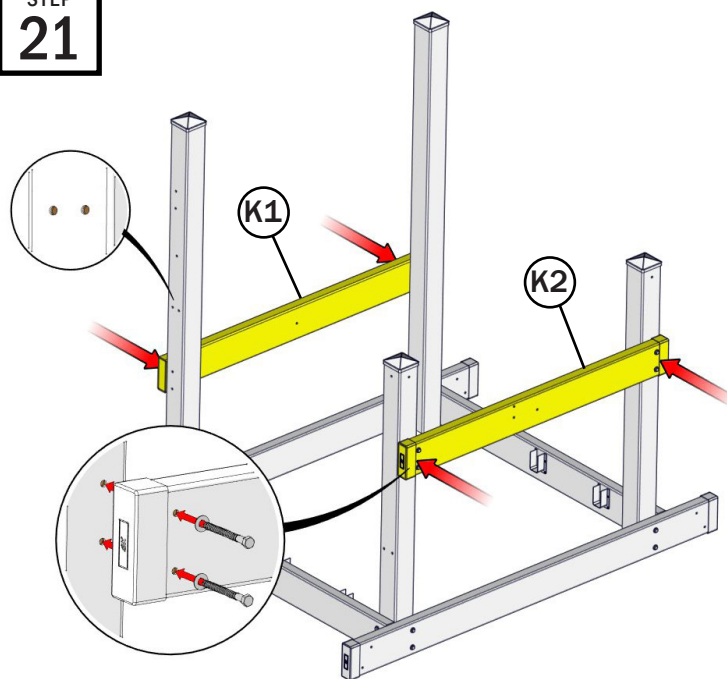

- Place "K1" & "K2" on the sides of the tower. "K2" will be on the same side as the swings (image shows on right side)
- Using (4) 9/16" x 4" Lags & 3/8" Washers, drill into the large holes of the 2x6 so that the tip of the lags are showing on the other side.
- Use the tip of the lags to find the holes on the 4x4 post.
- Fasten the Lags the into the 4x4 post.

STEP
22

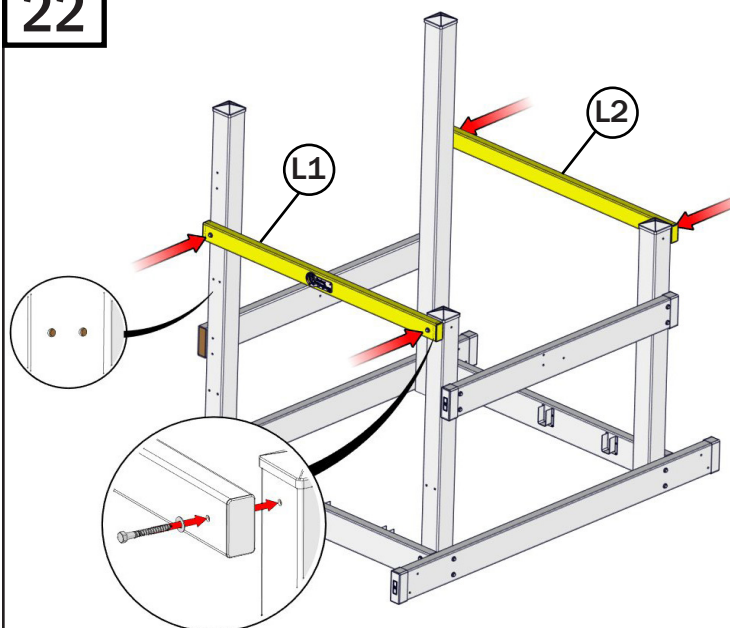

- Place "L1" on the front & "L2" on the back of the tower.
- Using (4) 9/16" x 4" Lags & 3/8" Washers, drill into the large holes of the 2x6 so that the tip of the lags are showing on the other side.
- Use the tip of the lags to find the holes on the 4x4 post.
- Fasten the Lags the into the 4x4 post.

STEP
23

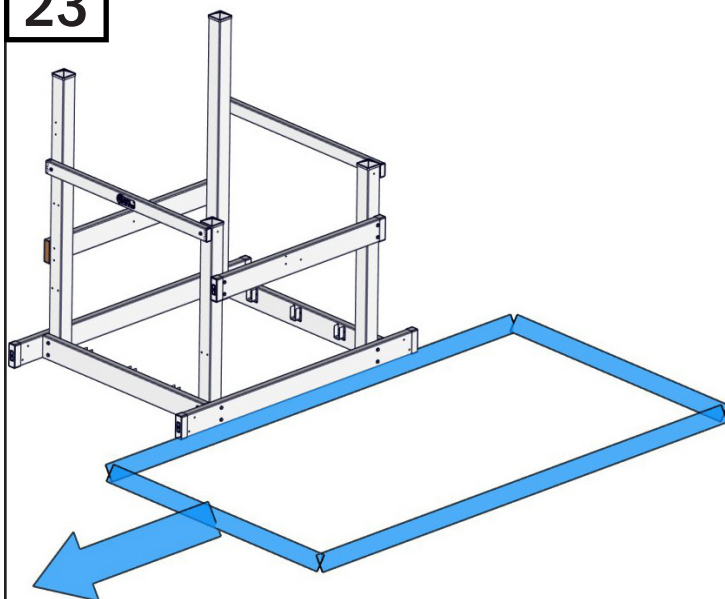

- Locate where you want the main tower to go. See the blue square.
- Place the tower assembly next to where you want the tower to stand when.
- Make sure the sequence plaque and the handrail holes on the 4x4 post are facing the direction you want to be the front of the tower.

STEP
24

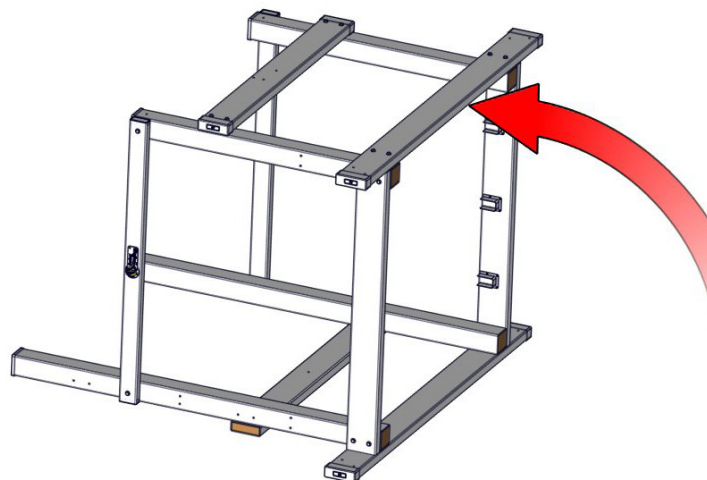

- Flip the tower on it's side away from where you want the tower to end up.

TOWER ASSEMBLY

STEP
25

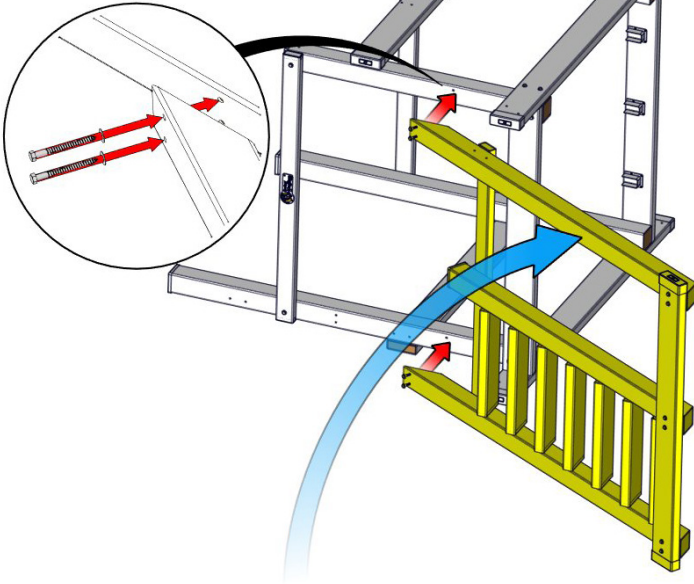

- Flip the leg on it's side & push it towards the tower. It may take some effort into getting the leg between both "F" pieces.
- Using (8) 9/16" x 4" Lags & 3/8" Washers, drill into the holes at the angled side of the leg so that the tip of the lags are showing on the other side.
- Use the tip of the lags to find the holes on the 4x4 & finish fastening.

STEP
26

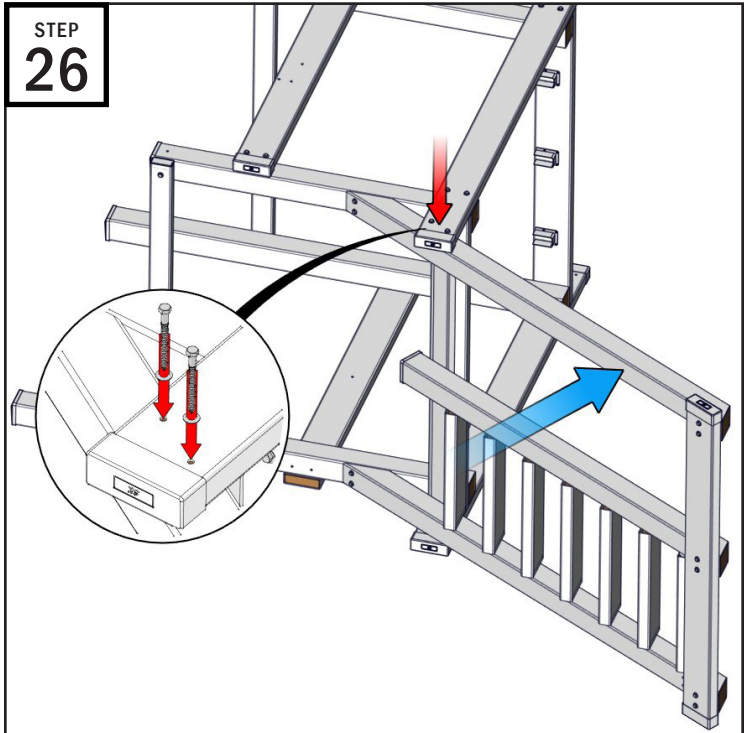

- Have a 2nd person push the end or bottom of the leg inwards so that the leg 4x4 is pushed against the tower 4x4 post.
- Using (2) 9/16" x 4" Lags & 3/8" Washers, drill into the holes at the end of "F" to fasten "F" to the leg.

STEP
27

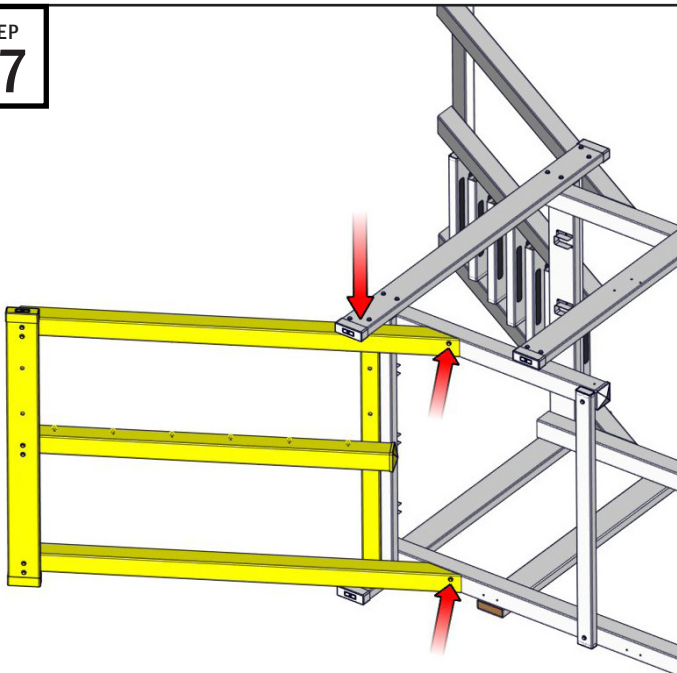

- Repeat the last 2 steps on the back side of the tower.

STEP
28

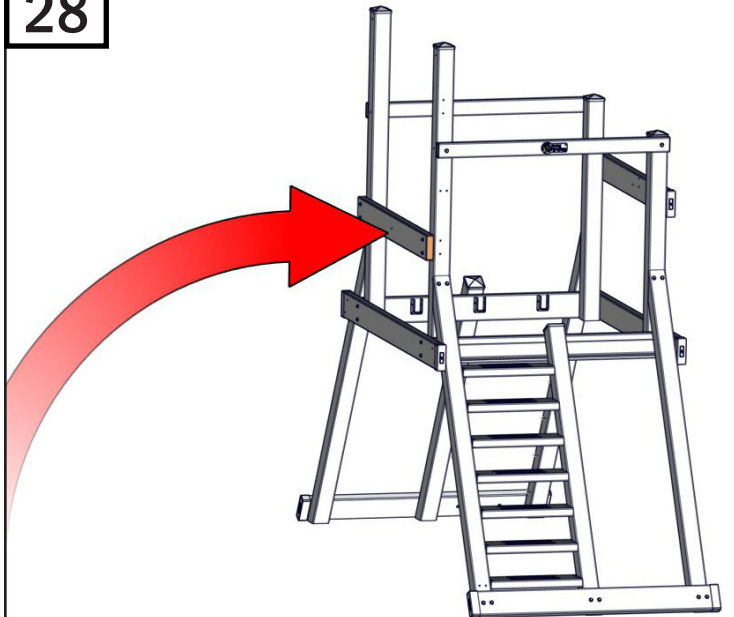

- You will want to flip the entire tower upright.

Note: This will be heavy and may take 3 people. Once you have the tower close, one person may want to position themselves to push in the opposite direction slightly to counteract the bounce-back of the tower.

FLOOR ASSEMBLY

STEP
29

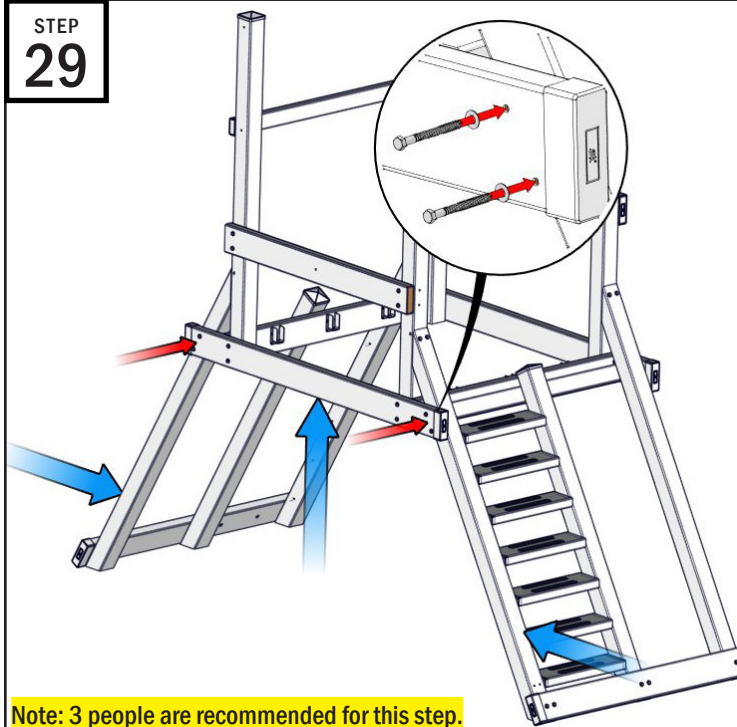

Note: 3 people are recommended for this step.

- 1 person will lift on the center of the tower while a 2nd person pushes in on the front leg. Only push enough so that the end holes on "F" are aligned with the center of the 4x4 leg post.
- Have the 3rd person fasten "F" onto the leg using (2) 9/16" x 4" Lags & 3/8" Washers.
- Repeat on the back side of the tower.

STEP
30

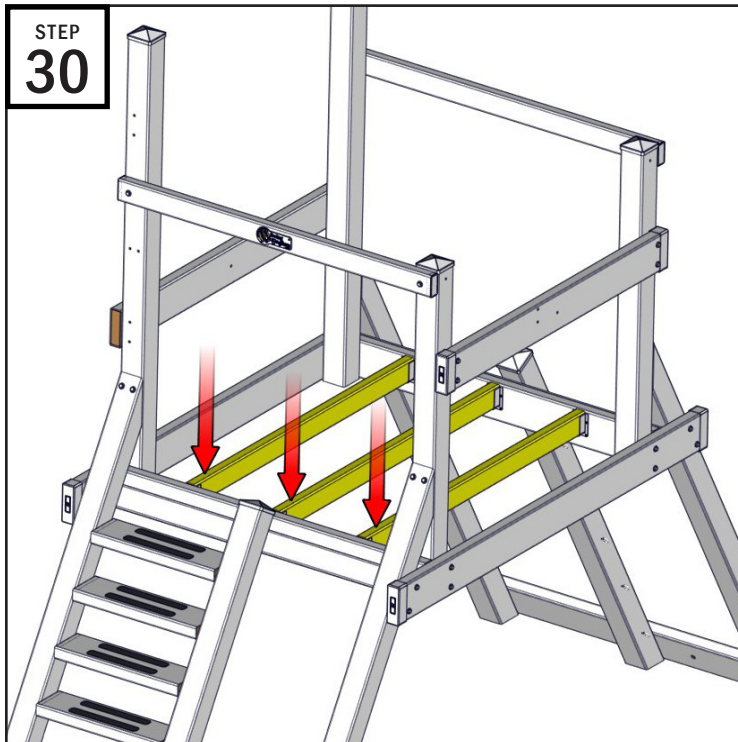

- You will have 3 joists remaining (H).
- Place these on the joist hangers.

Note: One of the joist hangers will have holes in the center, make sure that joist is in the center joist position with those holes facing downwards.

STEP
31

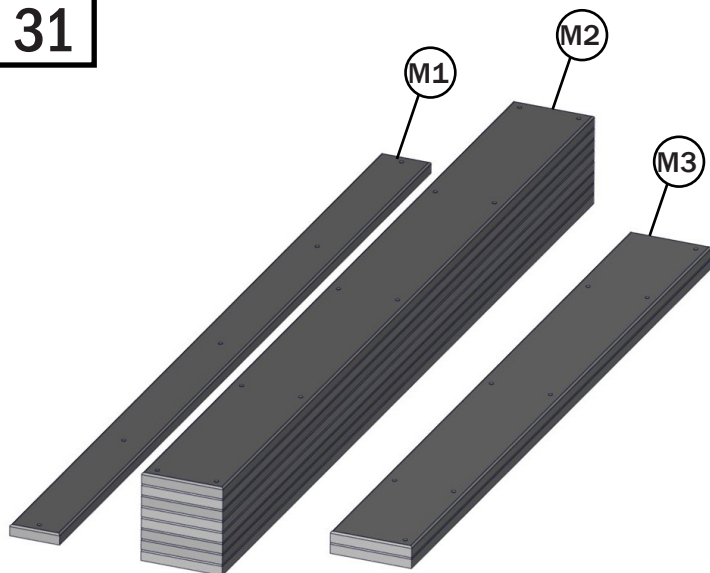

Locate and prepare the "Floorboard Bundle" which includes...

- M1: (1) 3 3/8" x 59 1/2" Floorboard
- M2: (8) 5 1/2" x 59 1/2" Floorboard
- M3: (2) 5 1/2" x 48" Floorboard

Also locate the "Floor Hardware" bag.

STEP
32

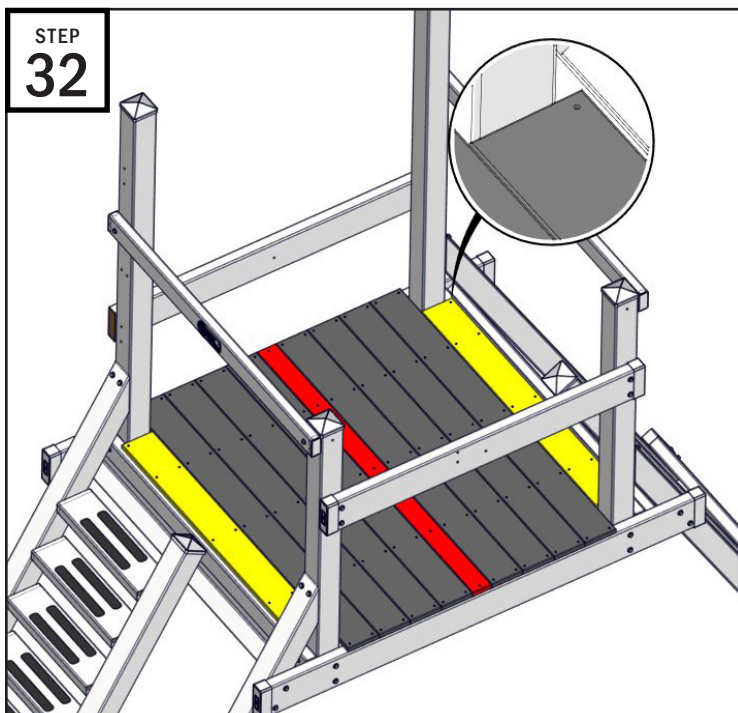

- Place the (8) "M2"s perpendicular from the joists below them.
- Place "M1" in the center of the tower.
- Place the (2) "M3"s on the sides. Make sure the corners with the pre-punched holes are facing outward.
- Center the floorboards. The boards are not 100% accurate. Run your fingers along both sides of the floorboards and adjust them one by one to make them as centered as possible.

HANDRAIL INSTALL - ROCK WALL ASSEMBLY

STEP
33

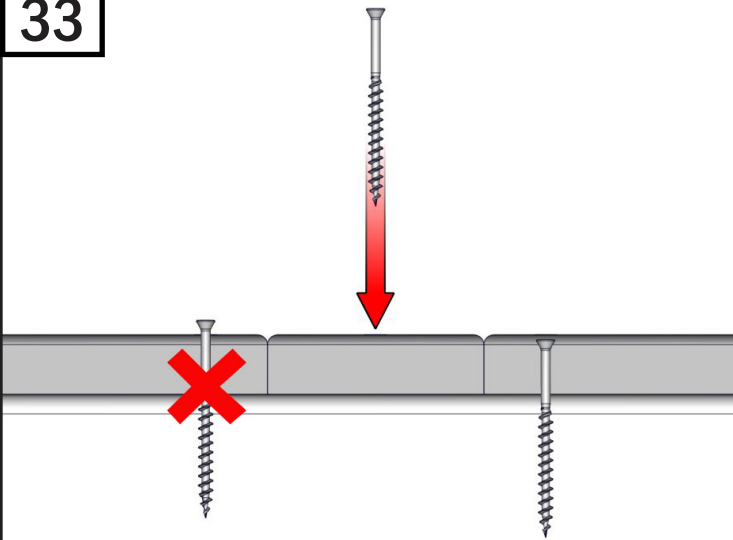

Note: Smaller screws like this can strip easily. Make sure your drill is aligned straight up and down with the screw. Stripping screws can damage the bit and cause more screw stripping.

- Center one of the corner “M2” boards and use the #2 Drive Bit to drill (1) 2” Polybuster Screw into a pre-punched corner hole.
- Repeat with the neighboring “M2”, adjusting to center all boards.
- Drill the remaining screws into the pre-punched holes. Each hole will line up with the joists and base boards underneath.

Note: Fasten the screws so the head of the screw is below the surface of the deck as shown above.

STEP
34

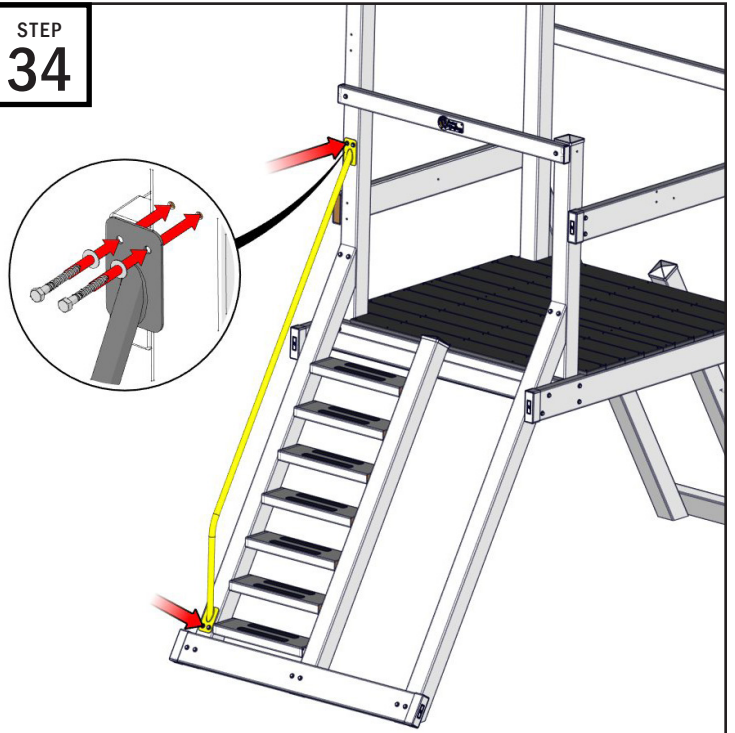

- Locate the Climber Handrail. The hardware for this will be wrapped up with the handrail.
- Place the Handrail next to the stairs with the bent end of the handrail at the bottom. Align the holes with the 4x4 post and leg.
- Use (4) 1/2” x 1 1/2” Lags & 5/16” Washers to fasten the handrail to the tower.

STEP
35

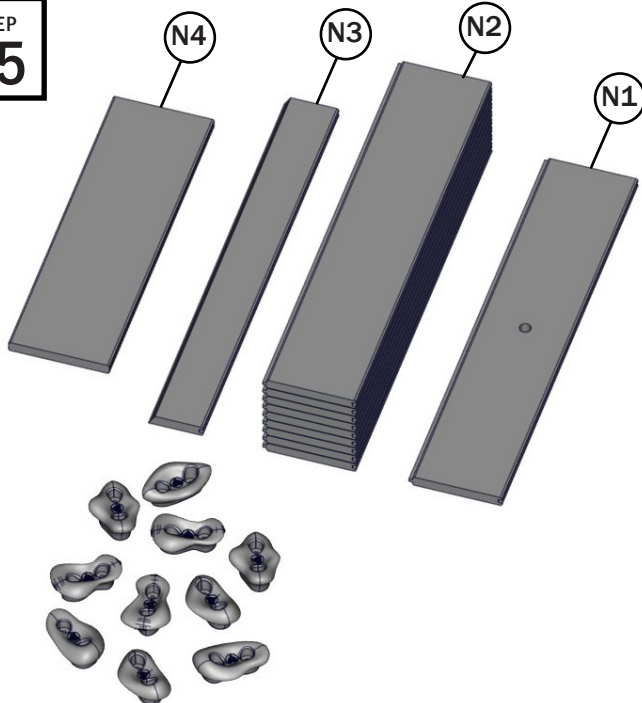

Locate and prepare the “Rock Wall Bundle” which includes...

- N1: (1) 28 1/2” Poly with End Grooves & a Center Hole
- N2: (10) 28 1/2” Poly with End Grooves
- N3: (1) 28 1/2” Poly w/ Angle Cut
- N4: (1) 22” Poly

Also locate the rock wall rocks. Continue to use the “Accessory Hardware”.

STEP
36

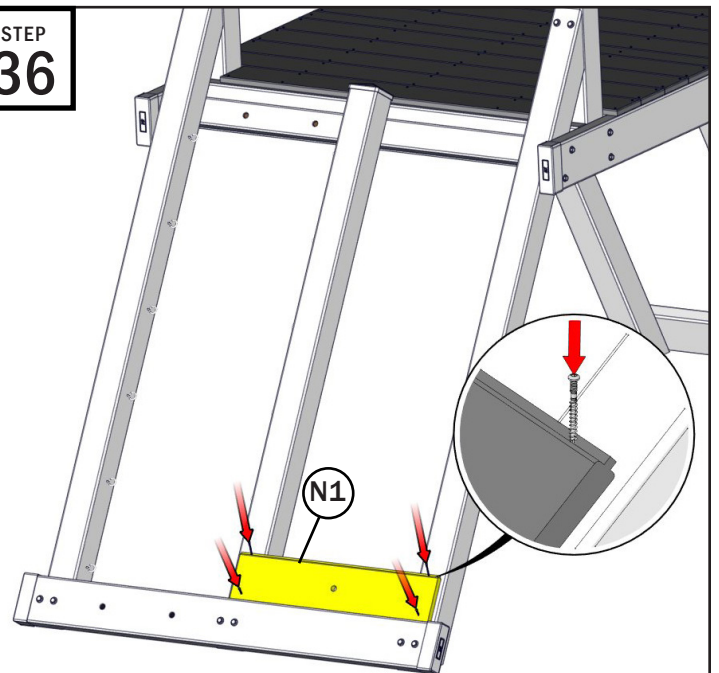

- On the back right side of the tower legs, place “N1” which has the center hole down with the male groove facing up.
- Center “N1” on the two 4x4 legs.
- Use (2) 2” Polybuster Screws at the bottom of “N1” to fasten to the 4x4 leg posts.
- To minimize the amount of visible hardware, drill (2) 2” Polybuster Screws into the top groove of “N1” at an angle.

ROCK WALL ASSEMBLY

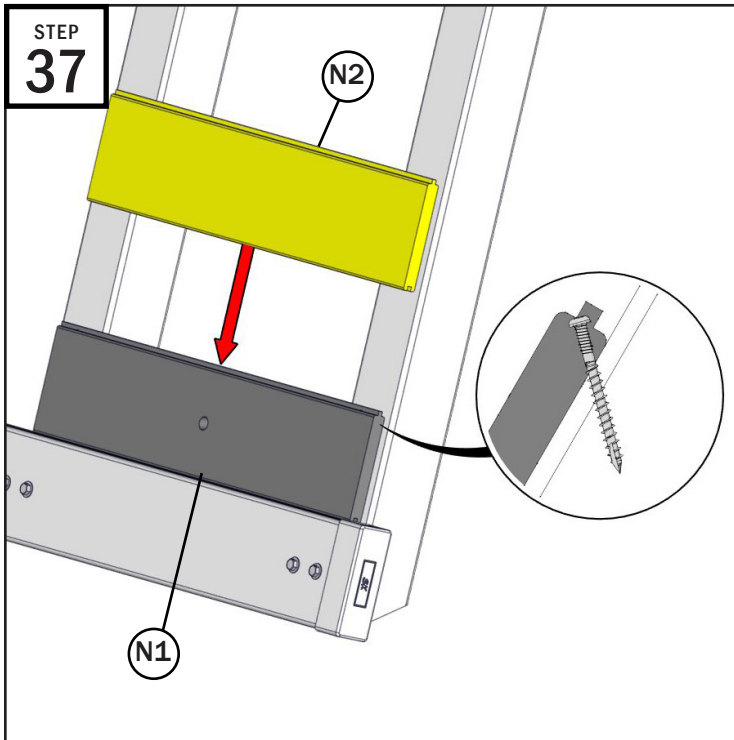

- To give enough space for the next slat, you need to drill the screw far enough so that the screw head is underneath the poly surface.
- Place "N2" on top of "N1" so that the female groove of "N2" fits over the male groove of "N1".
- Repeat the same fastening method by using (2) 2" Polybuster Screws to fasten "N2" down.

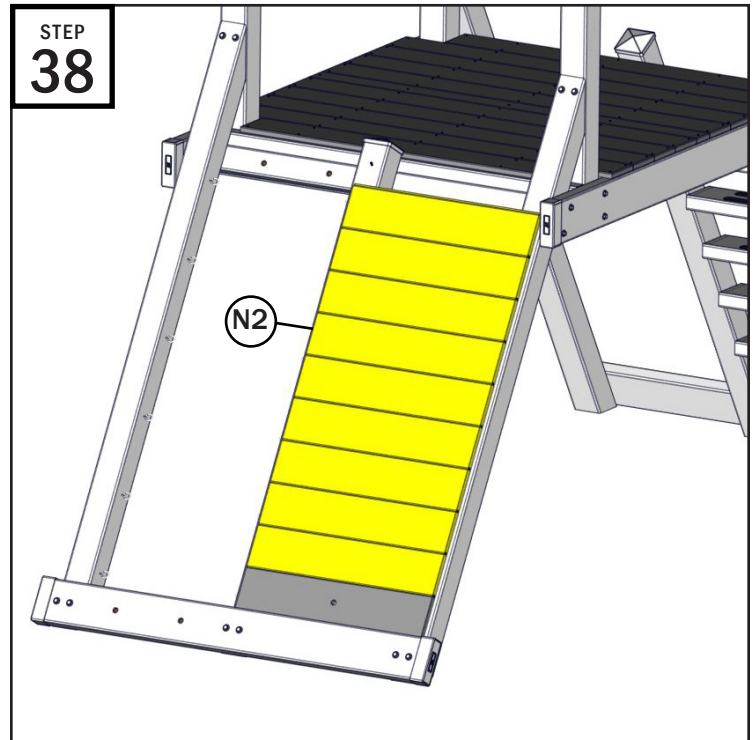

- Repeat the same process for the other (8) "N2" parts fastening them 1 by 1 as you go.

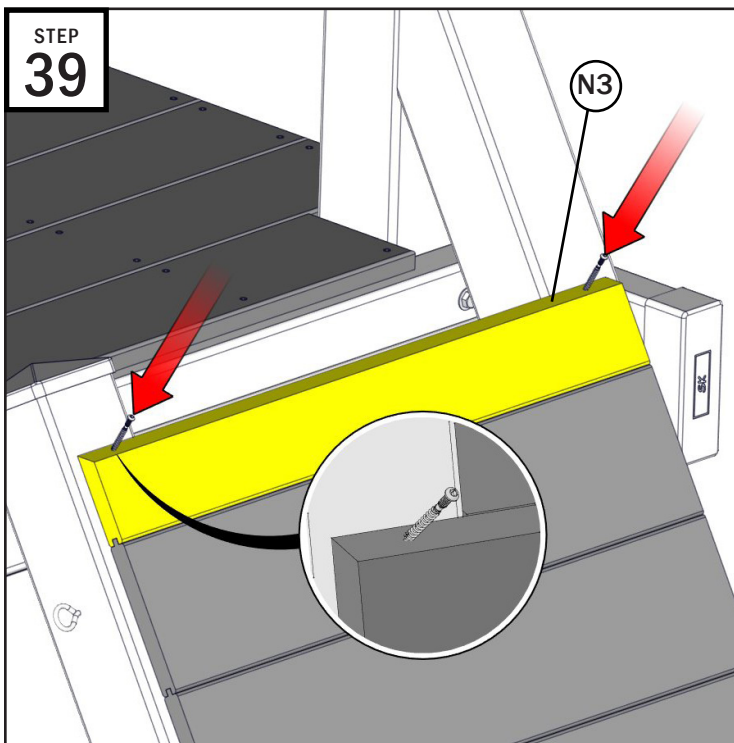

- Place "N3" on top of the top most "N2" piece.
- "N3" will have a flat end on top. You will need to angle (2) 2" Polybuster Screws to fasten "N3" to the 4x4 legs. The screw heads might be over the surface of the poly slightly.

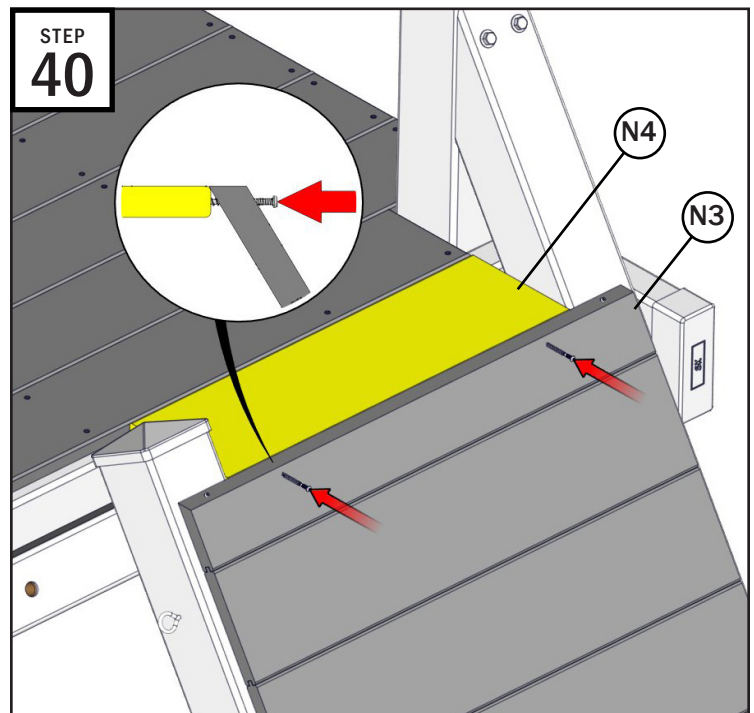

- Place "N4" between the "N3" and the floorboard decking.
- 1 person will have to fasten this board down while a 2nd will hold the board in place.
- Use (2) 2" Polybuster Screws to fasten through the front of "N3". Make sure the screws are horizontal to hit "N4" correctly.

Note: You may want to use a 3rd screw in the center for extra durability.

CARGO NET ASSEMBLY

STEP
41

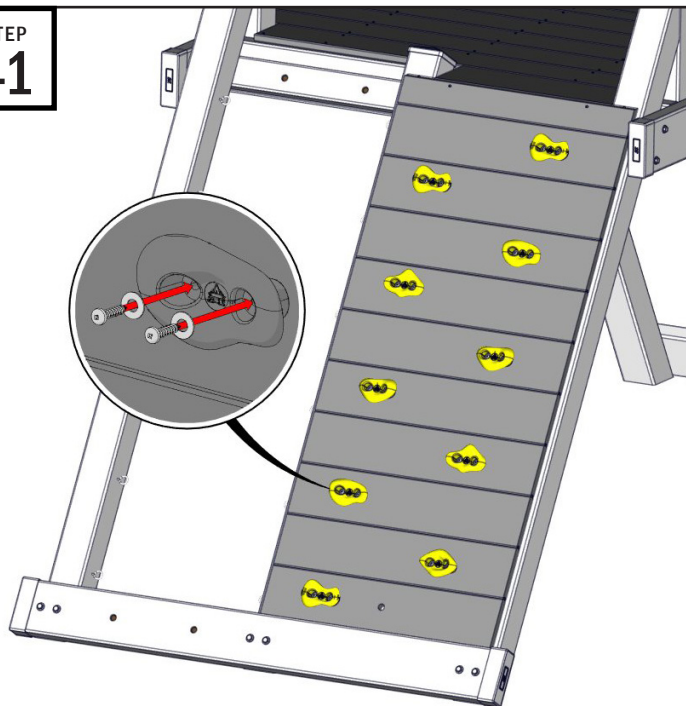

- You will have 10 thicker boards & 10 rocks. You can spread these out evenly as shown above or you can place them wherever you would like.
- One at a time, place a rock, use (1) 1/4" x 1 1/4" Pan Head Screw & 5/16" Washer, but don't fasten tightly.
- Orientate the rock to your liking (horizontal in image) & use another screw to fasten the rock the rest of the way.
- Don't forget to tighten the other side.

STEP
42

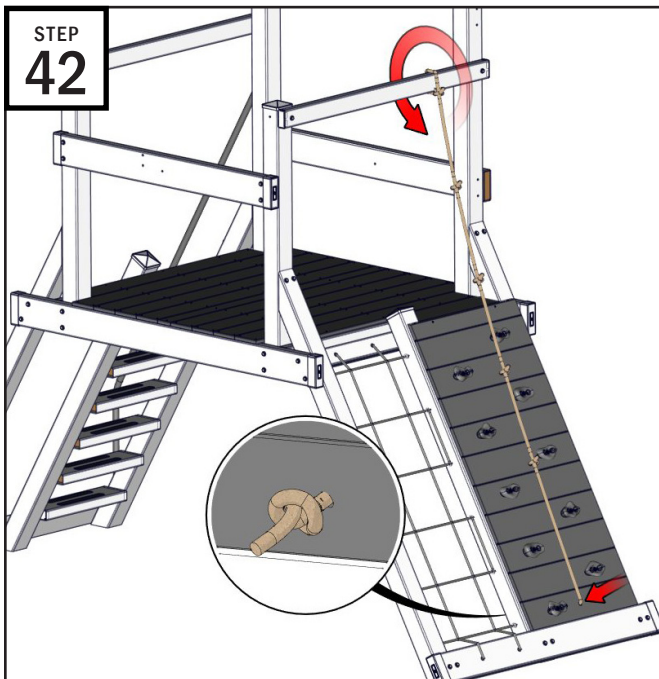

Note: Locate the 3 ropes. 2 ropes will have a 5/8" diameter when the other has 1" diameter. For this step, you will need the thicker 1" rope.

- Loop one end of the rope around the tower 2x6 railing above the rock wall and tie it to itself to fasten the rope to the tower.
- Add a few knots in the middle of the rope spaced evenly apart.
- There is a hole at the bottom of the rock wall. Place the other end of the rope through there, leave some slack, and tie the rope in a knot on the underside of the rock wall.

STEP
43

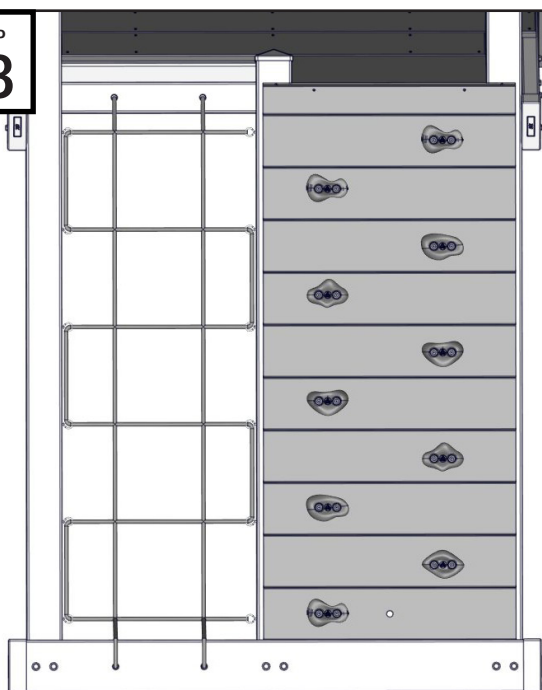

For the Cargo Net, you will utilize both of the thinner ropes (5/8" diameter).

- For the next few steps, you will need to carefully follow the steps.
- We want to have the cargo net as tight as possible, so you will want to pull the rope tight for every loop you make in the following steps.

STEP
44

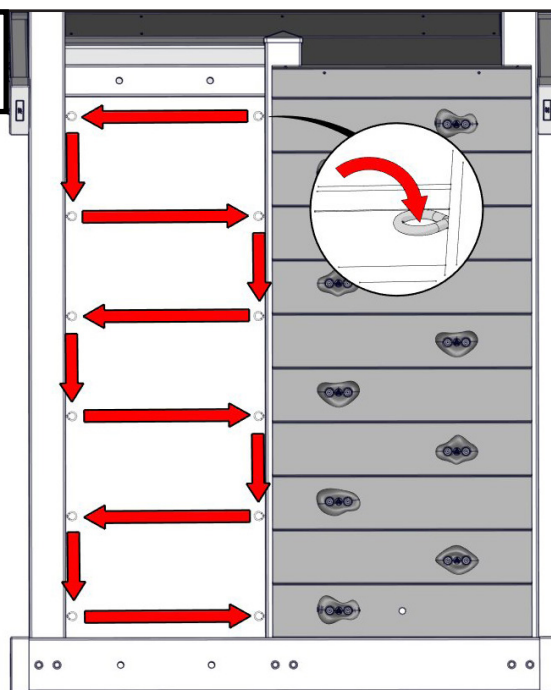

- Start at the top right eye bolt. Loop one rope through the bolt.
- Tie the end of the rope in a knot so it won't slip through the bolt.
- Following the above pattern, looping the rope through each bolt. (Go across, down, across, down, and continue until you reach the bottom.)
- The last eye bolt will be on the same side you started on. Loop the end of the rope through the bolt and knot the end of the rope pulling tight.
- Tuck any excess rope under the leg so it's out of the way.

CARGO NET ASSEMBLY

STEP
45

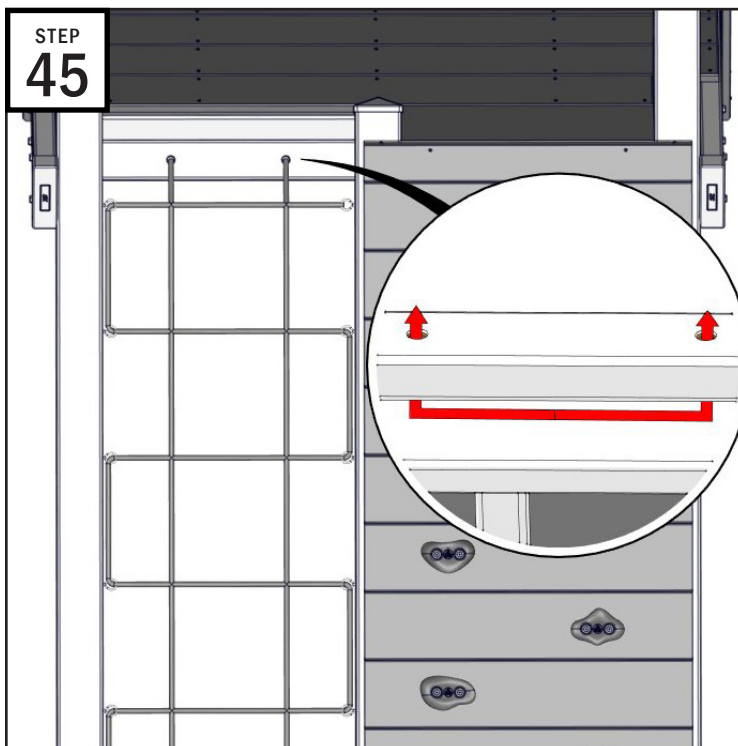

- Grab the 2nd 5/8" diameter rope.
- Go under the tower and loop the rope through the holes so that the ends of the rope will be facing away from the playset.
- Pull both ends of the rope evenly. The center of the rope will be hidden behind that top 2x4.
- Let the rope ends hang behind the eye bolt rope.

STEP
46

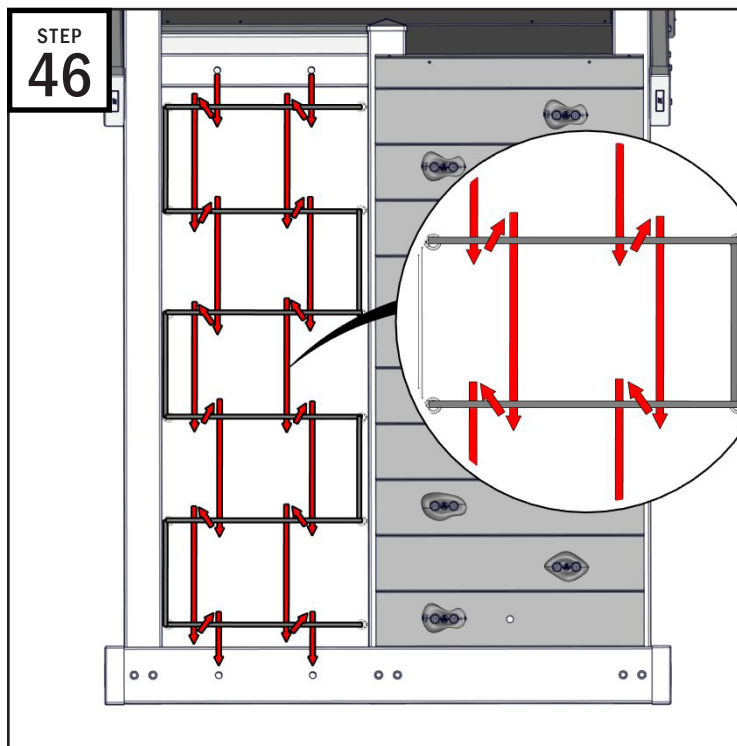

- Loop the rope around the horizontal rope. All loops will go under the horizontal rope. Alternate left and right sides for each loop.
- Both rope ends/sides will go to the same direction (right-right or left-left).
- Continue the pattern, pulling tight as you go.

STEP
47

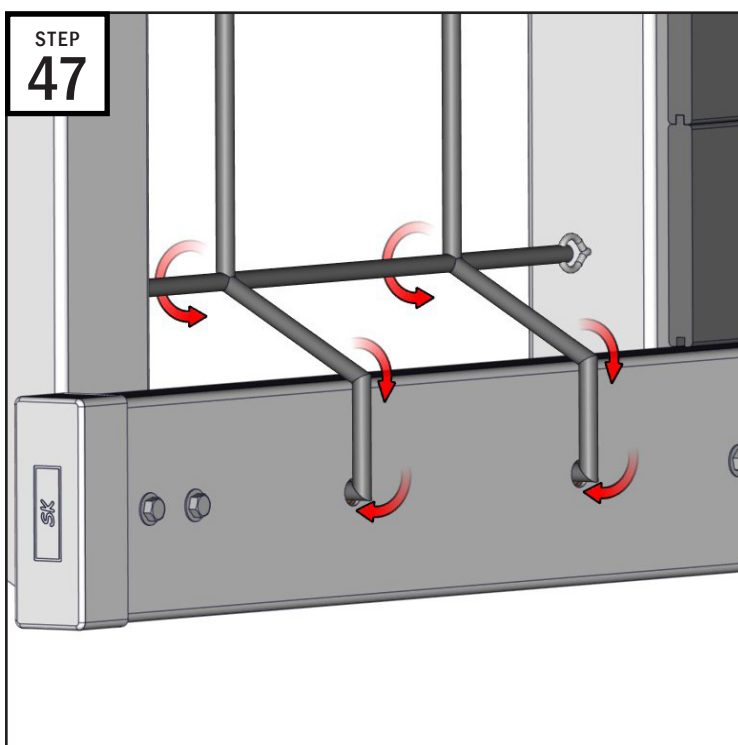

- After you finish the last loop, bring the rope over the 2x6 base.
- Run the rope ends through the holes.
- Behind the 2x6, pull the rope tight & tie a knot into both ends just like the rock wall rope.
- Tuck any excess rope under the leg so it's out of the way.

STEP
48

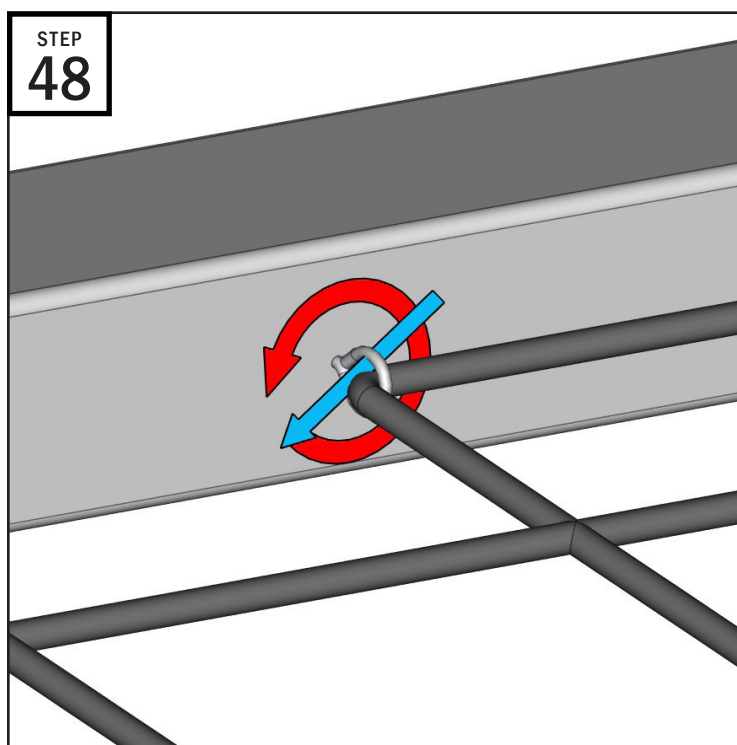

If the rope on the cargo net is loose, here is a tip to help tighten everything.

- Insert a screwdriver end through the eye bolt.
- Twist the eye bolt (It is not recommended to rotate more than 1 1/2 rotations). This will twist the rope around the eye bolts making the cargo netting tighter.
- Continue on the other eye bolts as needed.

EXTENSION TOWER ASSEMBLY

STEP
49

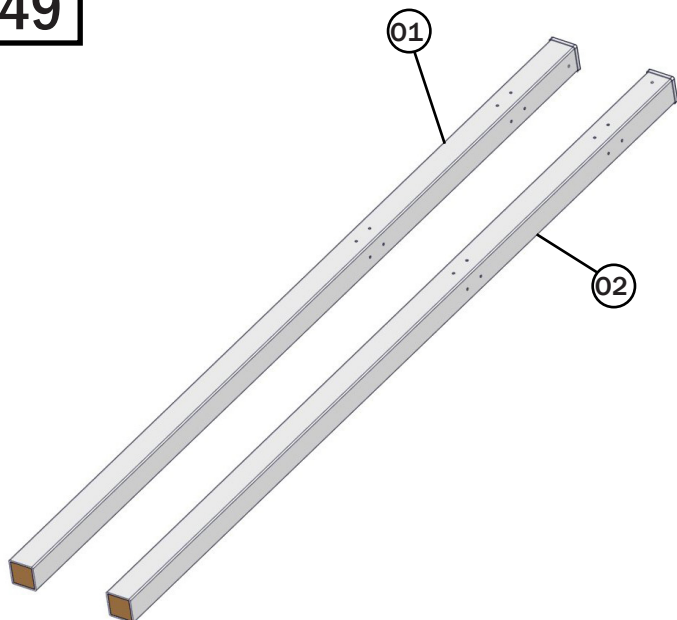

Locate the "Extension Post Bundle" which will include...

- 01: (1) 127" 4x4 Post with Top Right Hole
- 02: (1) 127" 4x4 Post with Top Left Hole

You will continue to use the tower hardware.

STEP
50

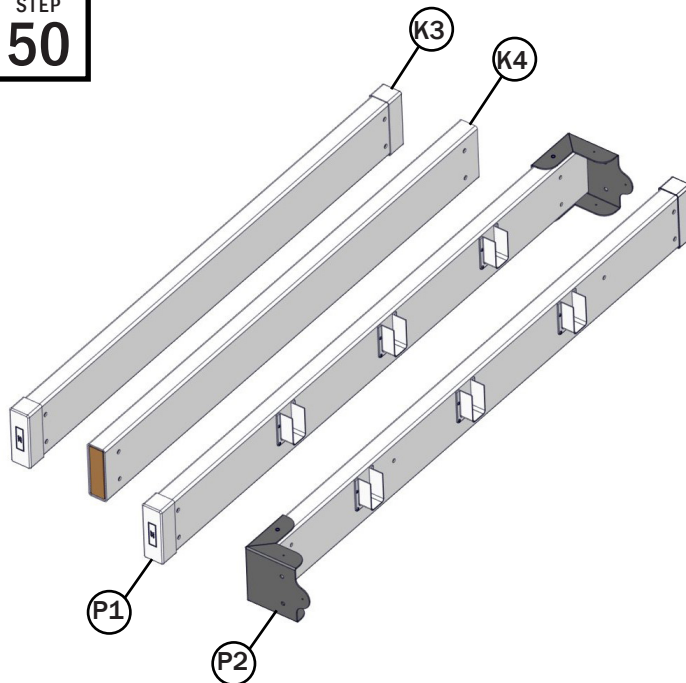

Locate the "Extension Floor Bundle" which will include...

- K3: (1) 56" 2x6 w/ End Caps
- K4: (1) 56" 2x6
- P1: (1) 64" 2x6 w/ Corner Bracket (right), End Cap, & Brace Holes
- P2: (1) 64" 2x6 w/ Corner Bracket (left), End Cap, & Brace Holes

STEP
51

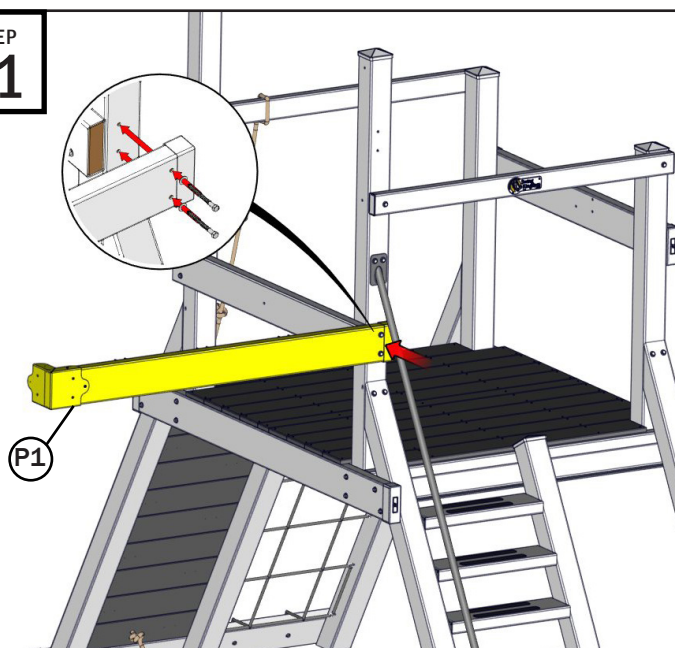

Note: DO NOT OVER-TIGHTEN. Fasten them enough so the parts touch.
If the vinyl starts to dent or dimple, you know it is tight enough.

- Place "P1" on the front of the tower under the handrail with the corner bracket side facing away from the tower & the joist hangers are on the inside with the openings facing upwards.
- Use (2) 9/16" x 4" Lags & 3/8" Washers to help align & fasten "P1" to the 4x4 post on the existing tower.
- You can start fastening the other side to help find the holes for the next step if you wish.

STEP
52

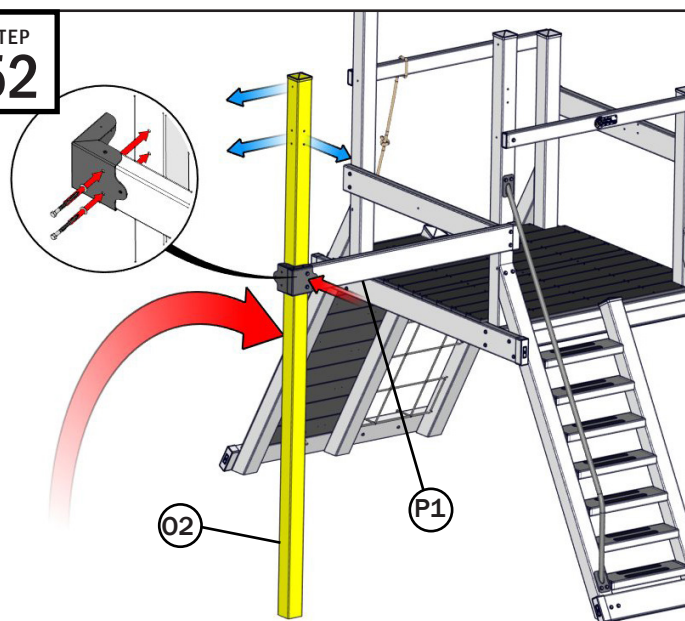

Note: DO NOT OVER-TIGHTEN. Fasten them enough so the parts touch.
If the vinyl starts to dent or dimple, you know it is tight enough.

- Place "02" on the ground and flip it up to the corner bracket side of the free hanging "P1".
- Make sure the top hole is facing away from the climber tower and there are 4 holes that line up with both sides of the corner bracket.
- Use (2) 9/16" x 4" Lags & 3/8" Washers to help align & fasten "02" to "P1"

Note: Do not fasten the corner bracket side that doesn't have a 2x6 post in.

EXTENSION TOWER ASSEMBLY

STEP
53

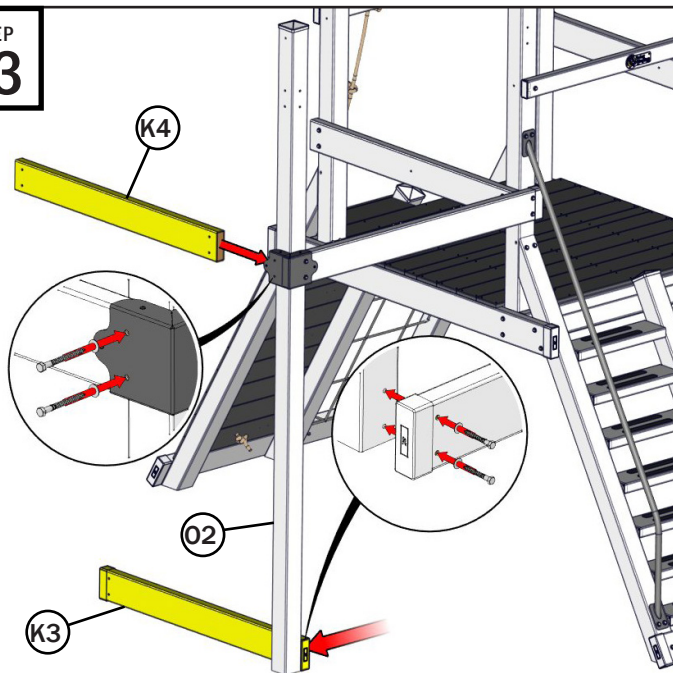

Note: DO NOT OVER-TIGHTEN. Fasten them enough so the parts touch.
If the vinyl starts to dent or dimple, you know it is tight enough.

- Place "K3" at the base of "O2".
- Place "K4" inside the corner bracket opening.
- Line up the holes on each & fasten them together using (4) 9/16" x 4" Lags & 3/8" Washers.

STEP
54

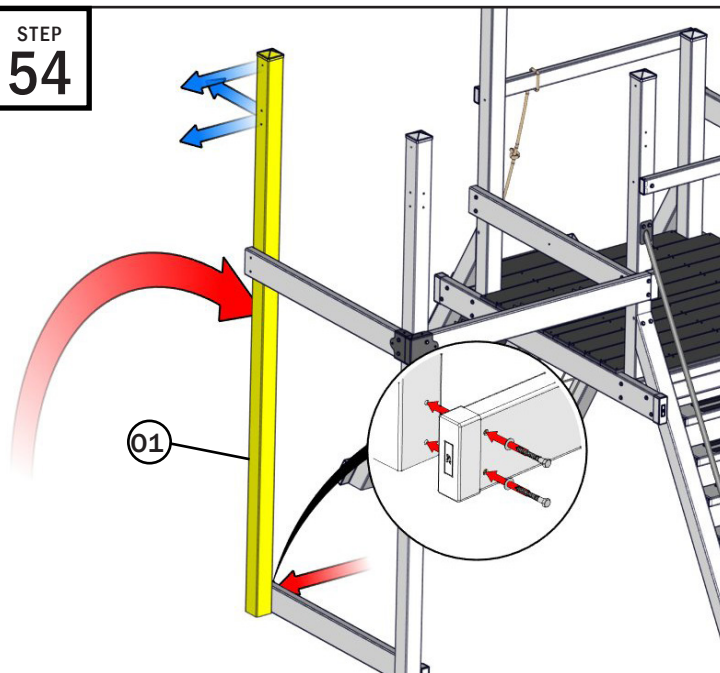

Note: DO NOT OVER-TIGHTEN. Fasten them enough so the parts touch.
If the vinyl starts to dent or dimple, you know it is tight enough.

- Place the base of "O1" outside the other end of the 2x6 base.
- Flip "O1" up with the top hole facing away from the tower & the side holes are facing away from the tower & backwards.
- There will be 2 bottom holes that line up with the 2x6 base.
- Use (2) 9/16" x 4" Lags & 3/8" Washers to fasten the base.

STEP
55

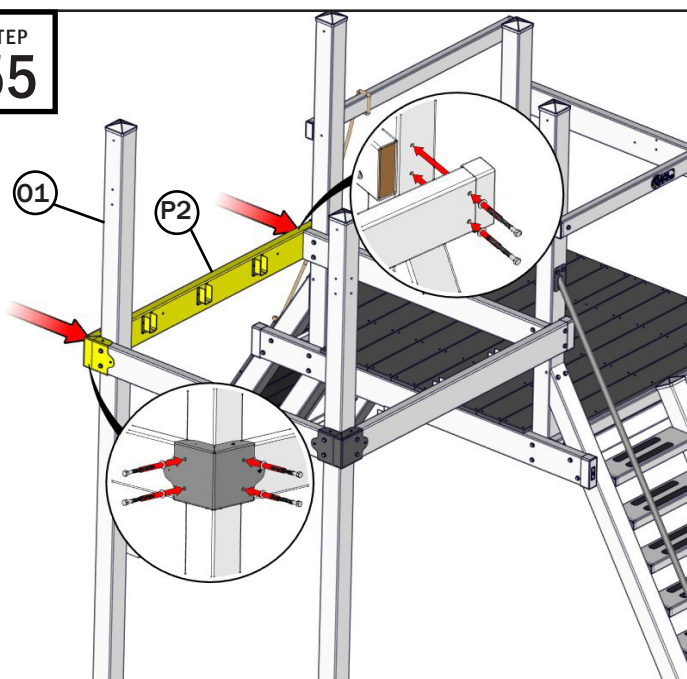

Note: DO NOT OVER-TIGHTEN. Fasten them enough so the parts touch.
If the vinyl starts to dent or dimple, you know it is tight enough.

- Place "P2" with the corner bracket around "O1" & the end cap side on the climber tower. The joist hangers will be facing inwards to the tower & the joist openings are facing upwards.
- Use (6) 9/16" x 4" Lags & 3/8" Washers to fasten "P2" to "O2" & to the climber tower.

STEP
56

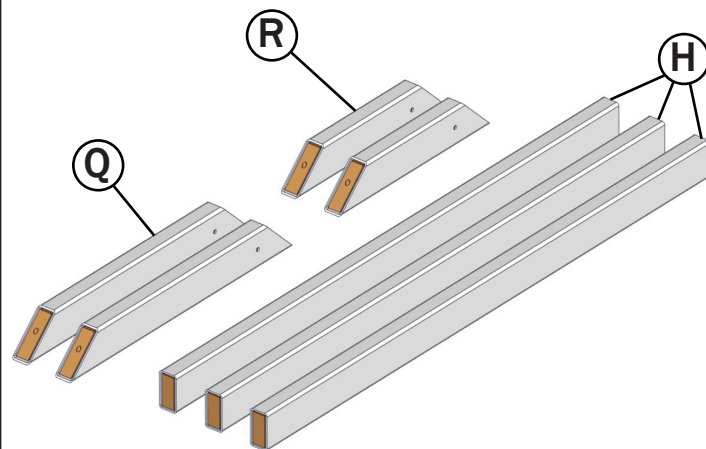

Locate the "Extension Post Bundle" which will include...

- H: (3) 55 3/4" 2x4 Joist
- Q: (2) 28" 2x4 Brace
- R: (2) 19" 2x4 Brace

EXTENSION TOWER ASSEMBLY

STEP
57

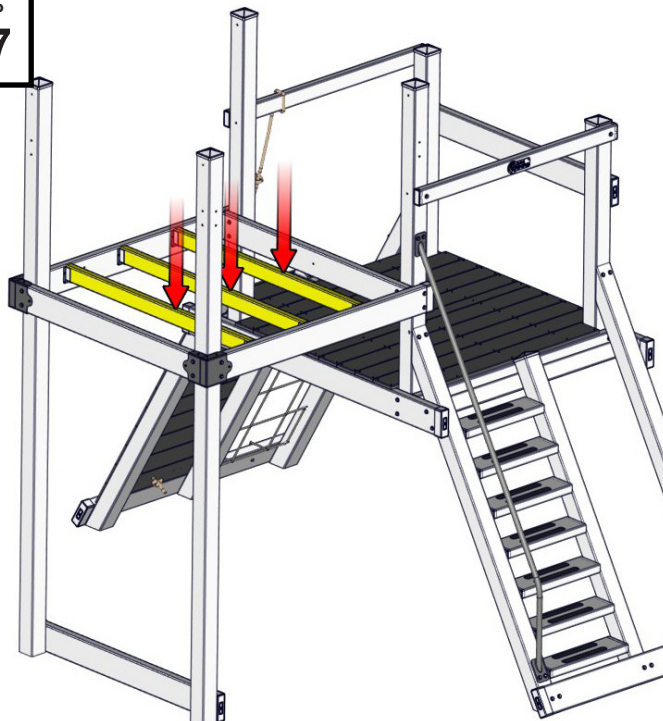

- Place "H" in the joist hanger slots.

Note: One of the joist hangers will have holes in the center, make sure that joist is in the center joist position with those holes facing downwards.

STEP
58

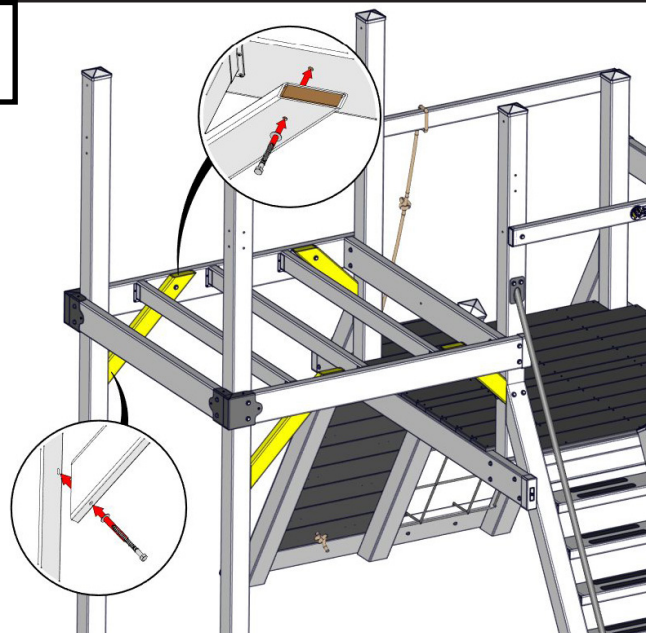

Note: DO NOT OVER-TIGHTEN. Fasten them enough so the parts touch. If the vinyl starts to dent or dimple, you know it is tight enough.

- Place the braces with the end holes facing down and the side holes on top. The larger Braces (Q) will be away from the tower while the shorter Braces (R) will be closest to the climber tower.
- One brace at a time, you will use (1) 9/16" x 4" Lags & 3/8" Washers to fasten the bottom of the brace to the 4x4 post.
- Then use, (1) 9/16" x 3" Lags & 3/8" Washers to fasten the side top, side of the brace to the 2x6 tower framing.

STEP
59



Locate and prepare the "Floorboard Bundle" which includes...

- M1: (1) 3 3/8" x 59 1/2" Floorboard
- M2: (8) 5 1/2" x 59 1/2" Floorboard
- M4: (2) 5 1/2" x 53 3/4" Floorboard

You will continue to use the "Floor Hardware" bag.

STEP
60

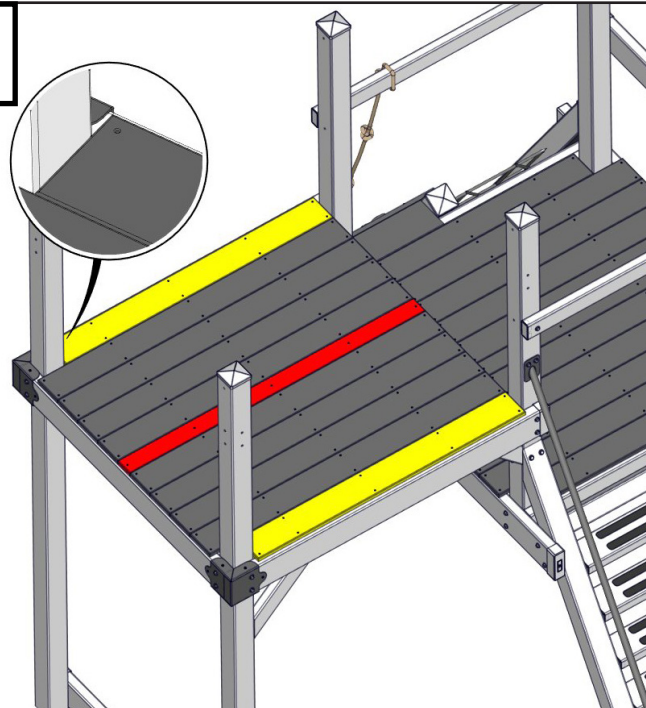

- Place the (8) "M2"s perpendicular from the joists below them.
- Place "M1" in the center of the tower.
- Place the (2) "M3"s on the sides. Make sure the corners with the pre-punched holes are facing outward.
- Center the floorboards. The boards are not 100% accurate. Run your fingers along both sides of the floorboards and adjust them one by one to make them as centered as possible.

EXTENSION TOWER ASSEMBLY

STEP
61

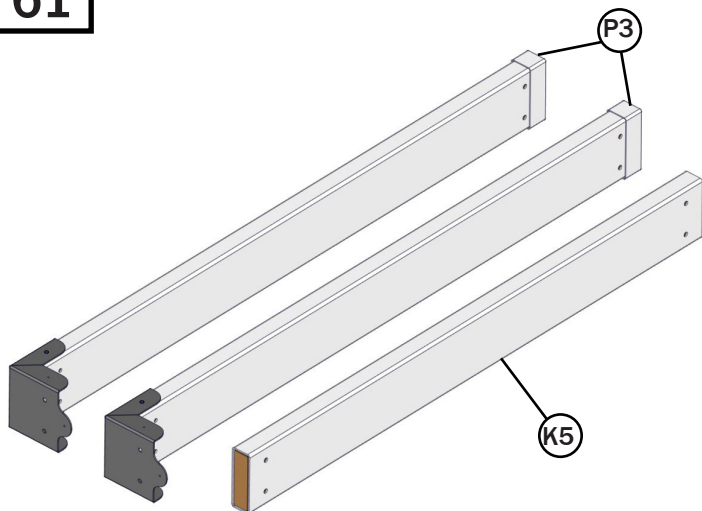

Locate and prepare the "Extension Railing Bundle" which includes...

- K5: (1) 56" 2x6 w/ Roof Partial-Hole
- P3: (2) 62" 2x6 w/ Corner Bracket & End Cap

STEP
62

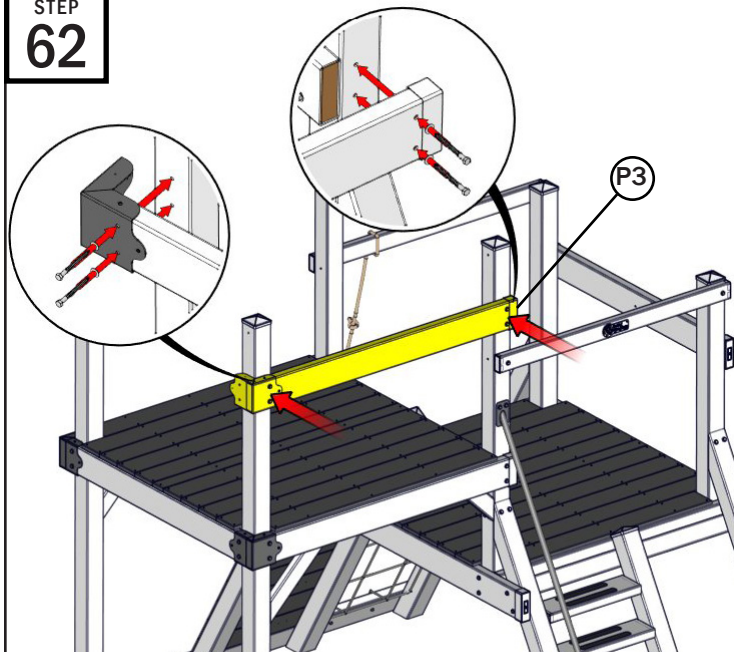

Note: DO NOT OVER-TIGHTEN. Fasten them enough so the parts touch. If the vinyl starts to dent or dimple, you know it is tight enough.

- Place one of the "P3" items on the front of the tower with the end cap on the climber tower side.
- Using (4) 9/16" x 4" Lags & 3/8" Washers, drill into the large holes of the 2x6 so that the tip of the lags are showing on the other side.
- Use the tip of the lags to find the holes on the 4x4 posts.
- Fasten the Lags the into the 4x4 post.

STEP
63

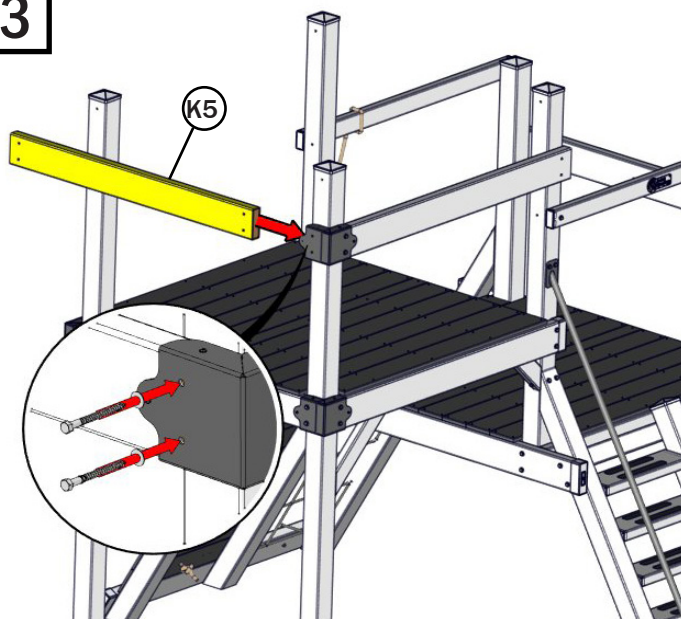

Note: DO NOT OVER-TIGHTEN. Fasten them enough so the parts touch. If the vinyl starts to dent or dimple, you know it is tight enough.

- Place "K5" inside the corner bracket opening. Make sure the partial hole is facing inward on the tower.
- Line up the holes on "K5" with the corner bracket.
- Finish fastening the front corner bracket with (2) 9/16" x 4" Lags & 3/8" Washers.

STEP
64

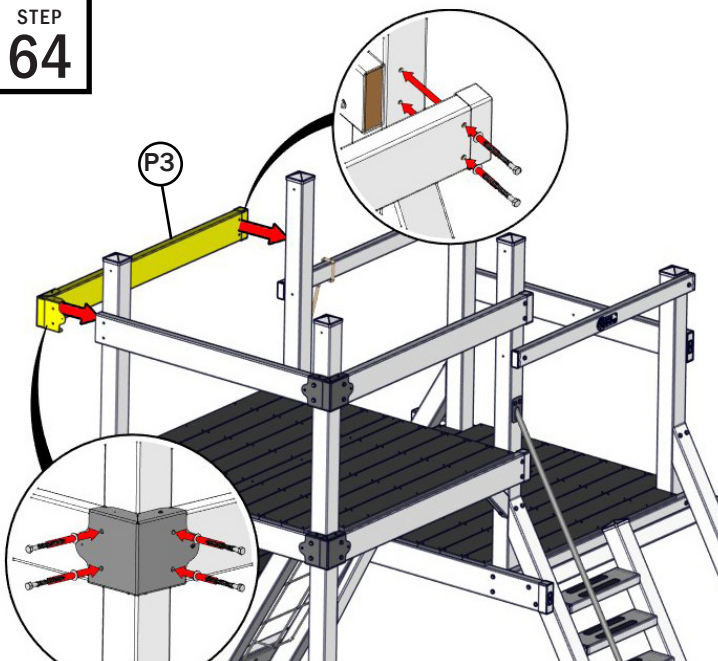

Note: DO NOT OVER-TIGHTEN. Fasten them enough so the parts touch. If the vinyl starts to dent or dimple, you know it is tight enough.

- Place the other "P3" with the corner bracket fitting around "K5" & the end cap side closer to the climber tower.
- Use (6) 9/16" x 4" Lags & 3/8" Washers align and fasten this piece with the tower.

SWING FRAME ASSEMBLY

STEP
65

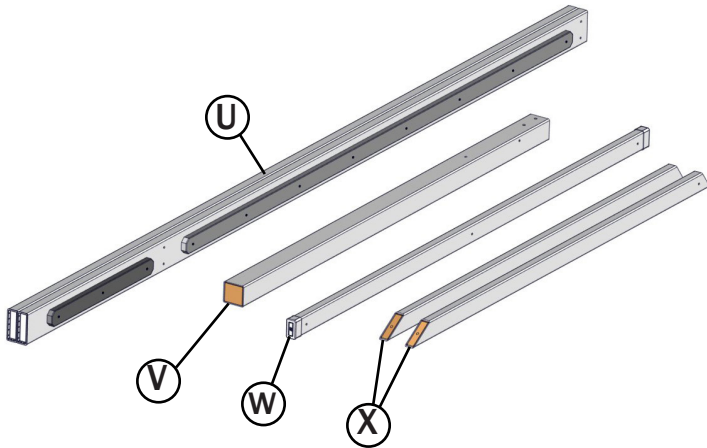

- Locate the "Swing Beam" & "Swing Frame" Bundles which will include:
- U: (1) 126" Swing Beam (The only item in the Swing Beam Bundle.)
 - V: (1) 92" 4x4 Post
 - W: (1) 106" 2x4 Ground Runner
 - X: (2) 89" 2x4 Brace

Also locate the "Swing Frame" & "Swing Hook" Hardware bags.

STEP
66

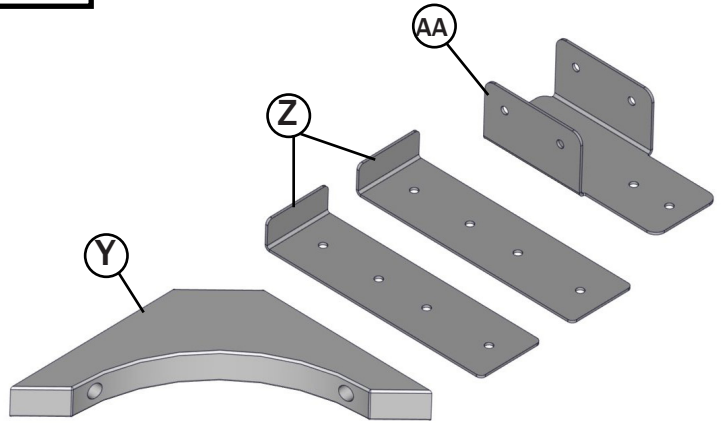

You will also want to locate the "Swing Support Bundle" which includes:

- Y: (1) Poly Brace
- Z: (2) Swing Beam Post Plate
- AA: (1) Swing Beam Bracket

STEP
67

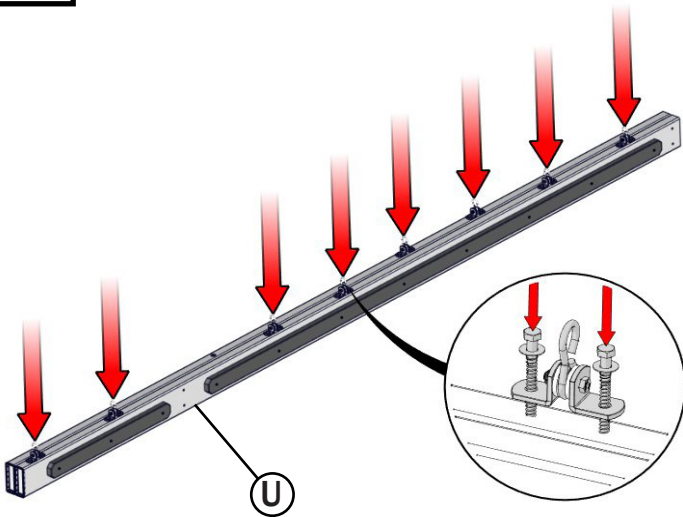

- Place "U" on the ground with the holes facing upwards.
- Open the "Swing Hook Hardware" bag.
- Place the swing bearings aligning them with the pre-drilled double holes. Ignore the single hole towards one of the ends for now.
- Fasten the bearings using (12) 9/16" x 4" Lag (2 per bearing).

STEP
68

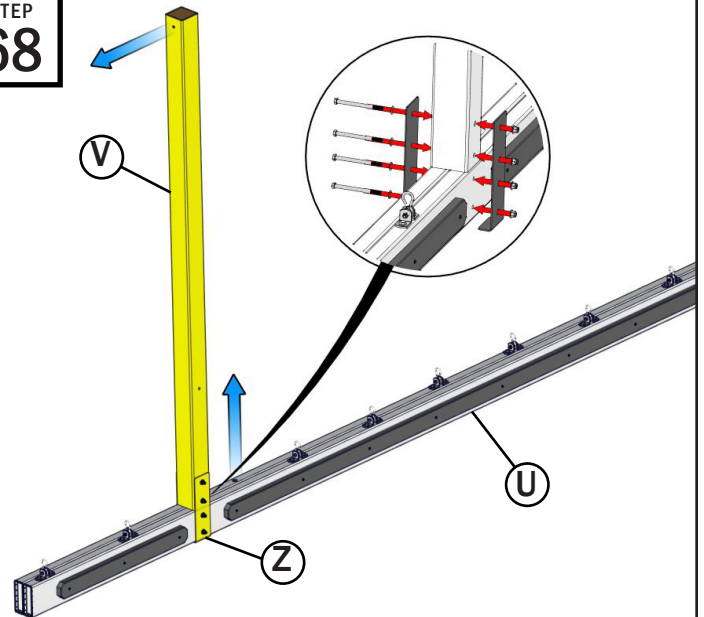

Note: DO NOT OVER-TIGHTEN. Fasten them enough so the parts touch. If the vinyl starts to dent or dimple, you know it is tight enough.

- Place "V" on top of "U" on the side of the single hole. "V" has a hole on one end that is centered. Make sure that hole is on the opposite and is facing away from "U"
- Place both "Z"s on each side of "U" & "V" aligning the holes as shown with the short end of "Z" going underneath "U".
- Fasten them together using (4) 9/16" x 5" Bolts, (8) 3/8" Washers and (4) 9/16" Locking Nuts.

SWING FRAME ASSEMBLY

STEP
69

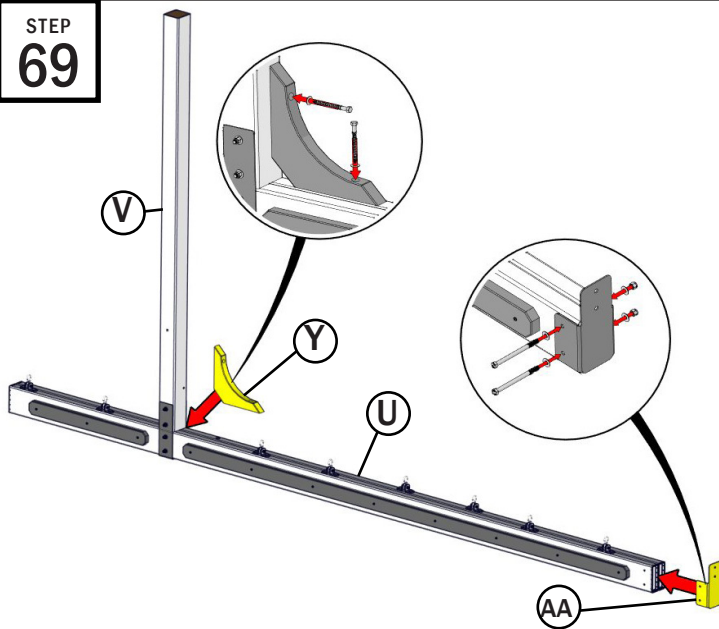

Note: You may have an extra "Y" piece in case you want to add one to the other side of "V"

- Place "Y" in the corner between "V" & "U" aligning the holes of "Y" with the single holes on "V" & "U".
- Fasten "Y" using (2) 9/16" x 4" Lags & 3/8" Washers.
- Slide "AA" on the other side of "U" aligning the side holes on both. Make sure the straight section on "AA" faces upwards.
- Fasten "AA" to "U" using (2) 9/16" x 5" Bolts, (4) 3/8" Washers and (2) 9/16" Locking Nuts.

STEP
70

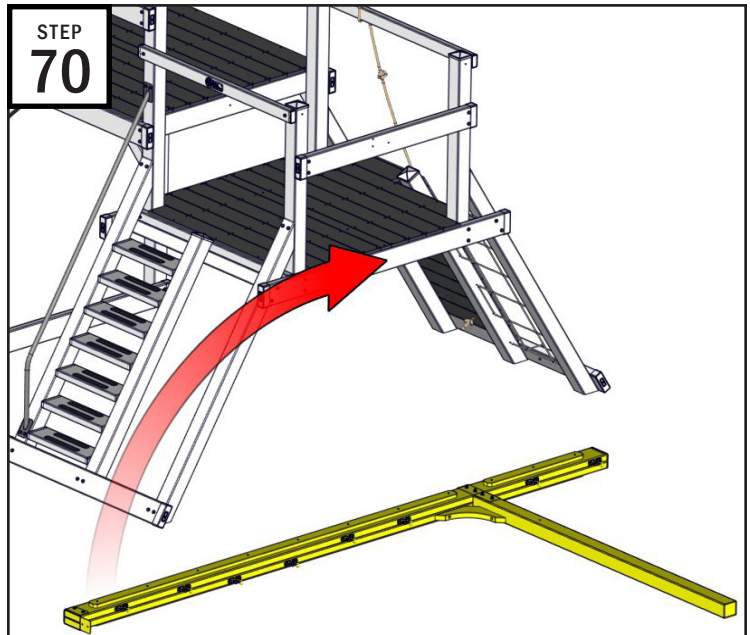

Note: This step may require 3 people to lift the swing frame.

- Place the swing frame back on the ground.
- Position the swing frame next to the tower, as shown above.
- Leaving the 4x4 post on the ground, tilt the end furthest from the 4x4 post up.
- 1 person will need to be on the tower to grab the top end of the swing frame and hold it through the next step.

STEP
71

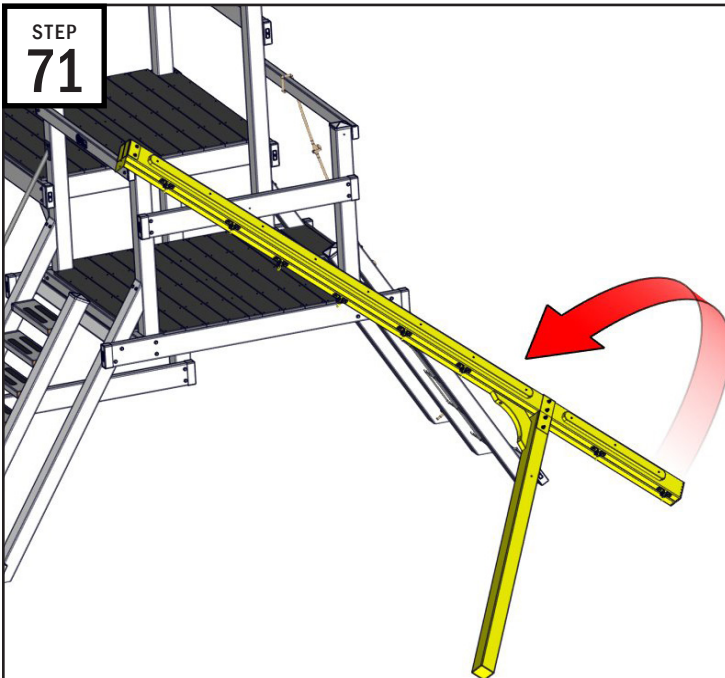

- Leaving the bottom end of the 4x4 post on the ground, the 1st person will lift the corner up. This will twist the frame into place.
- Both people will need to work together to adjust & get the swing beam in position so that the bracket holes line up with the holes on the tower.

STEP
72

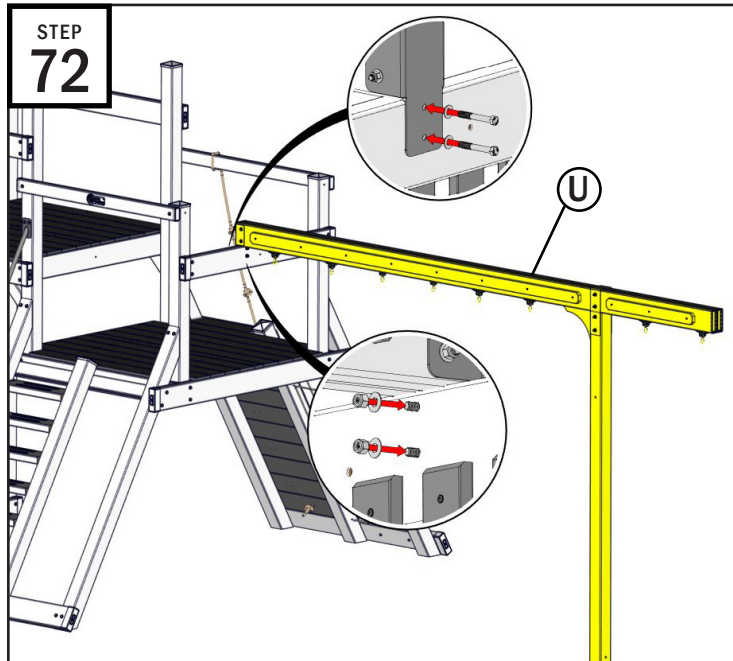

Note: DO NOT OVER-TIGHTEN. Fasten them enough so the parts touch. If the vinyl starts to dent or dimple, you know it is tight enough.

- The person on the tower should be able to rest their end on the railing. That person will need to align the holes on the bracket with the holes on the 2x6 Railing.
- These will fasten together using (2) 9/16" x 2 3/4" Bolts, (4) 3/8" Washers and (2) 9/16" Locking Nuts.

ROOF ASSEMBLY (1)

STEP
73

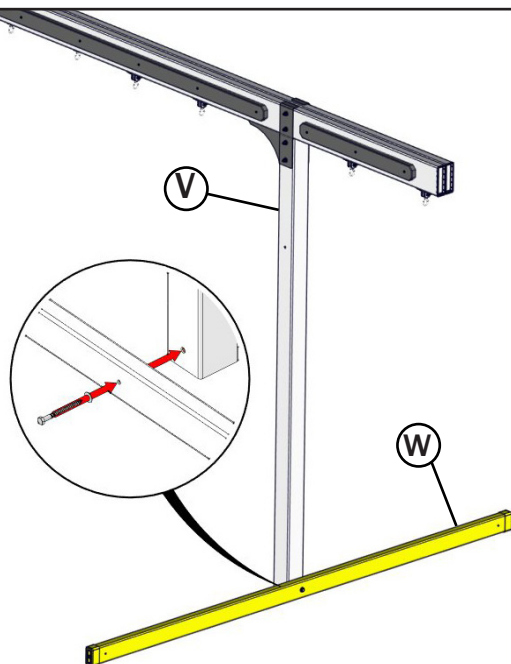

Note: DO NOT OVER-TIGHTEN. Fasten them enough so the parts touch. If the vinyl starts to dent or dimple, you know it is tight enough.

- Place "W" on the ground on the outside of "V".
- Align the center hole on "W" with the hole at the bottom of the "V".
- Fasten together using (1) 9/16" x 4" Lags & 3/8" Washers.

STEP
74

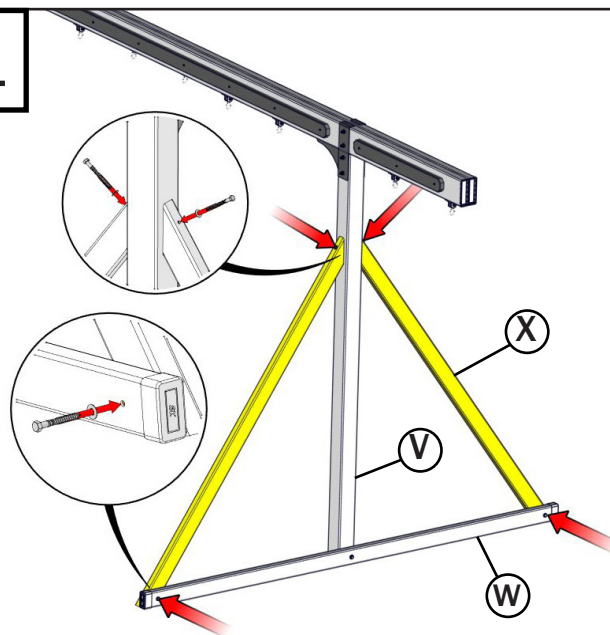

Note: DO NOT OVER-TIGHTEN. Fasten them enough so the parts touch. If the vinyl starts to dent or dimple, you know it is tight enough.

- Place the (2) "X" braces on both side of the "V". Align the pre-drilled holes. You may need to flip the ends if the holes don't line up.
- Fasten the top of "X" to the 4x4 Post using (2) 9/16" x 4" Lags & 3/8" Washers.
- Fasten the bottom of "X" ends to the "W" 2x4 using (2) 9/16" x 3" Lags & 3/8" Washers.

STEP
75

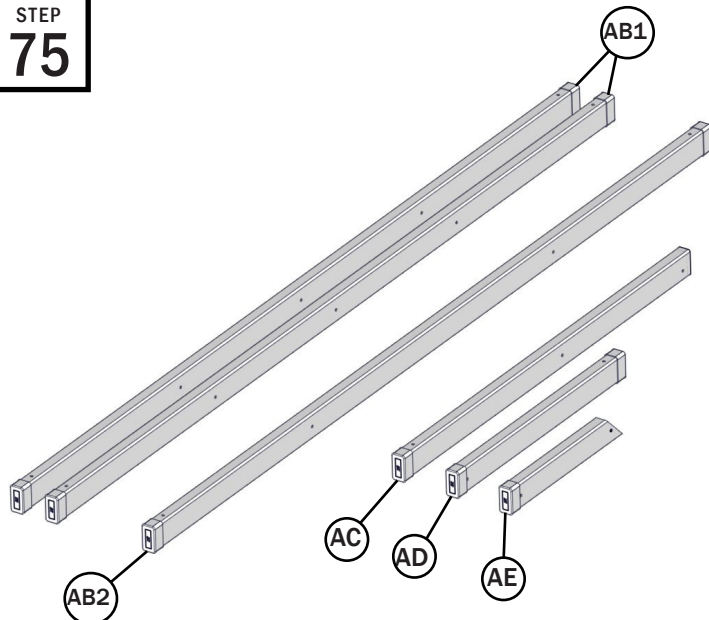

Locate and prepare the "Roof Railing Bundle 1 & 2" which includes...

- AB1: (2) 120" Roof 2x4 Railing
- AB2: (1) 120" Roof 2x4 Railing w/ Center Partial Hole
- AC: (1) 61 5/8" 2x4 Railing
- AD: (1) 35 3/4" 2x4 Railing
- AE: (1) 24" 2x4 Brace

You will continue to use the "Roof Hardware" bag.

STEP
76

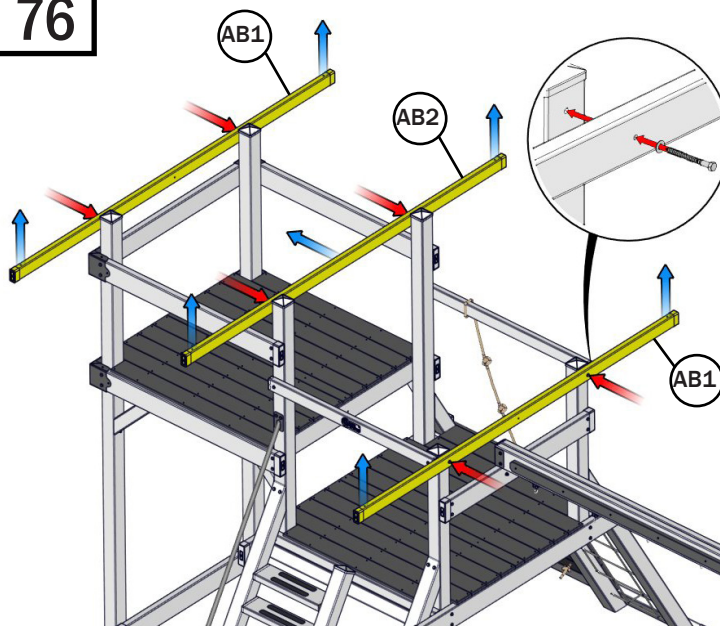

Note: DO NOT OVER-TIGHTEN. Fasten them enough so the parts touch. If the vinyl starts to dent or dimple, you know it is tight enough.

- One at a time, place both the roof railings at the top of the 4x4 posts with the end holes facing upwards. Both "AB1"s will be on the outside of the tower. "AB2" will be in the center with the center hole facing the extension tower.
- Fasten each item using (2) 9/16" x 4" Lags & 3/8" Washers.

ROOF ASSEMBLY (1)

STEP
77

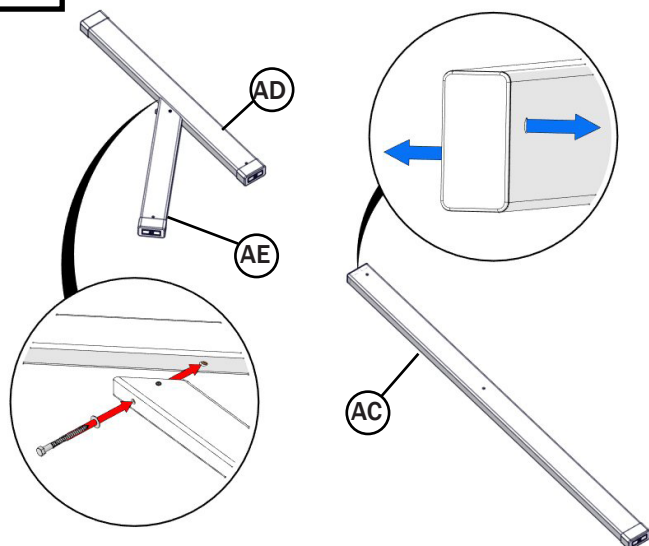

- “AC” will have an end cap on one end with 2 different holes on the sides. The upper hole will be on the extended tower side when the lower hole will be on the climber tower side.
- “AE” will get fastened to “AD” with (1) 9/16” x 4” Lags & 3/8” Washers. Make sure “AE” is on the same side as “AD” that has the through hole on the side of it. “AD” will have a hole on the top of it. That will be on the opposite end facing away from “AE”.

STEP
78

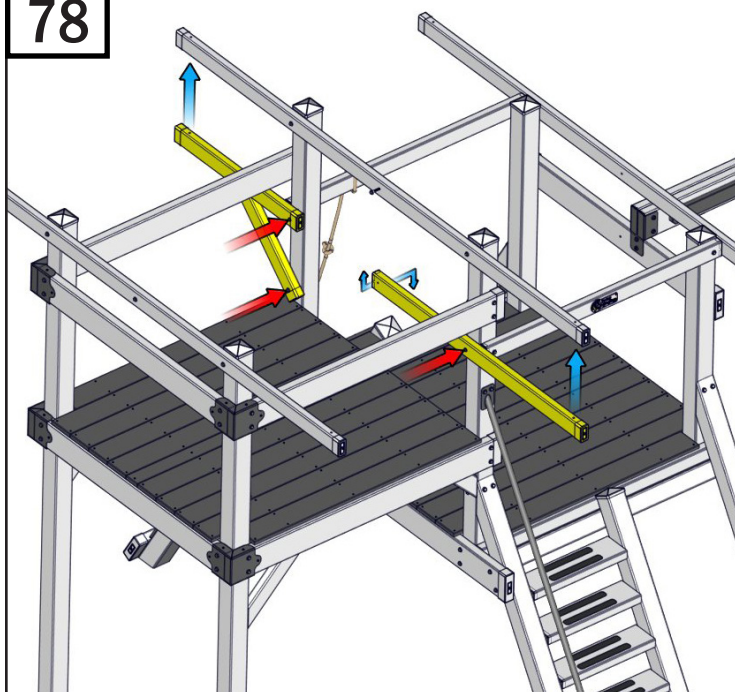

- As oriented in the previous step, you will place them on the extension tower the same way. Make sure the end holes are facing upwards and will be on the outside of the towers.
- Using (3) 9/16” x 4” Lags & 3/8” Washers, fasten the items to the tower.

STEP
79

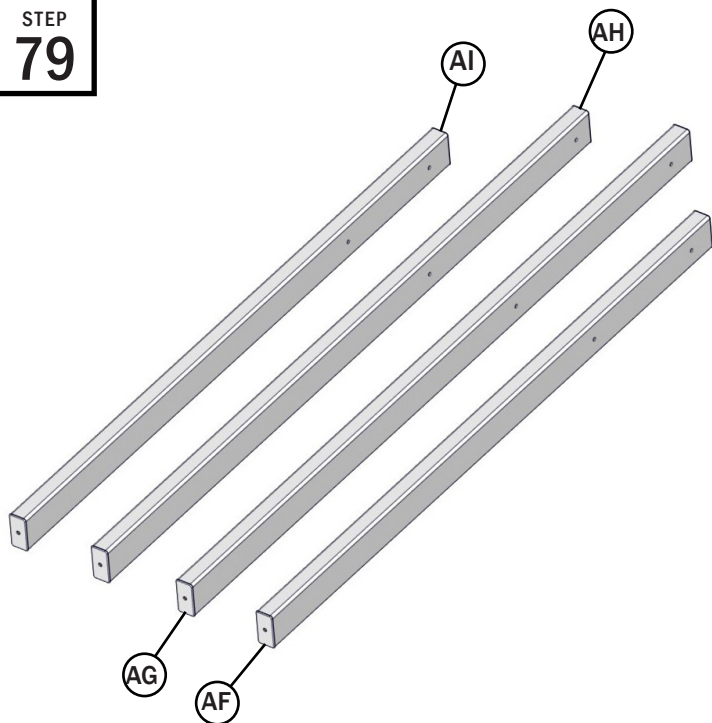

Locate and prepare the “Roof Vertical Bundle” which includes...

- AF: (1) 62” Roof 2x4 Vertical
- AG: (1) 70 3/4” Roof 2x4 Vertical
- AH: (1) 68 3/8” Roof 2x4 Vertical
- AI: (1) 59 5/8” Roof 2x4 Vertical

Note all lengths and holes. It is important to get all items in the right place.

STEP
80

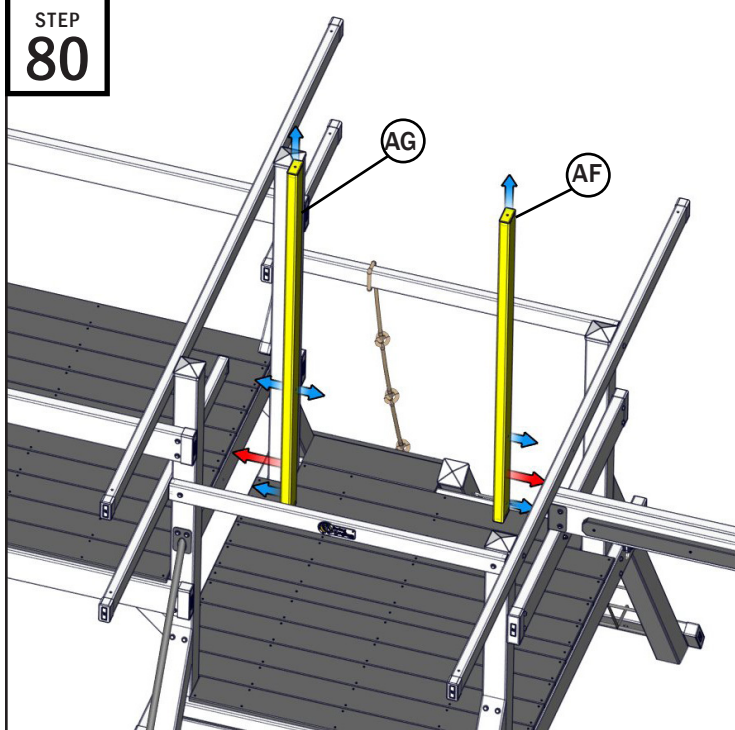

- Place “AF” & “AG” on the inside of the climber tower. The end holes on both will be facing upwards.
- “AF” has 2 holes towards the bottom on one side. Those holes will be facing outwards and “AF” will go on the right side of the climber tower.
- “AG” has 2 holes towards the bottom. The bottom most hole is on one side. That side will go against the railings.

POLY SLAT ASSEMBLY

STEP
81

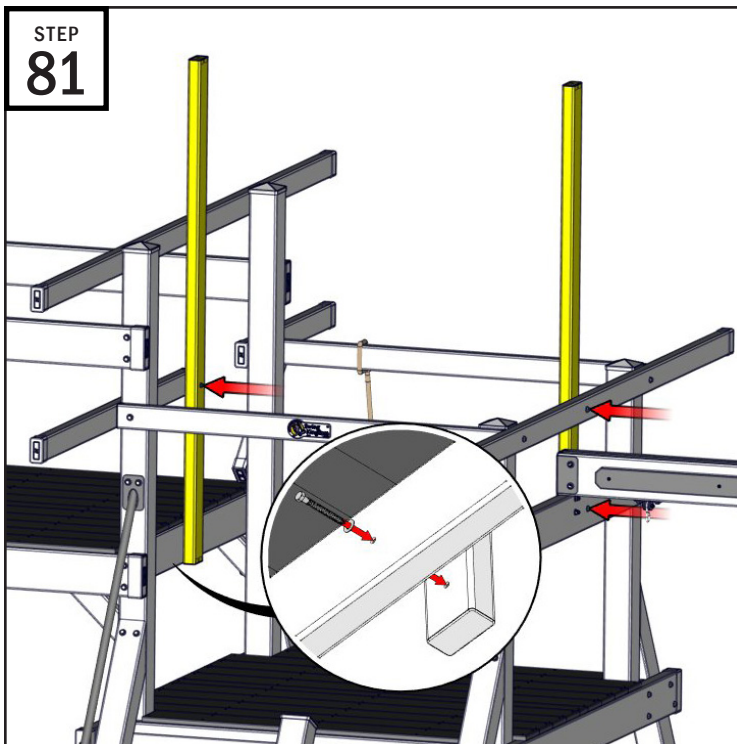

- Using (4) 9/16" x 3" Lags & 3/8" Washers, fasten "AF" & "AG" to the tower.
- All screws will go in through the right side of the tower except bottom left, which will go through the left side (under the extension tower)

STEP
82

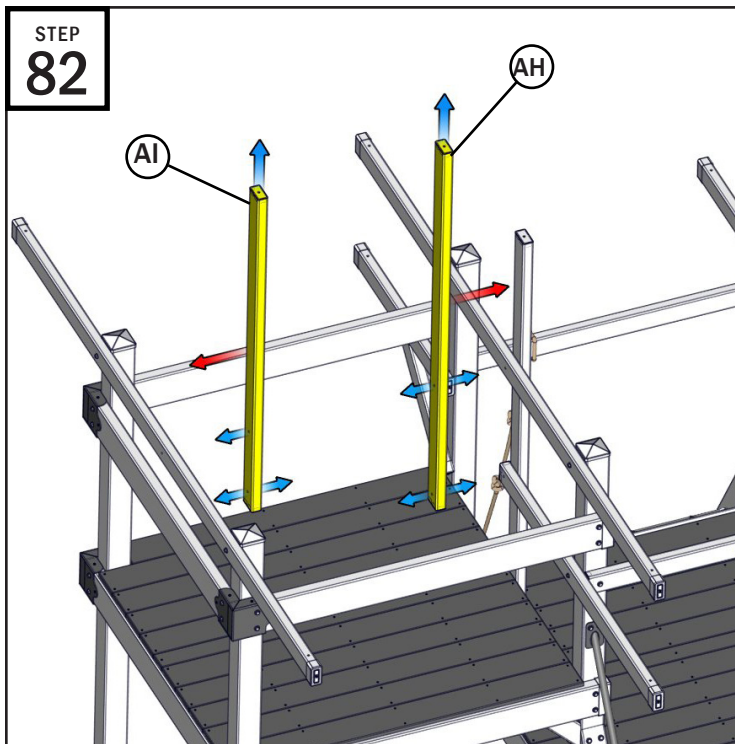

- Place "AH" & "AI" (2nd longest & the shortest 2x4) on the inside of the extended tower. The end holes on both will be facing upwards.
- "AH" will go on the right side towards the climber tower. The holes on this are through holes, so the orientation does not matter.
- "AI" has 2 holes towards the bottom. The upper hole is only on one side, which will go against the railings on the left side of the tower.

STEP
83

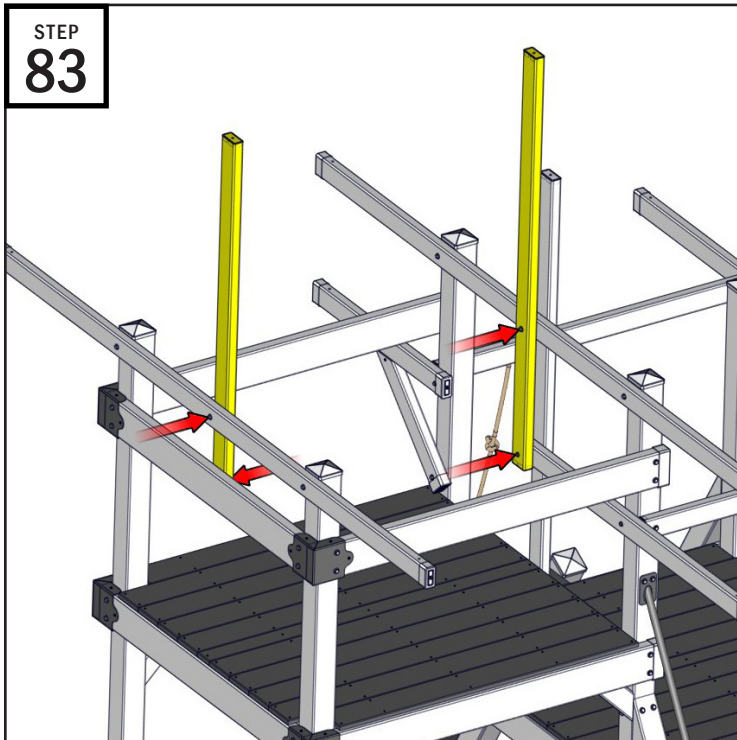

- Using (4) 9/16" x 3" Lags & 3/8" Washers, fasten "AH" & "AI" to the tower.
- All screws will go in through the left side of the tower except bottom left, which will go through the right side.

STEP
84

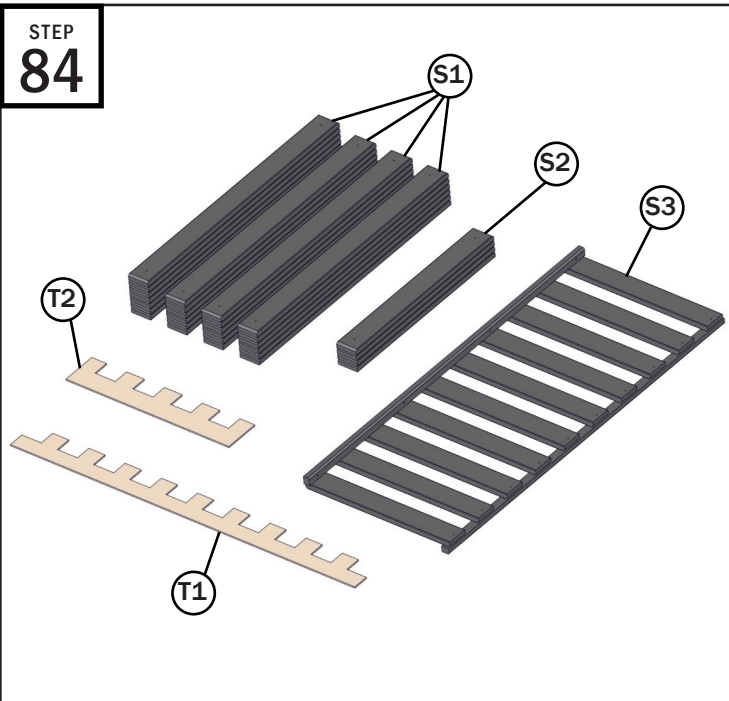

Locate the "Poly Slat Bundle" & the Slat Templates which will include...

- S1: (25) 3/4" x 2 5/8" x 33 3/8" Poly Slats
- S2: (4) 3/4" x 2 5/8" x 24" Poly Slat
- S3: (1) Poly Slat Assembly
- T1: (1) 5x5 Poly Slat Template
- T2: (1) Extension Poly Slat Template

Also locate the "Poly Slat Hardware" bag.

POLY SLAT ASSEMBLY

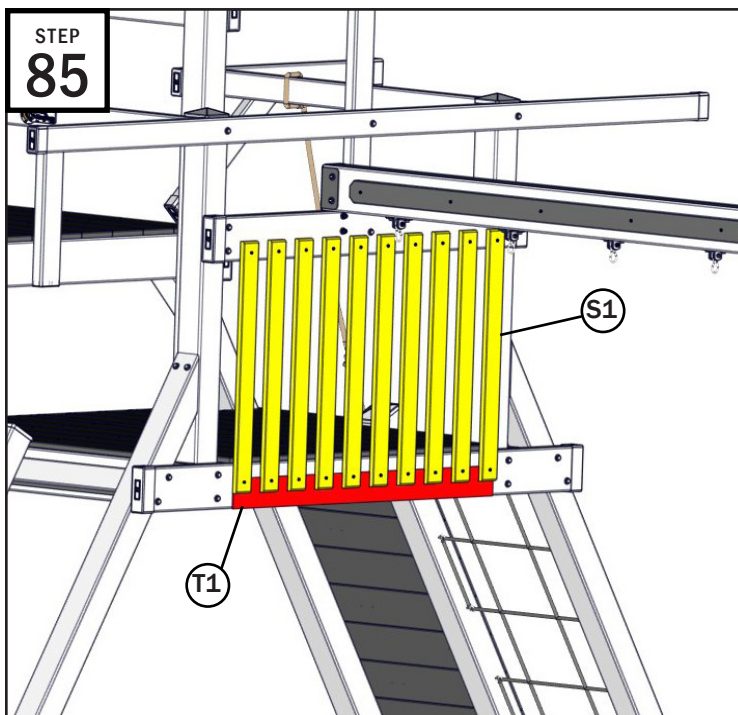

STEP
85

- Use the #2 Square Drive Bit, drill 2" Washer Head Screws into "T1" just enough so it is not or barely protruding through the other side.
- On the right side of the tower, place "T1", aligning the bottom flush with the bottom of the 2x6 and center on the tower. Have a 2nd person or use a clamp to hold "T1" securely.
- One at a time, place "S1" in the groove of "T1" and fasten the bottom screw into the 2x6.

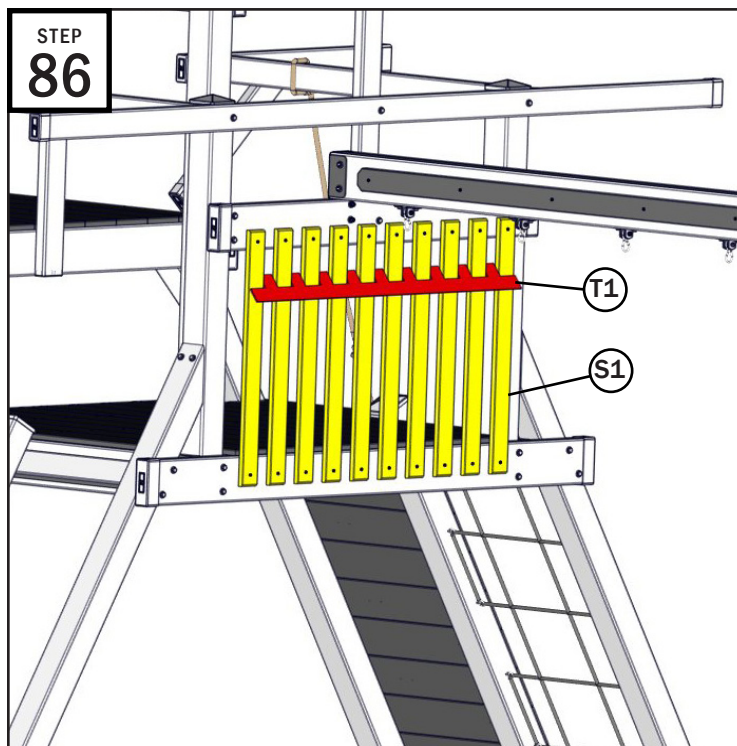

STEP
86

- Slide "T1" to the top of the slats holding them against the railing.
- Use a level on the first slat to get it aligned correctly. "T1" will help align the rest of the slats.
- Fasten the top slats with the same hardware in the previous step.

Note: This side of the tower will use 10 slats to cover the entire side.

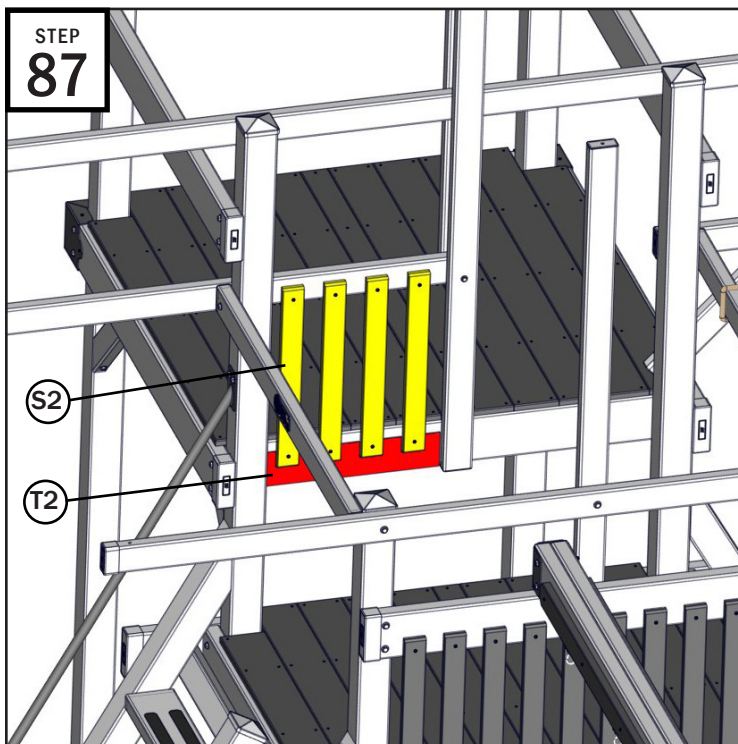

STEP
87

- Grab the smaller slats (S2) & template (T2).
- Repeat the same process between the two towers on the left side. "T2" will fit between the posts & the (4) "S2" will fit in the grooves of "T2".

Note: This area will use all 4 Small slats. You are done using "T2".

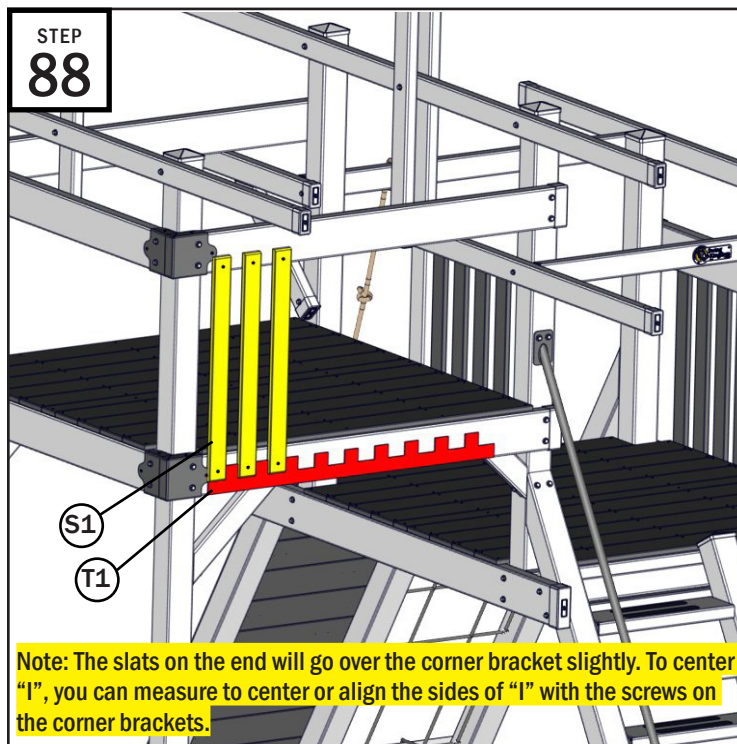

STEP
88

Note: The slats on the end will go over the corner bracket slightly. To center "I", you can measure to center or align the sides of "I" with the screws on the corner brackets.

- Grab 3 more "S1" slats & "T1".
- Repeat the same process on the front of the extended tower. The edge of "T1" will align around the smaller screw on the corner bracket.

Note: This area will use all 3 slats on this side of the front

ROOF ASSEMBLY (2)

STEP
89

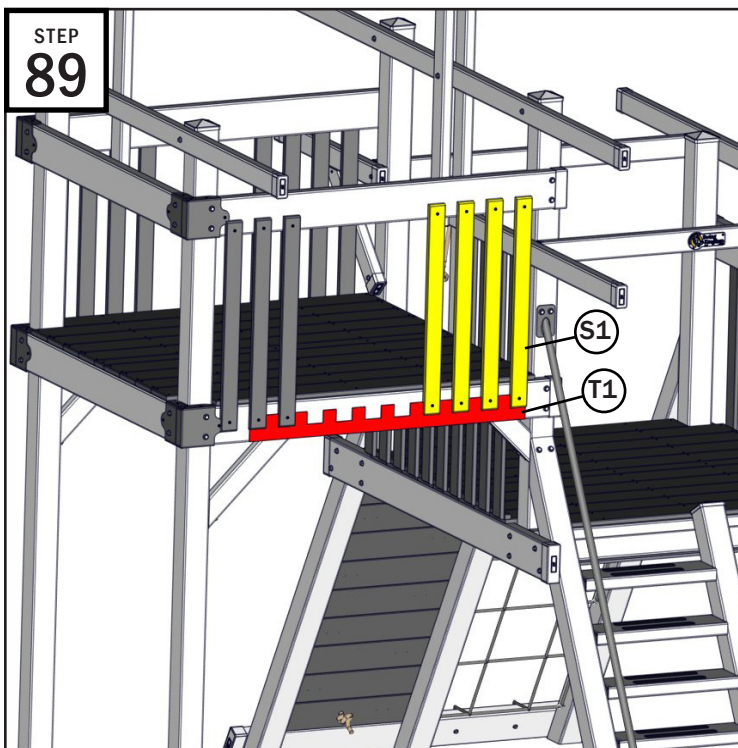

- On the same side, move "T1" down 1 "S1" so that "T1" is further to the right of the tower. This way you can reach far enough to mount the rest of "S1" for this side of the tower.

Note: The entire front side will have 7 poly slats (3 on the left & 4 on the right) & will leave an opening for the slide.

STEP
90

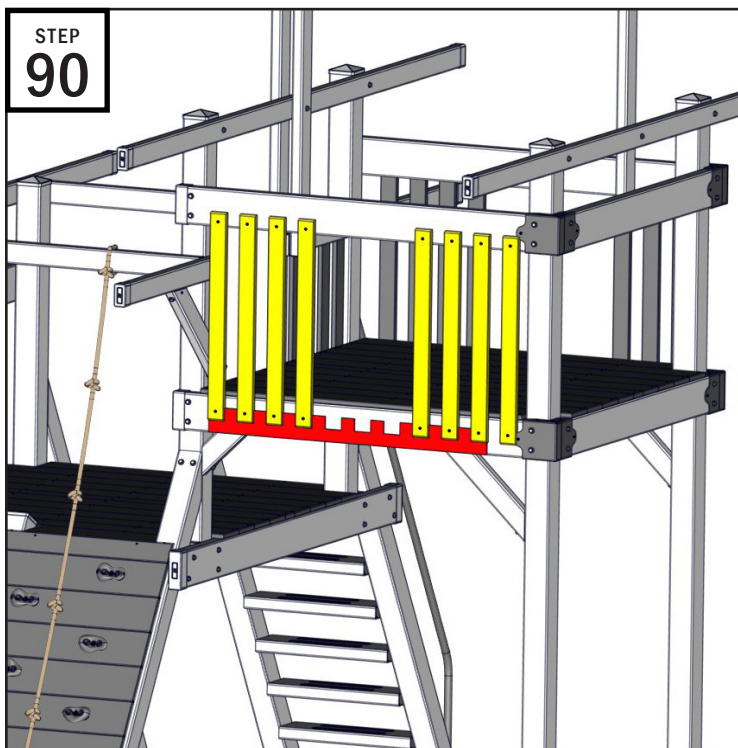

- Repeat the process on the back side of the extended tower.

Note: The entire back side will have 8 poly slats (4 on each side) & will leave an opening for the tic-tac-toe board.

STEP
91

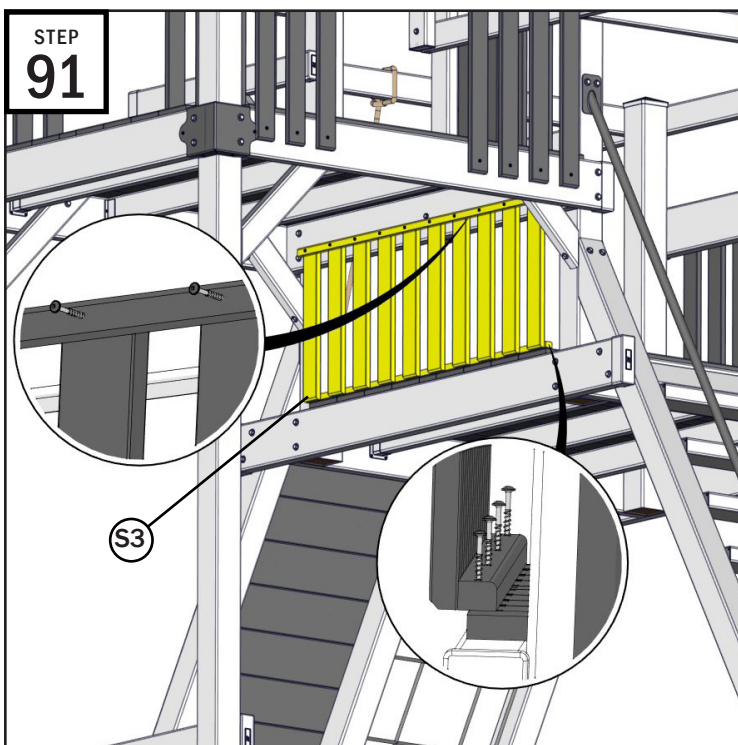

- "S3" will fit between the 2 towers, underneath the deck of the extended tower. The flat slim section with a flat base will sit right on the edge of the climber tower while the top section will sit against the 2x6 floor on the extended tower.
- Fasten these using 2" Washer Head Screws.

STEP
92

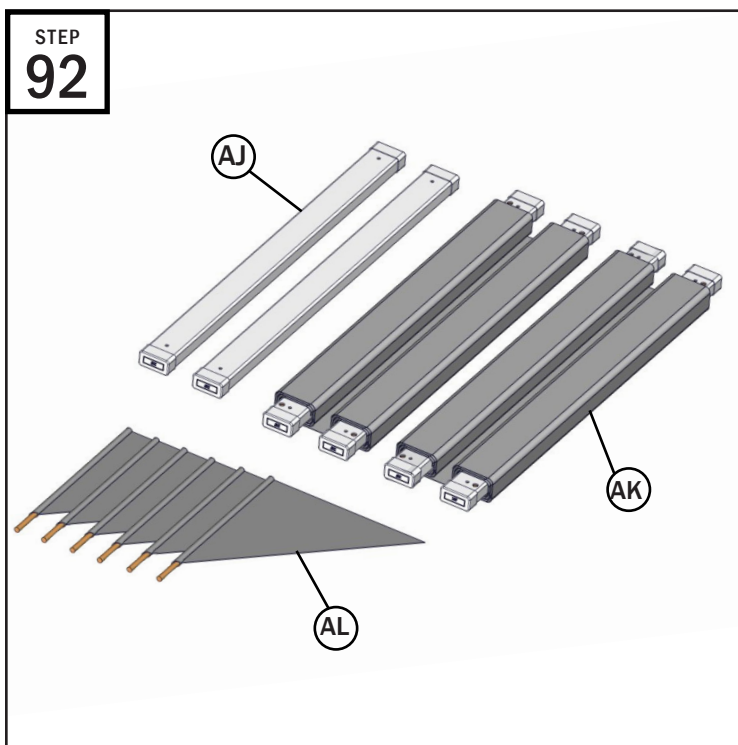

Locate the "Roof Canvas Bundle" which will include...

- AJ: (2) 59 1/2" Roof Horizontal 2x4
- AK: (2 total) (1) Canvas Roof with (2) 62 1/2" 2x4s
- AL: (1) Roof Flags

Also locate the "Roof Hardware" bag again.

ROOF ASSEMBLY (2)

STEP
93

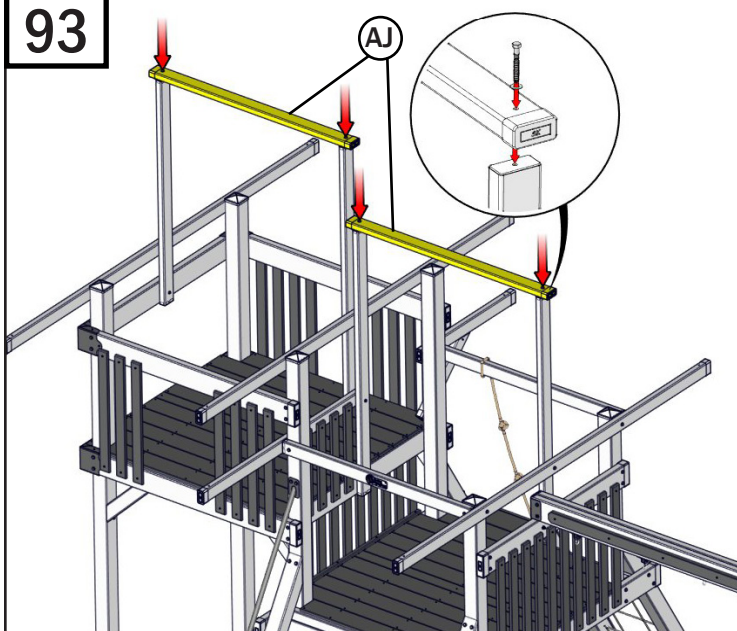

Note: DO NOT OVER-TIGHTEN. Fasten them enough so the parts touch. If the vinyl starts to dent or dimple, you know it is tight enough.

- Place "AJ" on top of the roof vertical pieces. 1 "AJ" will go over the climber tower & the other will go over the extension tower.
- The holes on "AJ" will line up with the top holes on the roof vertical pieces.
- Fasten "AJ" to the vertical pieces using (4) 9/16" x 4" Lags & 3/8" Washers.

STEP
94

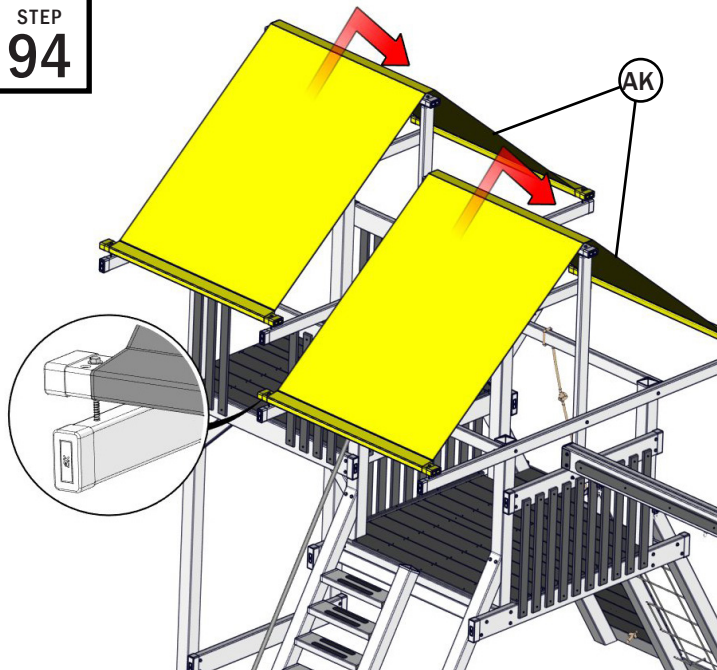

- Place one of the "AK" boards on one of the ends of the long railings. Make sure larger holes on "Z" are facing upwards.
- Using (2) 9/16" x 4" Lags & 3/8" Washers, drill into the smaller "AK" holes and drill into the railing end holes enough so that "AK" stays in place like the detail view above.
- Drape the "AK" Canvas over "AJ".
- Place the other "AK" board on the other end of the long railings.
- Repeat for the other canvas roof.

STEP
95

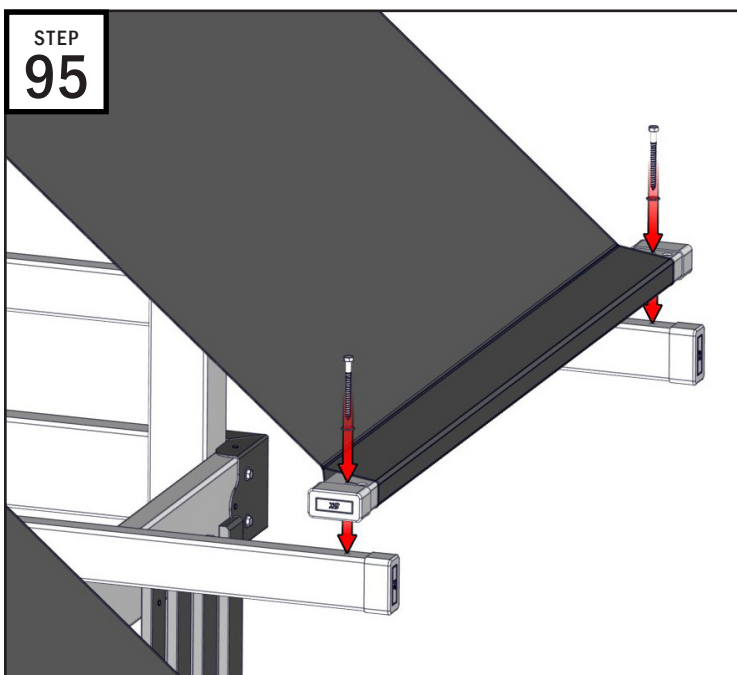

Note: DO NOT OVER-TIGHTEN. Fasten them enough so the parts touch. If the vinyl starts to dent or dimple, you know it is tight enough.

- Align the holes on the other side of the roof.
- Fasten using (2) 9/16" x 4" Lags & 3/8" Washers.
- Finish fastening the 2 Lags used to hold the original "Z" board from the previous step.

Note: This step will help tighten the canvas, so keep an eye on the canvas during this step.

STEP
96

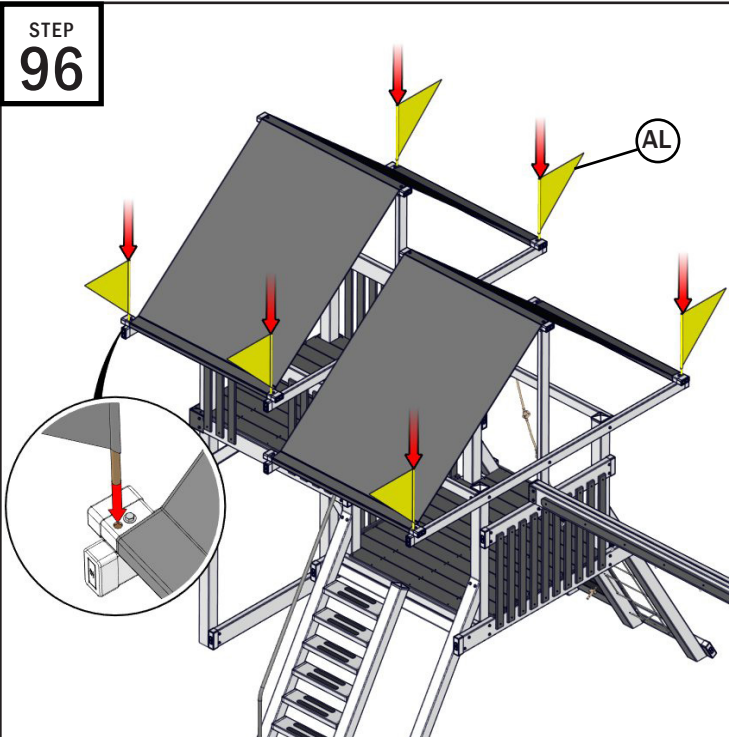

- The boards on the ends of the canvas will have larger holes.
- Place the (6) "AL" Flags in each of them. (The climber tower has 2 that won't be used since the roof railing above it will be in the way.)

ACCESSORY INSTALL

STEP
97

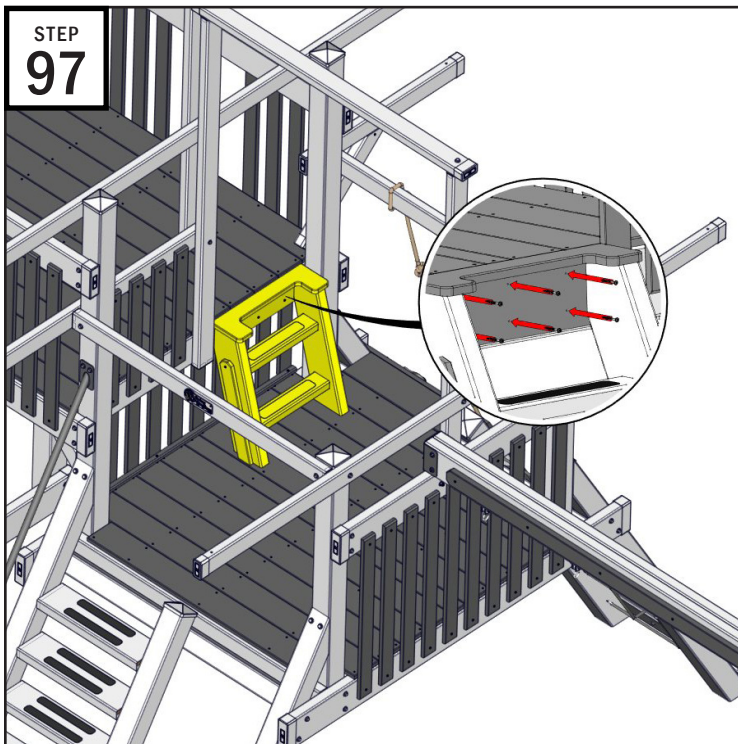

Locate the Ladder & the “Accessory Hardware” bag.

- Place in on the climber tower leading up to the extended tower in the opening.
- Using the 2 Square Drive Bit, drill (6) 2” Washer Head Screws through the back poly on the ladder into the tower 2x6.

STEP
98

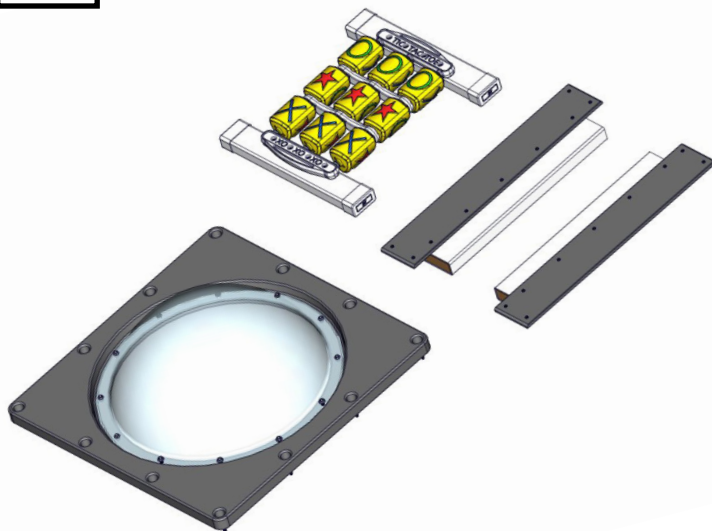

Locate the “Bubble Attachment Bundle” which includes...

- 26 1/4” 2x6 w/ poly attached

Locate the Bubble Panel & the Tic-Tac-Toe Panel.

STEP
99

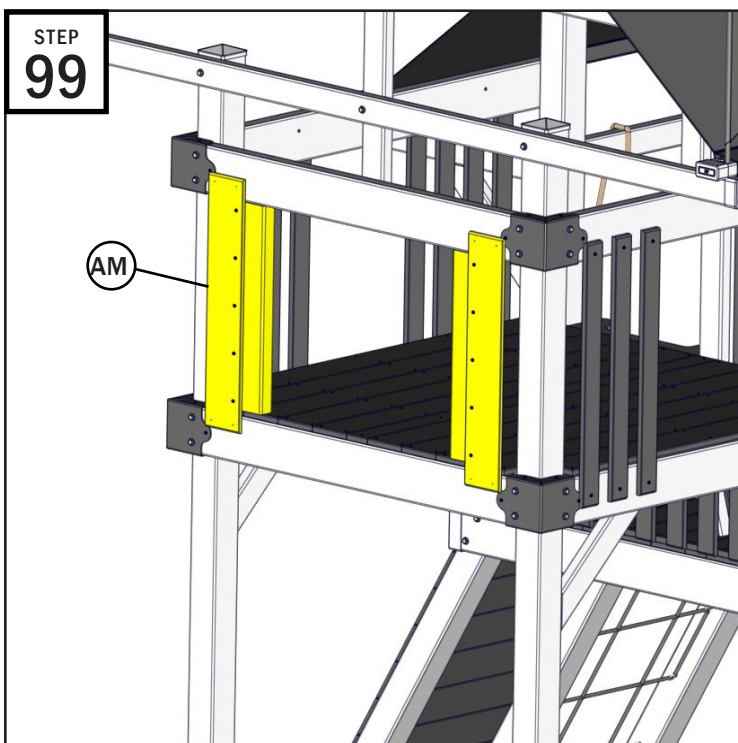

- On the far left side of the tower, place both “AM”s with the 2x6 between the decking & the railing. The Poly pieces will face away from each other.

STEP
100

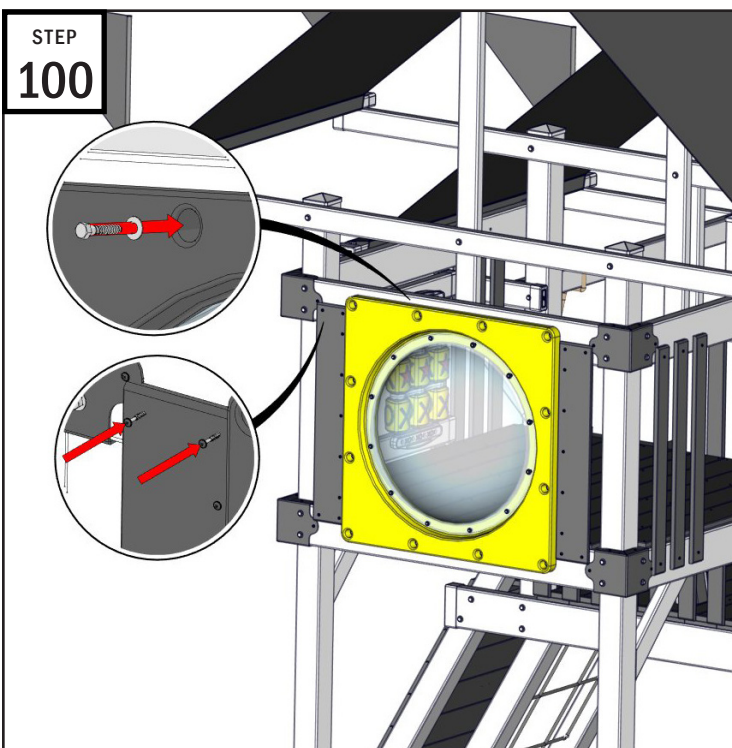

- Place the Dome on the Plate by lining up the holes and use the bolts provided with the bubble panel.
- Place the Bubble Panel between both “AM”s.
- Fasten the “AM”s using (8) 2” Washer Head Screws.
- Center the panel & Fasten to the tower using the lags provided.

ACCESSORY INSTALL

STEP 101

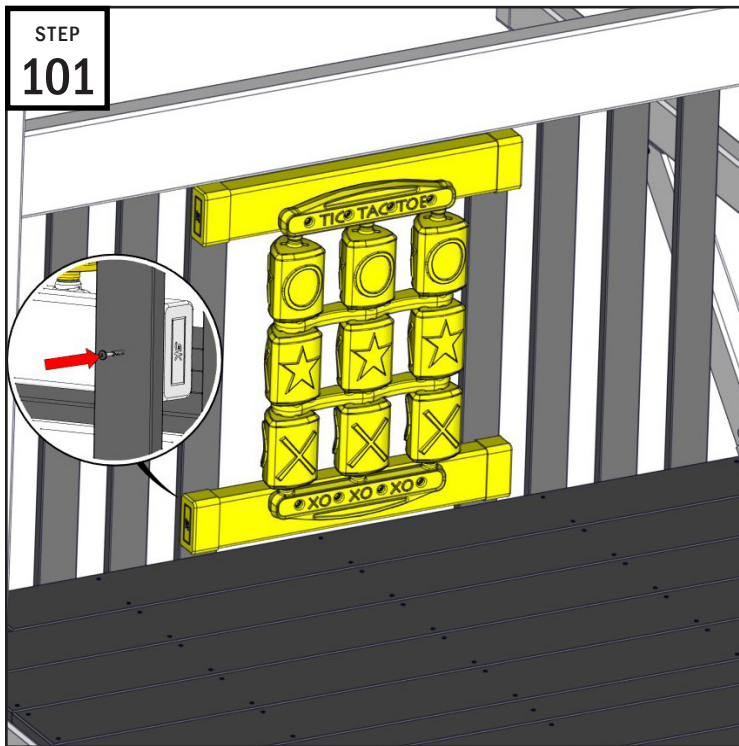

- Place the Tic-Tac-Toe Panel on the inside, back of the extended tower.
- Center the panel
- On the outside of the tower, fasten the panel to the poly slats using (4) 2" Washer Head Screws.

STEP 102

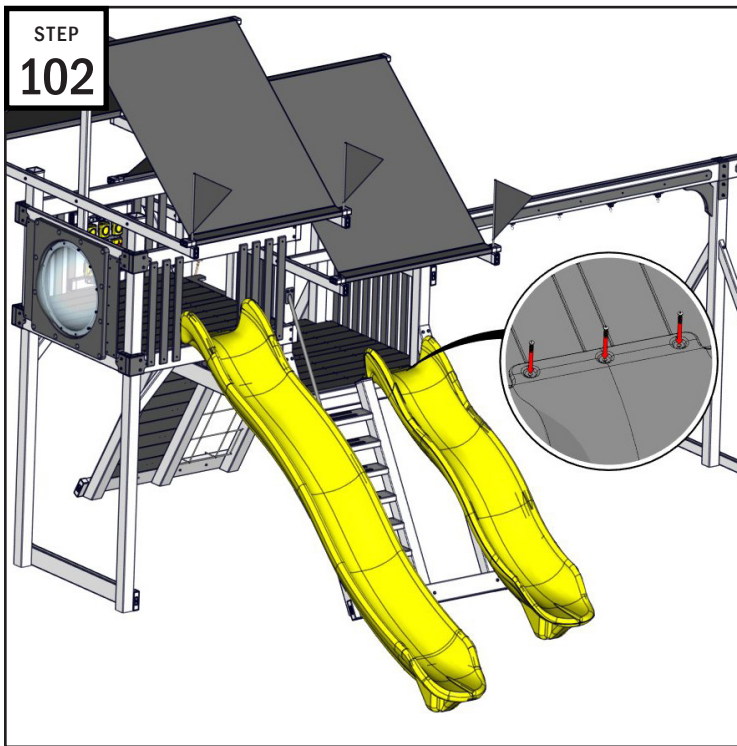

- Locate the 2 Avalanche slides. There will be a 10' & a 14'.
- Place the 10' on the climber tower next to the steps.
- Using (3) 1/4" x 1 1/4" Pan Head Screws & 5/16" Washers to fasten the slide to the tower decking.
- Place the 14' slide on the front of the extended tower & repeat the same fastening process.

STEP 103

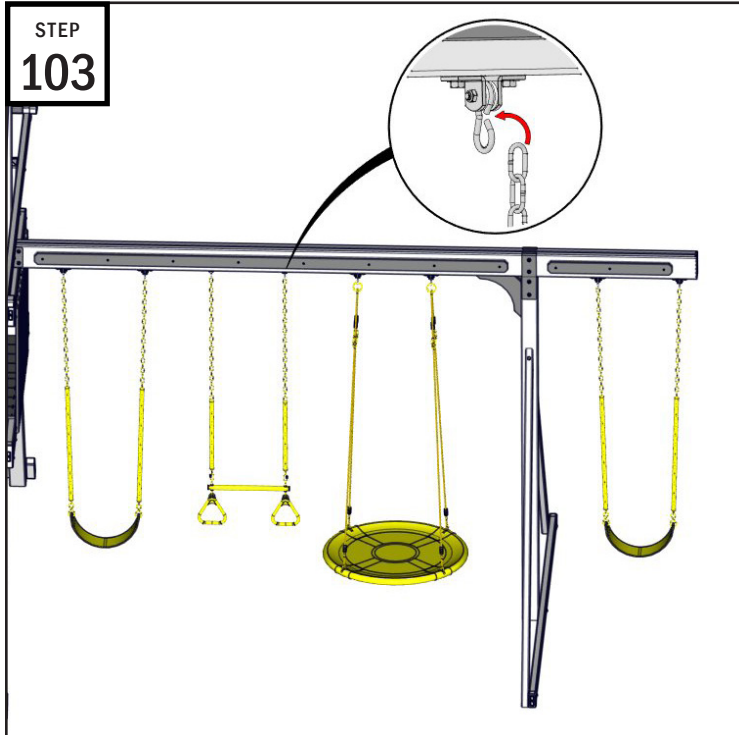

Locate the (2) Belt Swings, Trapeze, & the Web Swing.

- Hang all items from the Swing Hooks on the Swing Beam.
- There will be excess chain to adjust the height of the swing to the appropriate height.

STEP 104

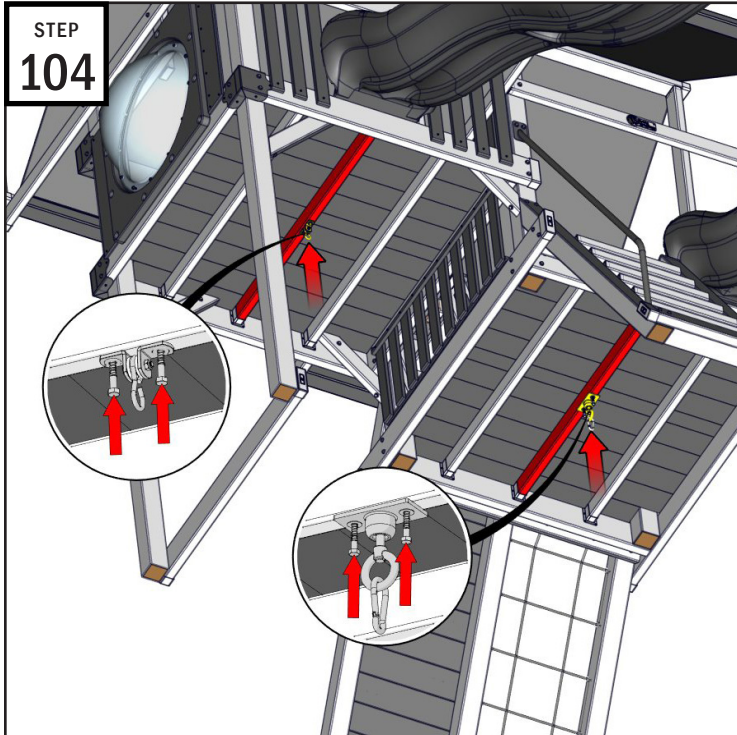

- In the Swing Hook Hardware, there should be (1) swing hook & (1) tire swivel attachment. The tire swivel will go under the climber tower & the swing hook will go under the extension tower.
- Like on the Swing Beam, mount these using (4) 9/16" x 3" Lags & 3/8" Washers. They will go on the center-most point on the center joists.

STAKE INSTALL

STEP
105

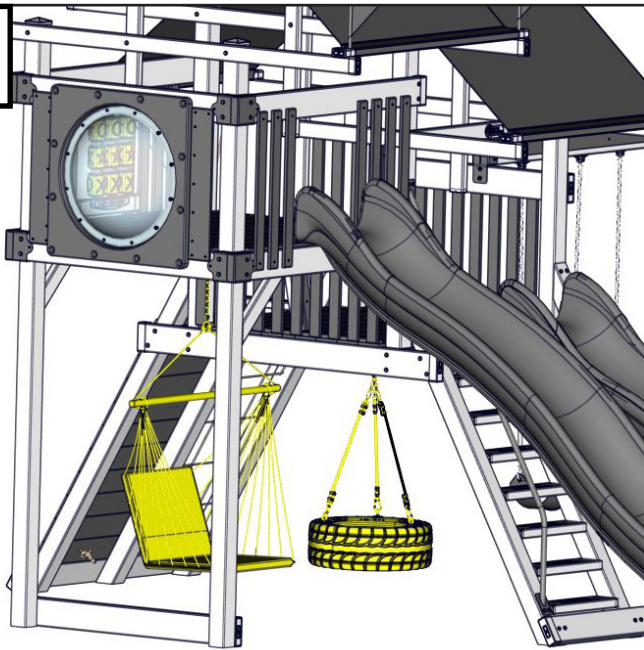

Locate the Hammock Swing & the Tire Swing.

- Hang the Hammock Swing onto the swing hook under the extension tower.
- Hang all 3 chains from the tire swing onto the swivel hook underneath the climber tower.

STEP
106

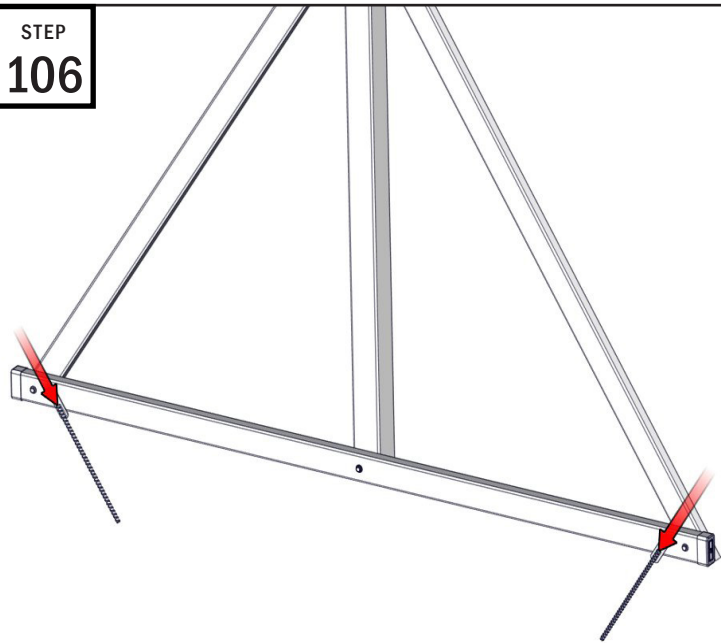

Locate the "Stake Bundle". This bundle will include:

- (2) Stakes
- (2) 1/2" x 1 1/2" Lags
- (2) 5/16" Washers

Using a hammer, drive a Stake into the ground at 45° (perpendicular to the swing braces) near the ends of the ground 2x4 of the Swing Frame.

STEP
107

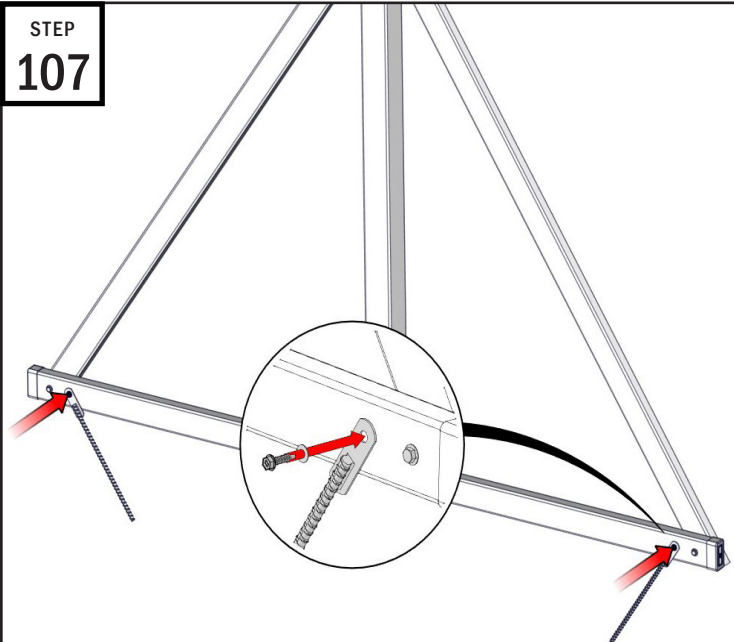

- Fasten the stakes to the Swing Beam using (2) 1/2" x 1 1/2" Lags and (2) 5/16" Washers.

The playset is now complete. Sometimes the vinyl will rub against itself in shipping. If you notice any marks, use Windex and a rag or steel wool to clean. Do not overuse steel wool as it can permanently scratch the playset.

COMPLETED PLAYSETS

Mega Climber 55 shown in Almond & Green



Mega Climber 55 shown in White & Gray





Swing Kingdom

MIGHTY PLAYSETS. SERIOUS FUN.

Technical Issues?

Contact us at:

Support@swingkingdom.com

717-656-4449